



## W5015



### TECHNICAL INFORMATION

|                                   |                   |
|-----------------------------------|-------------------|
| Flow (L/min)                      | 15                |
| Flow (US Gpm)                     | 3,96              |
| Rotation regime (rpm)             | 1450              |
| Pressure (MPa)                    | 50                |
| Pressure (bar)                    | 500               |
| Pressure (psi)                    | 7250              |
| Power (hp)                        | 20                |
| Power (kW)                        | 14,70             |
| Overall dimensions L x l x h (mm) | 351,5x242,5x195,5 |
| Weight (kg)                       | 19,5              |



Documents

Male shaft (key)

---



Double male shaft (key)

---

Male shaft (key) - vers. ATEX

---

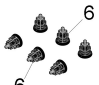
# Illustration Male shaft (key)

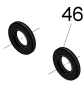
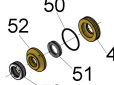
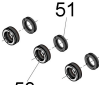
| KIT 150   | KIT 2   | KIT 3   | KIT 175   | KIT 174   |
|---|---|---|---|---|
|  |  |  |  |  |

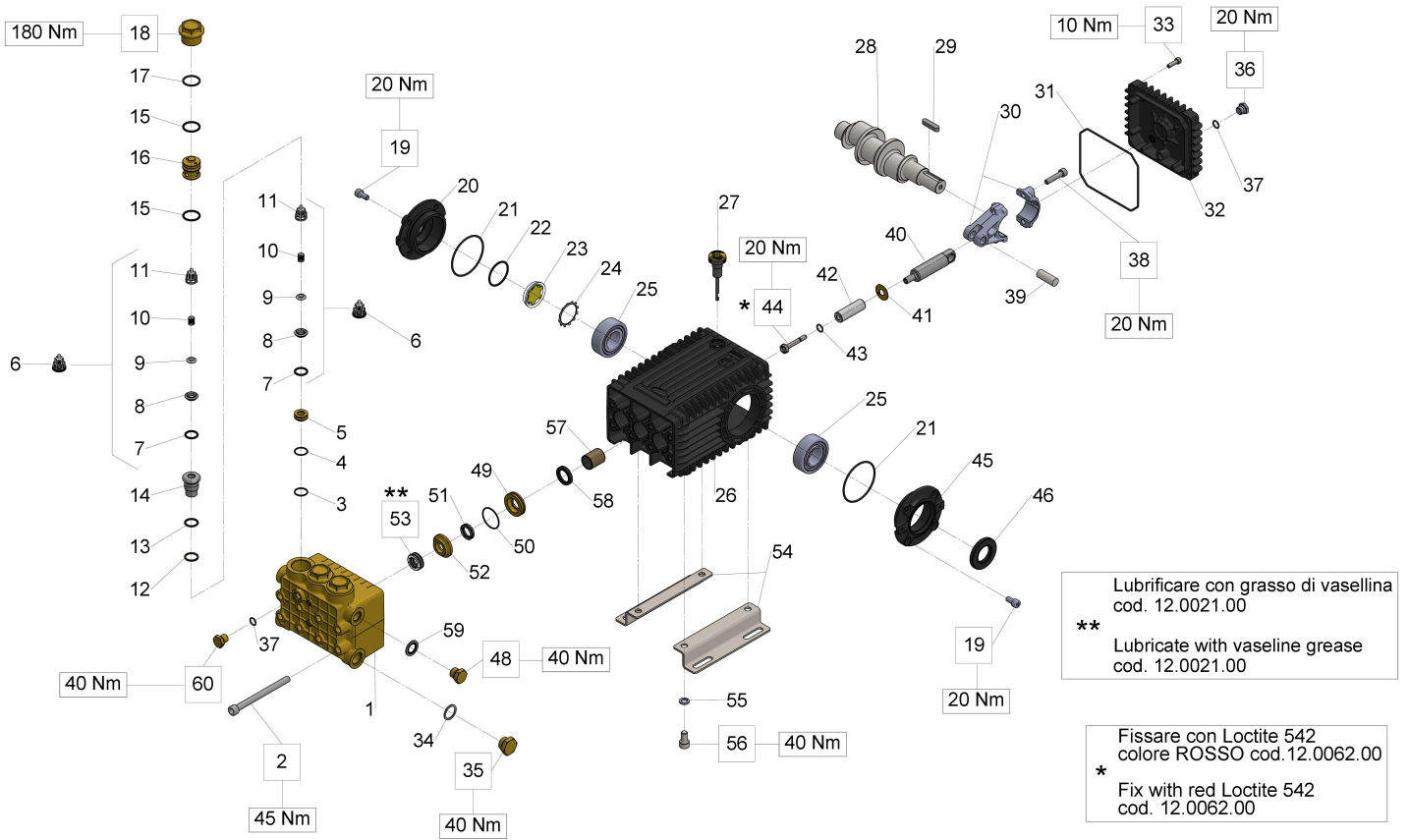

## Illustration Male shaft (key)

| Pos.   | Code     | Description                    | Qty | Notes |
|--------|----------|--------------------------------|-----|-------|
| KIT3   | 34000301 | KIT 3 OIL SEAL D.30X55X7       | 1   |       |
| KIT2   | 34000201 | KIT 2 OIL SEAL D. 22X32X5,5    | 1   |       |
| KIT175 | 34017501 |                                | 1   |       |
| KIT174 | 34017401 |                                | 1   |       |
| KIT150 | 34015001 | KIT 150 INTAKE/DEL.VALVE       | 1   |       |
| 60     | 98204300 | PLUG G1/4X10                   | 1   |       |
| 59     | 93185800 |                                | 1   |       |
| 58     | 90162500 | OIL SEAL 22x32x5               | 3   |       |
| 57     | 90912600 | BUSHING 22X25X30               | 3   |       |
| 56     | 99364400 | SCREW M 10x18-5931             | 4   |       |
| 55     | 96710600 | WASHER 10,2                    | 4   |       |
| 54     | 47200074 | PUMP FOOT                      | 2   |       |
| 53     | 90263400 |                                | 3   |       |
| 52     | 66216270 |                                | 3   |       |
| 51     | 90263100 |                                | 3   |       |
| 50     | 90361600 | O-RING 34,65X1,78 (2137)       | 3   |       |
| 49     | 66080270 |                                | 3   |       |
| 48     | 98210000 | PLUG G3/8X13                   | 1   |       |
| 46     | 90164800 | OIL SEAL 30x55x7               | 1   |       |
| 45     | 47151022 | OPEN SIDE COVER (47-66)        | 1   |       |
| 44     | 66219566 | PISTON BOLT                    | 3   |       |
| 43     | 90358400 | O-RING D.10,82X1,78(2043)90SH3 |     |       |
| 42     | 66040209 |                                | 3   |       |
| 41     | 96710100 | WASHER D. 10X28X0.5            | 3   |       |
| 40     | 66050066 | PISTON GUIDE - S.S.            | 3   |       |
| 39     | 97740500 | CONNECTING ROD-PIN D.14X39     | 3   |       |
| 38     | 99309900 | SCREW M 8x35 UNI 5931          | 6   |       |
| 37     | 90358500 | O-RING 10,82X1,78 (2043)       | 2   |       |
| 36     | 98204250 | PLUG G1/4"x12                  | 1   |       |
| 35     | 98217600 | PLUG G1/2X10                   | 1   |       |
| 34     | 96751400 | WASHER 21,5X27X1,5             | 1   |       |
| 33     | 99188400 | SCREW M 6x20 UNI 5931          | 4   |       |
| 32     | 66160022 | REAR COVER                     | 1   |       |
| 31     | 90392200 | O-RING D.133.02X 2,62(3525)    | 1   |       |
| 30     | 66030001 | CONNECTING ROD                 | 3   |       |
| 29     | 91489200 | KEY 8(h9)X7X35 UNI 6604/A      | 1   |       |
| 28     | 66020035 | CRANKSHAFT C.19 - D. 24        | 1   |       |
| 27     | 98210600 | OIL DIP-STICK G3/8X80          | 1   |       |

## Illustration Male shaft (key)

| Pos. | Code     | Description                        | Qty | Notes |
|------|----------|------------------------------------|-----|-------|
| 26   | 66010022 | CRANKCASE                          | 1   |       |
| 25   | 91838000 | ROLLER BEARING NJ2206EC            | 2   |       |
| 24   | 90075600 | CIRCLIP D.45 (ZJ45)                | 1   |       |
| 23   | 70211801 | OIL SIGHT GLASS                    | 1   |       |
| 22   | 90387700 | O-RING 39,34X2,62 (3156)           | 1   |       |
| 21   | 90391300 | O-RING 67,95X2,62 (3268)           | 2   |       |
| 20   | 47151222 | SIDE CRANKCASE COVER FOR OIL GAUGE | 1   |       |
| 19   | 99303900 | SCREW M 8x16 UNI 5931              | 8   |       |
| 18   | 66130141 |                                    | 3   |       |
| 17   | 90516500 | ANTI-EXTR.RING D.24.7x29x1.5       | 3   |       |
| 16   | 66210070 |                                    | 3   |       |
| 15   | 90385700 | O-RING 23,81X2,62 (132)            | 6   |       |
| 14   | 66210166 |                                    | 3   |       |
| 13   | 90384300 | O-RING 17,86X2,62 (123)            | 3   |       |
| 12   | 90511500 | ANTI-EXTRUSION RING                | 3   |       |
| 11   | 36202551 | VALVE CAGE                         | 6   |       |
| 10   | 94737600 | SPRING D. 9,4X14,8                 | 6   |       |
| 9    | 36203266 | SPHERICAL VALVE                    | 6   |       |
| 8    | 36200366 | VALVE SEAT                         | 6   |       |
| 7    | 90384100 | O-RING 17,12X2,62 (3068)           | 6   |       |
| 6    | 36712101 | INTAKE/DELIVERY VALVE              | 6   |       |
| 5    | 66210270 |                                    | 3   |       |
| 4    | 90359600 |                                    | 3   |       |
| 3    | 90511800 |                                    | 3   |       |
| 2    | 99382000 |                                    | 8   |       |
| 1    | 66124041 |                                    | 1   |       |



## Illustration Double male shaft (key)

| Pos.   | Code     | Description                    | Qty | Notes |
|--------|----------|--------------------------------|-----|-------|
| KIT3   | 34000301 | KIT 3 OIL SEAL D.30X55X7       | 1   |       |
| KIT2   | 34000201 | KIT 2 OIL SEAL D. 22X32X5,5    | 1   |       |
| KIT175 | 34017501 |                                | 1   |       |
| KIT174 | 34017401 |                                | 1   |       |
| KIT150 | 34015001 | KIT 150 INTAKE/DEL.VALVE       | 1   |       |
| 60     | 98204300 | PLUG G1/4X10                   | 1   |       |
| 59     | 93185800 |                                | 1   |       |
| 58     | 90162500 | OIL SEAL 22x32x5               | 3   |       |
| 57     | 90912600 | BUSHING 22X25X30               | 3   |       |
| 56     | 99364400 | SCREW M 10x18-5931             | 4   |       |
| 55     | 96710600 | WASHER 10,2                    | 4   |       |
| 54     | 47200074 | PUMP FOOT                      | 2   |       |
| 53     | 90263400 |                                | 3   |       |
| 52     | 66216270 |                                | 3   |       |
| 51     | 90263100 |                                | 3   |       |
| 50     | 90361600 | O-RING 34,65X1,78 (2137)       | 3   |       |
| 49     | 66080270 |                                | 3   |       |
| 48     | 98210000 | PLUG G3/8X13                   | 1   |       |
| 46     | 90164800 | OIL SEAL 30x55x7               | 2   |       |
| 45     | 47151022 | OPEN SIDE COVER (47-66)        | 2   |       |
| 44     | 66219566 | PISTON BOLT                    | 3   |       |
| 43     | 90358400 | O-RING D.10,82X1,78(2043)90SH3 |     |       |
| 42     | 66040209 |                                | 3   |       |
| 41     | 96710100 | WASHER D. 10X28X0.5            | 3   |       |
| 40     | 66050066 | PISTON GUIDE - S.S.            | 3   |       |
| 39     | 97740500 | CONNECTING ROD-PIN D.14X39     | 3   |       |
| 38     | 99309900 | SCREW M 8x35 UNI 5931          | 6   |       |
| 37     | 90358500 | O-RING 10,82X1,78 (2043)       | 2   |       |
| 36     | 98204250 | PLUG G1/4"x12                  | 1   |       |
| 35     | 98217600 | PLUG G1/2X10                   | 1   |       |
| 34     | 96751400 | WASHER 21,5X27X1,5             | 1   |       |
| 33     | 99188400 | SCREW M 6x20 UNI 5931          | 4   |       |
| 32     | 66160022 | REAR COVER                     | 1   |       |
| 31     | 90392200 | O-RING D.133.02X 2,62(3525)    | 1   |       |
| 30     | 66030001 | CONNECTING ROD                 | 3   |       |
| 29     | 91489200 | KEY 8(h9)X7X35 UNI 6604/A      | 2   |       |
| 28     | 66021035 | CRANKSHAFT C.19 - DUAL PTO     | 1   |       |

## Illustration Double male shaft (key)

| Pos. | Code     | Description                  | Qty | Notes |
|------|----------|------------------------------|-----|-------|
| 27   | 98210600 | OIL DIP-STICK G3/8X80        | 1   |       |
| 26   | 66010022 | CRANKCASE                    | 1   |       |
| 25   | 91838000 | ROLLER BEARING NJ2206EC      | 2   |       |
| 21   | 90391300 | O-RING 67,95X2,62 (3268)     | 2   |       |
| 19   | 99303900 | SCREW M 8x16 UNI 5931        | 8   |       |
| 18   | 66130141 |                              | 3   |       |
| 17   | 90516500 | ANTI-EXTR.RING D.24.7x29x1.5 | 3   |       |
| 16   | 66210070 |                              | 3   |       |
| 15   | 90385700 | O-RING 23,81X2,62 (132)      | 6   |       |
| 14   | 66210166 |                              | 3   |       |
| 13   | 90384300 | O-RING 17,86X2,62 (123)      | 3   |       |
| 12   | 90511500 | ANTI-EXTRUSION RING          | 3   |       |
| 11   | 36202551 | VALVE CAGE                   | 6   |       |
| 10   | 94737600 | SPRING D. 9,4X14,8           | 6   |       |
| 9    | 36203266 | SPHERICAL VALVE              | 6   |       |
| 8    | 36200366 | VALVE SEAT                   | 6   |       |
| 7    | 90384100 | O-RING 17,12X2,62 (3068)     | 6   |       |
| 6    | 36712101 | INTAKE/DELIVERY VALVE        | 6   |       |
| 5    | 66210270 |                              | 3   |       |
| 4    | 90359600 |                              | 3   |       |
| 3    | 90511800 |                              | 3   |       |
| 2    | 99382000 |                              | 8   |       |
| 1    | 66124041 |                              | 1   |       |



## Illustration Male shaft (key) - vers. ATEX

| Pos.   | Code     | Description                     | Qty | Notes |
|--------|----------|---------------------------------|-----|-------|
| KIT3   | 34000301 | KIT 3 OIL SEAL D.30X55X7        | 1   |       |
| KIT2   | 34000201 | KIT 2 OIL SEAL D. 22X32X5,5     | 1   |       |
| KIT175 | 34017501 |                                 | 1   |       |
| KIT174 | 34017401 |                                 | 1   |       |
| KIT150 | 34015001 | KIT 150 INTAKE/DEL.VALVE        | 1   |       |
| 63     | 99180900 | SCREW M06X10 5931 A2-70         | 1   |       |
| 62     | 96693950 | WASHER 6.4x11.0x0.7 D6798A INOX | 1   |       |
| 61     | 98203600 | PLUG G1/4x8 FOR PROBE D.6 S.S.  | 1   |       |
| 60     | 90075500 | STOP RING J45 UNI7437           | 1   |       |
| 60     | 98204300 | PLUG G1/4X10                    | 1   |       |
| 59     | 93185800 |                                 | 1   |       |
| 58     | 90162500 | OIL SEAL 22x32x5                | 3   |       |
| 57     | 90912600 | BUSHING 22X25X30                | 3   |       |
| 56     | 99364400 | SCREW M 10x18-5931              | 4   |       |
| 55     | 96710600 | WASHER 10,2                     | 4   |       |
| 54     | 47200074 | PUMP FOOT                       | 2   |       |
| 53     | 90263400 |                                 | 3   |       |
| 52     | 66216270 |                                 | 3   |       |
| 51     | 90263100 |                                 | 3   |       |
| 50     | 90361600 | O-RING 34,65X1,78 (2137)        | 3   |       |
| 49     | 66080270 |                                 | 3   |       |
| 48     | 98210000 | PLUG G3/8X13                    | 1   |       |
| 46     | 90164800 | OIL SEAL 30x55x7                | 1   |       |
| 45     | 47151022 | OPEN SIDE COVER (47-66)         | 1   |       |
| 44     | 66219566 | PISTON BOLT                     | 3   |       |
| 43     | 90358400 | O-RING D.10,82X1,78(2043)90SH3  |     |       |
| 42     | 66040209 |                                 | 3   |       |
| 41     | 96710100 | WASHER D. 10X28X0.5             | 3   |       |
| 40     | 66050066 | PISTON GUIDE - S.S.             | 3   |       |
| 39     | 97740500 | CONNECTING ROD-PIN D.14X39      | 3   |       |
| 38     | 99309900 | SCREW M 8x35 UNI 5931           | 6   |       |
| 37     | 90358500 | O-RING 10,82X1,78 (2043)        | 2   |       |
| 35     | 98217600 | PLUG G1/2X10                    | 1   |       |
| 34     | 96751400 | WASHER 21,5X27X1,5              | 1   |       |
| 33     | 99188400 | SCREW M 6x20 UNI 5931           | 4   |       |
| 32     | 66160022 | REAR COVER                      | 1   |       |
| 31     | 90392200 | O-RING D.133.02X 2,62(3525)     | 1   |       |

## Illustration Male shaft (key) - vers. ATEX

| Pos. | Code     | Description                            | Qty | Notes |
|------|----------|--|-----|-------|
| 30   | 66030001 | CONNECTING ROD                         | 3   |       |
| 29   | 91489200 | KEY 8(h9)X7X35 UNI 6604/A              | 1   |       |
| 28   | 66020035 | CRANKSHAFT C.19 - D. 24                | 1   |       |
| 27   | 98210700 | OIL DIPSTICK G3/8X64<br>D4+FILTER ATEX | 1   |       |
| 26   | 66010022 | CRANKCASE                              | 1   |       |
| 25   | 91838000 | ROLLER BEARING NJ2206EC                | 2   |       |
| 23   | 70211751 |  | 1   |       |
| 22   | 90387700 | O-RING 39,34X2,62 (3156)               | 1   |       |
| 21   | 90391300 | O-RING 67,95X2,62 (3268)               | 2   |       |
| 20   | 47151322 | SIDE CRANKCASE COVER (ATEX)            | 1   |       |
| 19   | 99303900 | SCREW M 8x16 UNI 5931                  | 8   |       |
| 18   | 66130141 |  | 3   |       |
| 17   | 90516500 | ANTI-EXTR.RING D.24.7x29x1.5           | 3   |       |
| 16   | 66210070 |  | 3   |       |
| 15   | 90385700 | O-RING 23,81X2,62 (132)                | 6   |       |
| 14   | 66210166 |  | 3   |       |
| 13   | 90384300 | O-RING 17,86X2,62 (123)                | 3   |       |
| 12   | 90511500 | ANTI-EXTRUSION RING                    | 3   |       |
| 11   | 36202551 | VALVE CAGE                             | 6   |       |
| 10   | 94737600 | SPRING D. 9,4X14,8                     | 6   |       |
| 9    | 36203266 | SPHERICAL VALVE                        | 6   |       |
| 8    | 36200366 | VALVE SEAT                             | 6   |       |
| 7    | 90384100 | O-RING 17,12X2,62 (3068)               | 6   |       |
| 6    | 36712101 | INTAKE/DELIVERY VALVE                  | 6   |       |
| 5    | 66210270 |  | 3   |       |
| 4    | 90359600 |  | 3   |       |
| 3    | 90511800 |  | 3   |       |
| 2    | 99382000 |  | 8   |       |
| 1    | 66124041 |  | 1   |       |