



W928



TECHNICAL INFORMATION

Flow (L/min)	15
Flow (US Gpm)	3,96
Rotation regime (rpm)	1750
Pressure (MPa)	27,5
Pressure (bar)	275
Pressure (psi)	4000
Power (hp)	11
Power (kW)	8,08
Overall dimensions L x l x h (mm)	327x236x180
Weight (kg)	14,5



Documents

Male shaft (key)

Male shaft (key) - vers. ATEX

Illustration Male shaft (key)

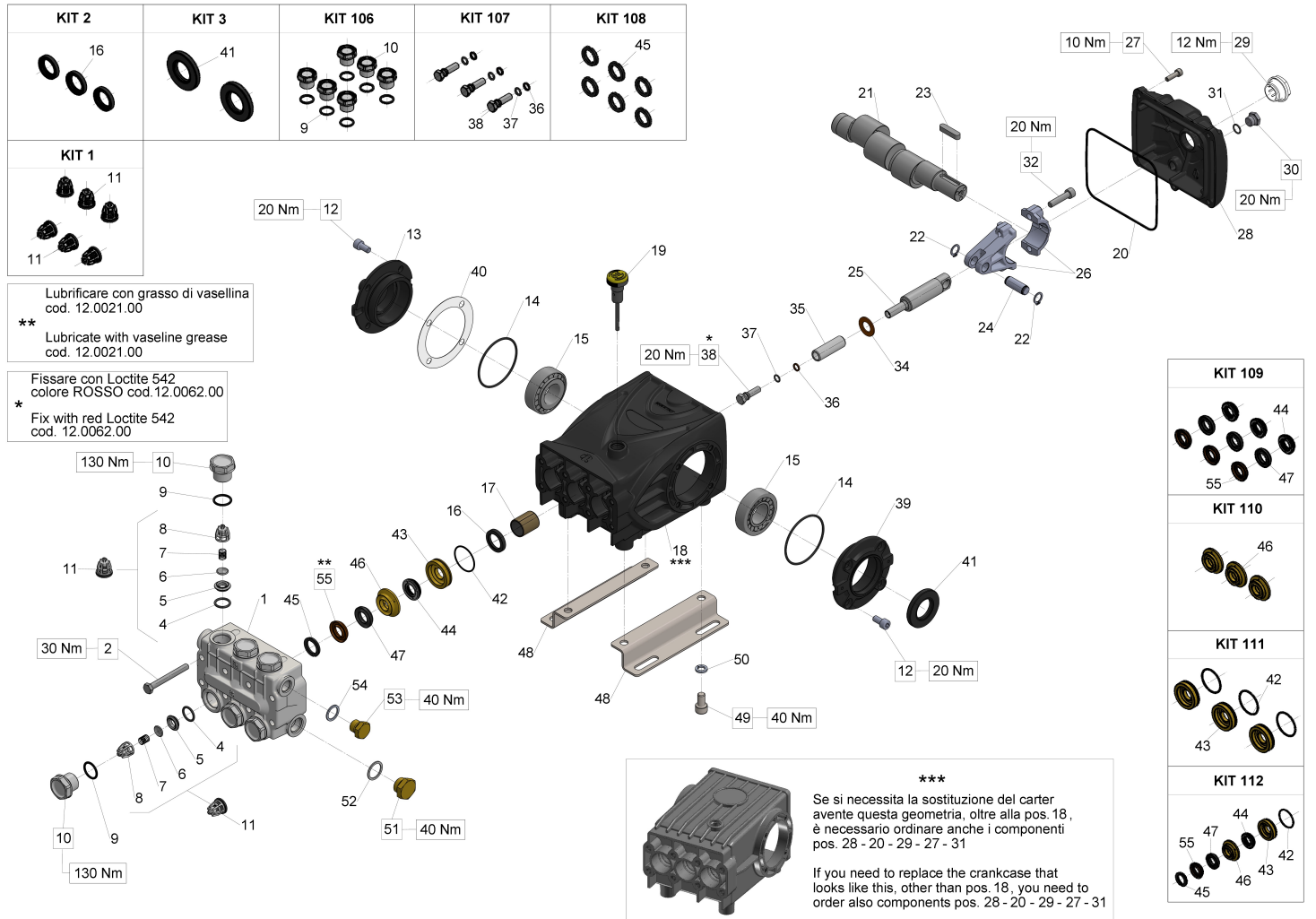

Illustration Male shaft (key)

Pos.	Code	Description	Qty	Notes
KIT3	34000301	KIT 3 OIL SEAL D.30X55X7	1	
KIT2	34000201	KIT 2 OIL SEAL D. 22X32X5,5	1	
KIT112	34011201	KIT 112 COMPL.SEAL PISTON D.16	1	
KIT111	34011101	KIT 111 PACKING RETAINER D. 16	1	
KIT110	34011001	KIT 110 INTERM. RING D. 16	1	
KIT109	34010901	KIT 109 PACKING D.16 + RESTOP	1	
KIT108	34010801	KIT 108 HEAD RING D. 16	1	
KIT107	34010701	KIT 107 PISTON BOLT	1	
KIT106	34010601	KIT 106 INTAKE/DEL. VALVE CAPS	1	
KIT1	34000101	KIT 1 INTAKE/DELIVERY VALVE	1	
55	90264200	PACKING D. 16X30	3	
54	96738000	WASHER 17,5X23X1,5	1	
53	98210000	PLUG G3/8X13	1	
52	96751400	WASHER 21,5X27X1,5	1	
51	98217600	PLUG G1/2X10	1	
50	96710600	WASHER 10,2	4	
49	99364400	SCREW M 10x18-5931	4	
48	47200074	PUMP FOOT	2	
47	90264300	RESTOP RING D. 16	3	
46	47217270	INTERMEDIATE RING D. 16	3	
45	47100351	HEAD RING D. 16	3	
44	90264400	LOW PRESSURE PACKING 16X30X8.5	3	
43	47080870	PACKING RETAINER D. 16	3	
42	90361600	O-RING 34,65X1,78 (2137)	3	
41	90164800	OIL SEAL 30x55x7	1	
40	97567800	SHIM D.74,5X104X0,1	1	
40	97568000	SHIM D.74.5X104X0.3	1	
39	47151022	OPEN SIDE COVER (47-66)	1	
38	47219666	PISTON BOLT D. 16	3	
37	90357700	O-RING 7,66X1,78 SPEC. (2031)	3	
36	90503300	ANTI-EXTRUSION RING	3	
35	47040856	PISTON D. 16X49	3	
34	47211747	PROTECTION RING	3	
32	99309900	SCREW M 8x35 UNI 5931	6	
31	90358500	O-RING 10,82X1,78 (2043)	1	
30	98204250	PLUG G1/4"x12	1	

Illustration Male shaft (key)

Pos.	Code	Description	Qty	Notes
29	47221301	OIL SIGHT GLASS ASSY G3/4	1	
28	47160622	CRANKCASE COVER	1	
27	99188400	SCREW M 6x20 UNI 5931	5	
26	47030001	CONNECTING ROD	3	
25	47050666	PISTON GUIDE - S.S.(928-9281)	3	
24	97738000	CONNECTING-ROD PIN D.13X35,5	3	
23	91489200	KEY 8(h9)X7X35 UNI 6604/A	1	
22	90055700	CIRCLIP D.12 UNI 7435	6	
21	47021735	CRANKSHAFT C.16 S.p.f. U.S.	1	
20	90392200	O-RING D.133.02X 2,62(3525)	1	
19	98210600	OIL DIP-STICK G3/8X80	1	
18	47010822	CRANKCASE	1	
17	90912600	BUSHING 22X25X30	3	
16	90162500	OIL SEAL 22x32x5	3	
15	91837500	TAPER BEARING	2	
14	90391300	O-RING 67,95X2,62 (3268)	2	
13	47151122	CLOSED SIDE COVER (47-66)	1	
12	99303900	SCREW M 8x16 UNI 5931	8	
11	36703201	VALVE ASSY.	6	
10	98222400	PLUG M 24X1,5X7,5	6	
9	90384700	O-RING 20,29X2,62(3081)	6	
8	36200251	VALVE CAGE	6	
7	94737600	SPRING D. 9,4X14,8	6	
6	36200176	VALVE PLATE	6	
5	36200366	VALVE SEAT	6	
4	90384100	O-RING 17,12X2,62 (3068)	6	
2	99320600	HEX-HEAD SCREW M08X70 UNI5737 10.9 Fe/Zn5c1A+De	8	
1	47121441	PUMP HEAD	1	

Illustration Male shaft (key) - vers. ATEX

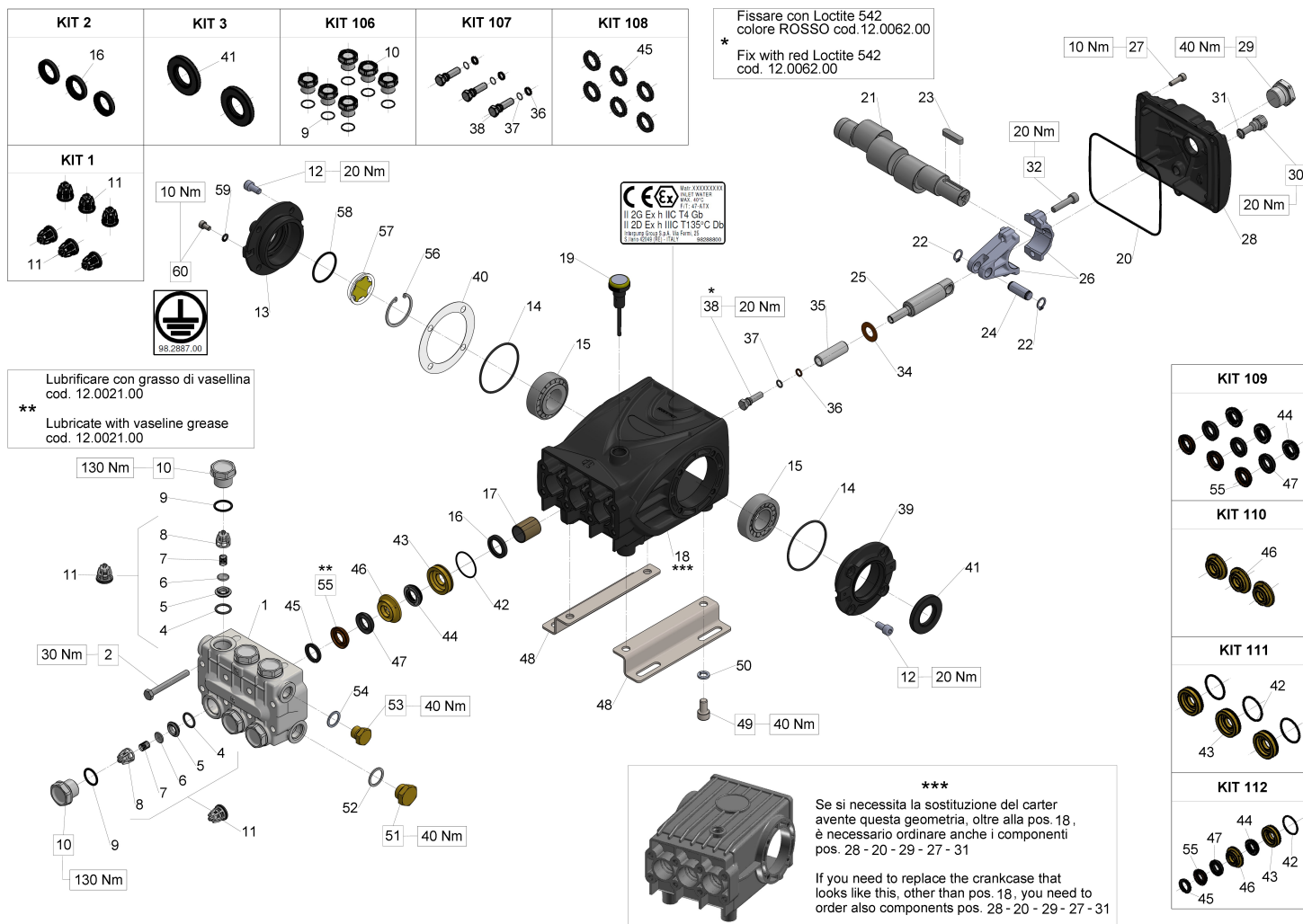

Illustration Male shaft (key) - vers. ATEX

Pos.	Code	Description	Qty	Notes
KIT3	34000301	KIT 3 OIL SEAL D.30X55X7	1	
KIT2	34000201	KIT 2 OIL SEAL D. 22X32X5,5	1	
KIT112	34011201	KIT 112 COMPL.SEAL PISTON D.16	1	
KIT111	34011101	KIT 111 PACKING RETAINER D. 16	1	
KIT110	34011001	KIT 110 INTERM. RING D. 16	1	
KIT109	34010901	KIT 109 PACKING D.16 + RESTOP	1	
KIT108	34010801	KIT 108 HEAD RING D. 16	1	
KIT107	34010701	KIT 107 PISTON BOLT	1	
KIT106	34010601	KIT 106 INTAKE/DEL. VALVE CAPS	1	
KIT1	34000101	KIT 1 INTAKE/DELIVERY VALVE	1	
60	99180900	SCREW M06X10 5931 A2-70	1	
59	96693950	WASHER 6.4x11.0x0.7 D6798A INOX	1	
58	90387700	O-RING 39,34X2,62 (3156)	1	
57	70211751		1	
56	90075500	STOP RING J45 UNI7437	1	
55	90264200	PACKING D. 16X30	3	
54	96738000	WASHER 17,5X23X1,5	1	
53	98210000	PLUG G3/8X13	1	
52	96751400	WASHER 21,5X27X1,5	1	
51	98217600	PLUG G1/2X10	1	
50	96710600	WASHER 10,2	4	
49	99364400	SCREW M 10x18-5931	4	
48	47200074	PUMP FOOT	2	
47	90264300	RESTOP RING D. 16	3	
46	47217270	INTERMEDIATE RING D. 16	3	
45	47100351	HEAD RING D. 16	3	
44	90264400	LOW PRESSURE PACKING 16X30X8.5	3	
43	47080870	PACKING RETAINER D. 16	3	
42	90361600	O-RING 34,65X1,78 (2137)	3	
41	90164800	OIL SEAL 30x55x7	1	
40	97567800	SHIM D.74,5X104X0,1	1	
40	97568000	SHIM D.74.5X104X0.3	1	
39	47151022	OPEN SIDE COVER (47-66)	1	
38	47219666	PISTON BOLT D. 16	3	
37	90357700	O-RING 7,66X1,78 SPEC. (2031)	3	

Illustration Male shaft (key) - vers. ATEX

Pos.	Code	Description	Qty	Notes
36	90503300	ANTI-EXTRUSION RING	3	
35	47040856	PISTON D. 16X49	3	
34	47211747	PROTECTION RING	3	
32	99309900	SCREW M 8x35 UNI 5931	6	
31	90358500	O-RING 10,82X1,78 (2043)	1	
30	98203600	PLUG G1/4x8 FOR PROBE D.6 S.S.	1	
29	98226600	PLUG G3/4X16 S.S.	1	
28	47160622	CRANKCASE COVER	1	
27	99188400	SCREW M 6x20 UNI 5931	5	
26	47030001	CONNECTING ROD	3	
25	47050666	PISTON GUIDE - S.S.(928-9281)	3	
24	97738000	CONNECTING-ROD PIN D.13X35,5	3	
23	91489200	KEY 8(h9)X7X35 UNI 6604/A	1	
22	90055700	CIRCLIP D.12 UNI 7435	6	
21	47021735	CRANKSHAFT C.16 S.p.f. U.S.	1	
20	90392200	O-RING D.133.02X 2,62(3525)	1	
19	98210700	OIL DIPSTICK G3/8X64 D4+FILTER ATEX	1	
18	47010822	CRANKCASE	1	
17	90912600	BUSHING 22X25X30	3	
16	90162500	OIL SEAL 22x32x5	3	
15	91837500	TAPER BEARING	2	
14	90391300	O-RING 67,95X2,62 (3268)	2	
13	47151322	SIDE CRANKCASE COVER (ATEX)	1	
12	99303900	SCREW M 8x16 UNI 5931	8	
11	36703201	VALVE ASSY.	6	
10	98222400	PLUG M 24X1,5X7,5	6	
9	90384700	O-RING 20,29X2,62(3081)	6	
8	36200251	VALVE CAGE	6	
7	94737600	SPRING D. 9,4X14,8	6	
6	36200176	VALVE PLATE	6	
5	36200366	VALVE SEAT	6	
4	90384100	O-RING 17,12X2,62 (3068)	6	
2	99320600	HEX-HEAD SCREW M08X70 UNI5737 10.9 Fe/Zn5c1A+De	8	
1	47121441	PUMP HEAD	1	