



VHT71150



TECHNICAL INFORMATION

Flow (L/min)	150
Flow (US Gpm)	39,6
Rotation regime (rpm)	800
Pressure (MPa)	11
Pressure (bar)	110
Pressure (psi)	1595
Power (hp)	42,8
Power (kW)	31,5
Overall dimensions L x l x h (mm)	526x369x253
Weight (kg)	68



Documents

Male shaft (key) - GAS

Male shaft (key) - NPT

Illustration Male shaft (key) - GAS

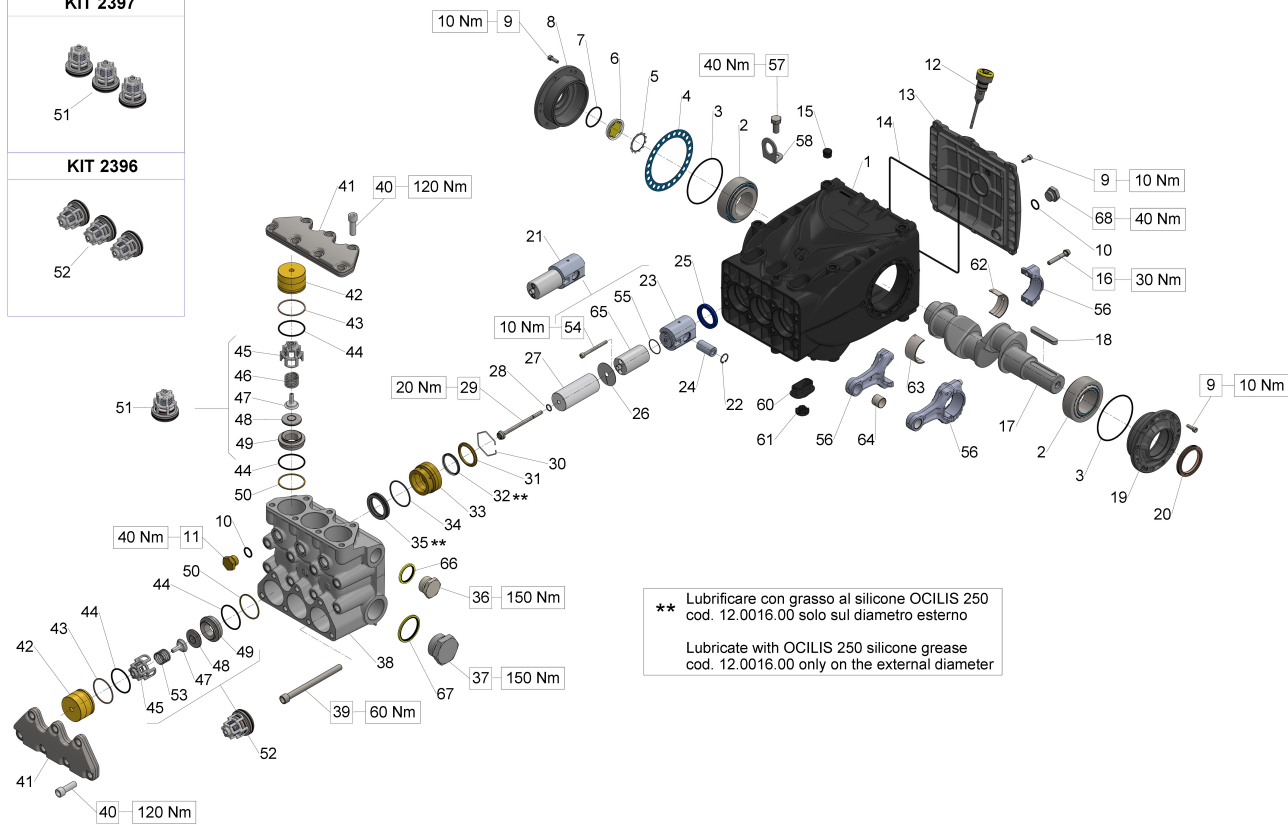

** Lubrificare con grasso al silicone OCILIS 250 cod. 12.0016.00 solo sul diametro esterno

Lubricate with OCILIS 250 silicone grease cod. 12.0016.00 only on the external diameter

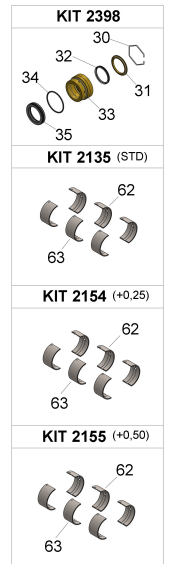

Illustration Male shaft (key) - GAS

Pos.	Code	Description	Qty	Notes
KIT2398	34239801		1	
KIT2397	34239701		1	
KIT2396	34239601		1	
KIT2155	34215501		1	
KIT2154	34215401		1	
KIT2135	34213501		1	
KIT2033	34203301		1	
68	98218700		1	
67	93199000		1	
66	93198500		1	
65	71050866		3	
64	90911000		3	
63	90924000		3	
63	90922200	UPPER HALF CONROD BUSHING +0.5 (BIG END) S.70	3	
63	90922100	UPPER HALF CONROD BUSHING +0.25 (BIG END) S.70	3	
62	90924300		3	
62	90922500	LOWER HALF CONROD BUSHING +0.50 (BIG END) S.70	3	
62	90922400	LOWER HALF CONROD BUSHING +0.25 (BIG END) S.70	3	
61	71225951	PLUG CAP	3	
60	71225851		6	
58	71223074	STAFFA DI SOLLEVAMENTO	1	
57	99426600	VITE TE M12X25-UNI5739 ZINC.	1	
56	71030701		3	
55	90352800	O-RING D. 29.00x1.50 NBR 70SH	3	
54	99199400		6	
53	94754000	SPRING D.24.7X27	3	
52	36726601		3	
51	36726701		3	
50	90524000		6	
49	36204156		6	
48	36208502	SPHERICAL VALVE COMPLETE	6	
47	36208651	INNER VALVE GUIDE	6	
46	94755000		3	
45	36204505	VALVE CAGE SS (71 SERIES)	6	

Illustration Male shaft (key) - GAS

Pos.	Code	Description	Qty	Notes
44	90388950		12	
43	90525000		6	
42	71211170		6	
41	71210136		2	
40	99429500	SCREW M12X35 UNI5931 12.31 DACR.	14	
39	99448000		8	
38	71124541		1	
37	98244000		1	
36	98232600		1	
35	90246000		3	
34	90389150		3	
33	71216670		3	
32	90245000		3	
31	71218970		3	
30	90079700		3	
29	71219566		3	
28	90367100		3	
27	71040509		3	
26	96714000		3	
25	90167800		3	
24	97743000		3	
23	71050715		3	
22	90060600		1	
21	71606601		3	
20	90170000		1	
19	71150022		1	
18	91500000		1	
17	71020035		1	
16	99313800		6	
15	98206000		4	
14	90400000		1	
13	71160022		1	
12	98212000		1	
11	98218300		3	
10	90384100	O-RING 17,12X2,62 (3068)	6	
9	99186700	SCREW M 6x18 UNI 5931	20	
8	71150122		1	
7	90387700	O-RING 39,34X2,62 (3156)	1	
6	70211801	OIL SIGHT GLASS	1	
5	90075600	CIRCLIP D.45 (ZJ45)	1	

Illustration Male shaft (key) - GAS

Pos.	Code	Description	Qty	Notes
4	70220381	SHIM 0.25 MM.	1	
4	70220081	SHIM 0.1 MM.	1	
3	90391800		2	
2	91859000		2	
1	71010022		1	

Illustration Male shaft (key) - NPT

Pos.	Code	Description	Qty	Notes
KIT2398	34239801		1	
KIT2397	34239701		1	
KIT2396	34239601		1	
KIT2155	34215501		1	
KIT2154	34215401		1	
KIT2135	34213501		1	
KIT2033	34203301		1	
68	98218700		1	
67	93199000		1	
66	93198500		1	
65	71050866		3	
64	90911000		3	
63	90924000		3	
63	90922200	UPPER HALF CONROD BUSHING +0.5 (BIG END) S.70	3	
63	90922100	UPPER HALF CONROD BUSHING +0.25 (BIG END) S.70	3	
62	90924300		3	
62	90922500	LOWER HALF CONROD BUSHING +0.50 (BIG END) S.70	3	
62	90922400	LOWER HALF CONROD BUSHING +0.25 (BIG END) S.70	3	
61	71225951	PLUG CAP	3	
60	71225851		6	
58	71223074	STAFFA DI SOLLEVAMENTO	1	
57	99426600	VITE TE M12X25-UNI5739 ZINC.	1	
56	71030701		3	
55	90352800	O-RING D. 29.00x1.50 NBR 70SH	3	
54	99199400		6	
53	94754000	SPRING D.24.7X27	3	
52	36726601		3	
51	36726701		3	
50	90524000		6	
49	36204156		6	
48	36208502	SPHERICAL VALVE COMPLETE	6	
47	36208651	INNER VALVE GUIDE	6	
46	94755000		3	
45	36204505	VALVE CAGE SS (71 SERIES)	6	

Illustration Male shaft (key) - NPT

Pos.	Code	Description	Qty	Notes
44	90388950		12	
43	90525000		6	
42	71211170		6	
41	71210136		2	
40	99429500	SCREW M12X35 UNI5931 12.31 DACR.	14	
39	99448000		8	
38	71124641		1	
37	98244000		1	
36	98232600		1	
35	90246000		3	
34	90389150		3	
33	71216670		3	
32	90245000		3	
31	71218970		3	
30	90079700		3	
29	71219566		3	
28	90367100		3	
27	71040509		3	
26	96714000		3	
25	90167800		3	
24	97743000		3	
23	71050715		3	
22	90060600		1	
21	71606601		3	
20	90170000		1	
19	71150022		1	
18	91500000		1	
17	71020035		1	
16	99313800		6	
15	98206000		4	
14	90400000		1	
13	71160022		1	
12	98212000		1	
11	98218300		3	
10	90384100	O-RING 17,12X2,62 (3068)	6	
9	99186700	SCREW M 6x18 UNI 5931	20	
8	71150122		1	
7	90387700	O-RING 39,34X2,62 (3156)	1	
6	70211801	OIL SIGHT GLASS	1	
5	90075600	CIRCLIP D.45 (ZJ45)	1	

Illustration Male shaft (key) - NPT

Pos.	Code	Description	Qty	Notes
4	70220381	SHIM 0.25 MM.	1	
4	70220081	SHIM 0.1 MM.	1	
3	90391800		2	
2	91859000		2	
1	71010022		1	