



T4018



TECHNICAL INFORMATION

| | |
|-----------------------------------|-------------------|
| Flow (L/min) | 18 |
| Flow (US Gpm) | 4,75 |
| Rotation regime (rpm) | 1750 |
| Pressure (MPa) | 40 |
| Pressure (bar) | 400 |
| Pressure (psi) | 5800 |
| Power (hp) | 20 |
| Power (kW) | 14,70 |
| Overall dimensions L x l x h (mm) | 351,5x242,5x195,5 |
| Weight (kg) | 19,5 |



Documents

Male shaft (key) - vers. ATEX

Illustration Male shaft (key) - vers. ATEX

| KIT 150 | KIT 2 | KIT 3 | KIT 175 | KIT 174 |
|---------|-------|-------|---------|---------|
| | | | | |

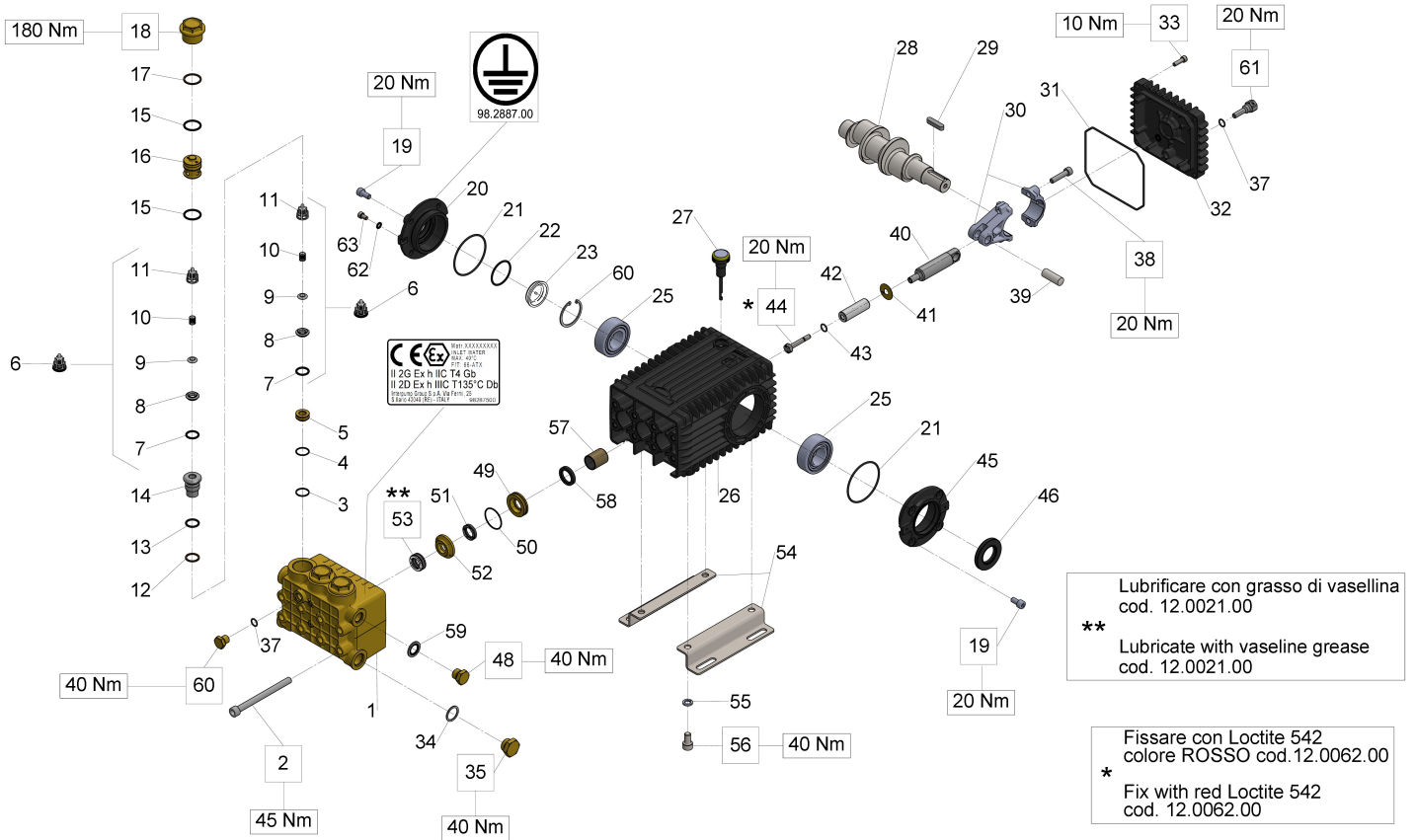

Illustration Male shaft (key) - vers. ATEX

| Pos. | Code | Description | Qty | Notes |
|--------|----------|---------------------------------|-----|-------|
| KIT3 | 34000301 | KIT 3 OIL SEAL D.30X55X7 | 1 | |
| KIT2 | 34000201 | KIT 2 OIL SEAL D. 22X32X5,5 | 1 | |
| KIT175 | 34017501 | | 1 | |
| KIT174 | 34017401 | | 1 | |
| KIT150 | 34015001 | KIT 150 INTAKE/DEL.VALVE | 1 | |
| 63 | 99180900 | SCREW M06X10 5931 A2-70 | 1 | |
| 62 | 96693950 | WASHER 6.4x11.0x0.7 D6798A INOX | 1 | |
| 61 | 98203600 | PLUG G1/4x8 FOR PROBE D.6 S.S. | 1 | |
| 60 | 90075500 | STOP RING J45 UNI7437 | 1 | |
| 60 | 98204300 | PLUG G1/4X10 | 1 | |
| 59 | 93185800 | | 1 | |
| 58 | 90162500 | OIL SEAL 22x32x5 | 3 | |
| 57 | 90912600 | BUSHING 22X25X30 | 3 | |
| 56 | 99364400 | SCREW M 10x18-5931 | 4 | |
| 55 | 96710600 | WASHER 10,2 | 4 | |
| 54 | 47200074 | PUMP FOOT | 2 | |
| 53 | 90263400 | | 3 | |
| 52 | 66216270 | | 3 | |
| 51 | 90263100 | | 3 | |
| 50 | 90361600 | O-RING 34,65X1,78 (2137) | 3 | |
| 49 | 66080270 | | 3 | |
| 48 | 98210000 | PLUG G3/8X13 | 1 | |
| 46 | 90164800 | OIL SEAL 30x55x7 | 1 | |
| 45 | 47151022 | OPEN SIDE COVER (47-66) | 1 | |
| 44 | 66219566 | PISTON BOLT | 3 | |
| 43 | 90358400 | O-RING D.10,82X1,78(2043)90SH3 | | |
| 42 | 66040209 | | 3 | |
| 41 | 96710100 | WASHER D. 10X28X0.5 | 3 | |
| 40 | 66050066 | PISTON GUIDE - S.S. | 3 | |
| 39 | 97740500 | CONNECTING ROD-PIN D.14X39 | 3 | |
| 38 | 99309900 | SCREW M 8x35 UNI 5931 | 6 | |
| 37 | 90358500 | O-RING 10,82X1,78 (2043) | 2 | |
| 35 | 98217600 | PLUG G1/2X10 | 1 | |
| 34 | 96751400 | WASHER 21,5X27X1,5 | 1 | |
| 33 | 99188400 | SCREW M 6x20 UNI 5931 | 4 | |
| 32 | 66160022 | REAR COVER | 1 | |
| 31 | 90392200 | O-RING D.133.02X 2,62(3525) | 1 | |

Illustration Male shaft (key) - vers. ATEX

| Pos. | Code | Description | Qty | Notes |
|------|----------|--|-----|-------|
| 30 | 66030001 | CONNECTING ROD | 3 | |
| 29 | 91489200 | KEY 8(h9)X7X35 UNI 6604/A | 1 | |
| 28 | 66020035 | CRANKSHAFT C.19 - D. 24 | 1 | |
| 27 | 98210700 | OIL DIPSTICK G3/8X64 D4+FILTER ATEX | 1 | |
| 26 | 66010022 | CRANKCASE | 1 | |
| 25 | 91838000 | ROLLER BEARING NJ2206EC | 2 | |
| 23 | 70211751 | | 1 | |
| 22 | 90387700 | O-RING 39,34X2,62 (3156) | 1 | |
| 21 | 90391300 | O-RING 67,95X2,62 (3268) | 2 | |
| 20 | 47151322 | SIDE CRANKCASE COVER (ATEX) | 1 | |
| 19 | 99303900 | SCREW M 8x16 UNI 5931 | 8 | |
| 18 | 66130141 | | 3 | |
| 17 | 90516500 | ANTI-EXTR.RING D.24.7x29x1.5 | 3 | |
| 16 | 66210070 | | 3 | |
| 15 | 90385700 | O-RING 23,81X2,62 (132) | 6 | |
| 14 | 66210166 | | 3 | |
| 13 | 90384300 | O-RING 17,86X2,62 (123) | 3 | |
| 12 | 90511500 | ANTI-EXTRUSION RING | 3 | |
| 11 | 36202551 | VALVE CAGE | 6 | |
| 10 | 94737600 | SPRING D. 9,4X14,8 | 6 | |
| 9 | 36203266 | SPHERICAL VALVE | 6 | |
| 8 | 36200366 | VALVE SEAT | 6 | |
| 7 | 90384100 | O-RING 17,12X2,62 (3068) | 6 | |
| 6 | 36712101 | INTAKE/DELIVERY VALVE | 6 | |
| 5 | 66210270 | | 3 | |
| 4 | 90359600 | | 3 | |
| 3 | 90511800 | | 3 | |
| 2 | 99382000 | | 8 | |
| 1 | 66121041 | | 1 | |