



## SS3B2018



### TECHNICAL INFORMATION

Flow (L/min)	18
Flow (US Gpm)	4,76
Rotation regime (rpm)	1450
Pressure (MPa)	20
Pressure (bar)	200
Pressure (psi)	2900
Power (hp)	9,4
Power (kW)	6,88
Overall dimensions L x l x h (mm)	273,5x223x152,5
Weight (kg)	9,5



Documents

Male shaft (key) - (plugs) - OUT OF PRODUCTION

---

# Illustration Male shaft (key) - (plugs) - OUT OF PRODUCTION

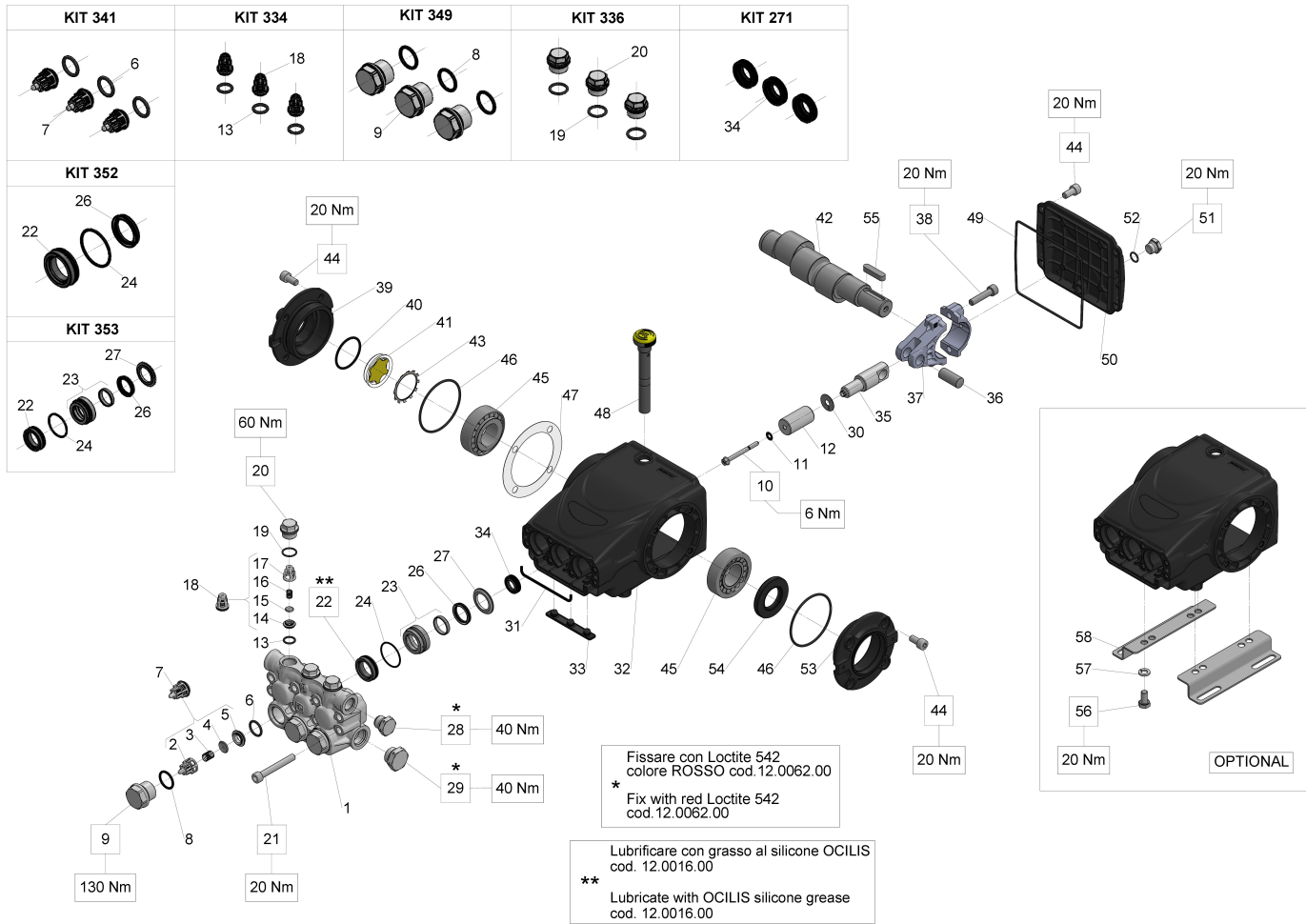

## Illustration Male shaft (key) - (plugs) - OUT OF PRODUCTION

Pos.	Code	Description	Qty	Notes
KIT353	34035301	KIT 353 CPL. SEAL D. 22 S. 59 SS1		
KIT352	34035201	KIT 352 PACKING D. 22 S. 59 SS 1		
KIT349	34034901	KIT 349*INLET VALVE CAPS S.59 1 SS		
KIT341	34034101	KIT 341 INLET VALVES S.53SS 1		
KIT336	34033601	KIT 336 OUTLET VALVE PLUG 1 S.53 SS		
KIT334	34033401	KIT 334 OUTLET VALVES S.53SS 1		
KIT271	34027101	KIT 271 OIL SEAL D.15 58/59 SERIES	1	
58	50200074	PUMP FOOT	2	
57	96701600	WASHER 8,4	4	
56	99303700	SCREW M 8x16-5739	4	
55	91489200	KEY 8(h9)X7X35 UNI 6604/A	1	
54	90164800	OIL SEAL 30x55x7	1	
53	47151022	OPEN SIDE COVER (47-66)	1	
52	90358500	O-RING 10,82X1,78 (2043)	1	
51	98204000	PLUG G1/4X9 S.S.	1	
50	59160022	REAR CRANKCASE COVER	1	
49	90392200	O-RING D.133.02X 2,62(3525)	1	
48	98211300	ASTA LIVELLO OLIO G3/8x54 D.41		
47	97567800	SHIM D.74,5X104X0,1	1	
47	97568000	SHIM D.74.5X104X0.3	1	
46	90391300	O-RING 67,95X2,62 (3268)	2	
45	91837500	TAPER BEARING	2	
44	99303800	SCREW M8X16 - STAINLESS	12	
43	90075600	CIRCLIP D.45 (ZJ45)	1	
42	59020235	CRANKSHAFT C.12	1	
41	70211801	OIL SIGHT GLASS	1	
40	90387700	O-RING 39,34X2,62 (3156)	1	
39	47151222	SIDE CRANKCASE COVER FOR OIL GAUGE	1	
38	99309900	SCREW M 8x35 UNI 5931	6	
37	59030001	CONNECTING ROD COMPLETE	3	
36	97739900	GUDGEON PIN D.14X34	3	
35	59050166	PISTON GUIDE - S.S.	3	
34	90156550	OIL SEAL D.15X24X5/7	3	
33	58210451	PROTECTION	1	

## Illustration Male shaft (key) - (plugs) - OUT OF PRODUCTION

Pos.	Code	Description	Qty	Notes
32	59010022	PUMP CRANKCASE	1	
31	59211082	SPONGE GASKET D.3X103	1	
30	96699000	WASHER D.7.5X23X0.5	3	
29	98218000	PLUG G 1/2 X 10 STAINLESS	1	
28	98210066	PLUG G 3/8 X 13 STAINLESS	1	
27	59211656	RING FOR PACKING D.22 * SS	3	
26	90230000	L.P. SEAL D.22 (HT)	3	
24	90361200	O-RING 31,47X1,78 (2125)	3	
23	59606501	PACKING RETAINER D. 22+SLEEVE S.S.	3	
22	90231200	H.P. SEAL D.22X32X10 (66HT)	3	
21	99317600	SCREW M08x60 5931 A2-70	8	
20	98213720	PLUG M18X1,5X10 D23 F12 SS	3	
19	90359300	O-RING 15,60X1,78 (2062)	3	
18	36724501	OUTLET VALVE S.53 SS	3	
17	36211151	VALVE CAGE	3	
16	94733300	SPRING D.6.2x10.5 S.S.	3	
15	36211276	SPHERICAL VALVE	3	
14	53211166	VALVE SEAT - S.S.	3	
13	90367400	O-RING D. 12X2 (120-20)	3	
12	59040109	PISTON D.22X42	3	
11	96690500	WASHER D.5X11.5x0.4 INOX+FKM58/59/63HT	3	
10	99169000	SCREW M05X55 SPEC. A2-70	3	
9	98222900	PLUG M24X1,5X17 S.S.	3	
8	90384700	O-RING 20,29X2,62(3081)	3	
7	36713001	VALVE ASSY (63 SS)	3	
6	90384100	O-RING 17,12X2,62 (3068)	3	
5	36203666	VALVE SEAT STAINLESS (63SS)	3	
4	36200176	VALVE PLATE	3	
3	94737300	SPRING D.9.4X14.8 - S.S.	3	
2	36202551	VALVE CAGE	3	
1	59122336	MANIFOLD FOR PISTON D. 22 S.S.	1	