

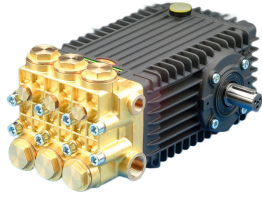

## W3025



### TECHNICAL INFORMATION

|                                   |                   |
|-----------------------------------|-------------------|
| Flow (L/min)                      | 25                |
| Flow (US Gpm)                     | 6,60              |
| Rotation regime (rpm)             | 1450              |
| Pressure (MPa)                    | 30                |
| Pressure (bar)                    | 300               |
| Pressure (psi)                    | 4350              |
| Power (hp)                        | 20                |
| Power (kW)                        | 14,70             |
| Overall dimensions L x l x h (mm) | 340,5x242,5x189,5 |
| Weight (kg)                       | 18,5              |



Documents

Male shaft (key)

---



Double male shaft (key)

---

Male shaft (key) - vers. ATEX

---

# Illustration Male shaft (key)

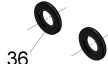
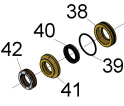
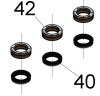
| KIT 169   | KIT 2   | KIT 3   | KIT 171   | KIT 170   |
|---|---|---|---|---|
|  |  |  |  |  |

Lubrificare con grasso di vasellina  
cod. 12.0021.00  
\*\*  
Lubricate with vaseline grease  
cod. 12.0021.00

Fissare con Loctite 542  
colore ROSSO cod. 12.0062.00  
\*  
Fix with red Loctite 542  
cod. 12.0062.00

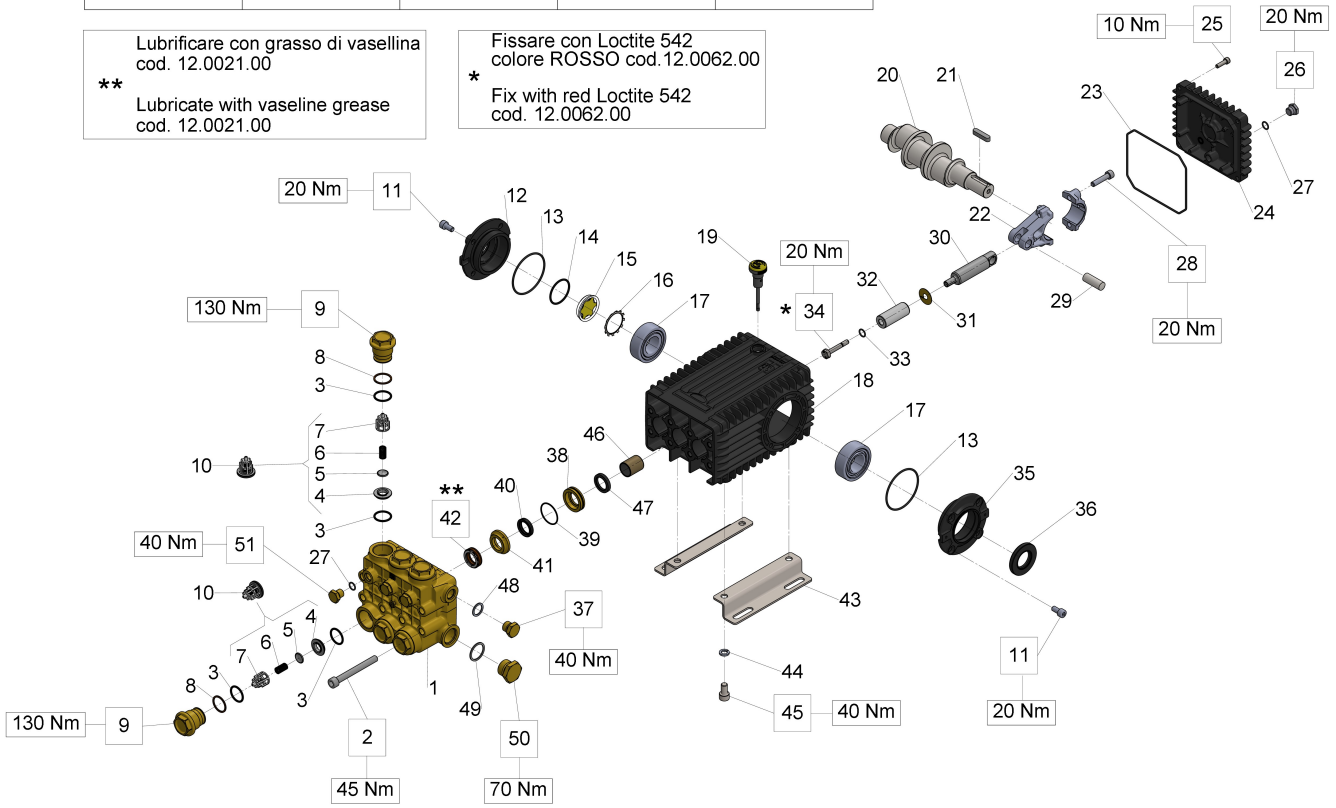

## Illustration Male shaft (key)

| Pos.   | Code     | Description                    | Qty | Notes |
|--------|----------|--------------------------------|-----|-------|
| KIT3   | 34000301 | KIT 3 OIL SEAL D.30X55X7       | 1   |       |
| KIT2   | 34000201 | KIT 2 OIL SEAL D. 22X32X5,5    | 1   |       |
| KIT171 | 34017101 | KIT 171 COMPL.SEAL D.20 (66)   | 1   |       |
| KIT170 | 34017001 | KIT 170 PACKING D.20 (66)      | 1   |       |
| KIT169 | 34016901 | KIT 169 INTAKE/DEL.VALVE (66)  | 1   |       |
| 51     | 98204300 | PLUG G1/4X10                   | 3   |       |
| 50     | 98226800 | PLUG G3/4X16                   | 1   |       |
| 49     | 96770000 | WASHER 26,5X32X1,5             | 1   |       |
| 48     | 96738000 | WASHER 17,5X23X1,5             | 1   |       |
| 47     | 90162500 | OIL SEAL 22x32x5               | 3   |       |
| 46     | 90912600 | BUSHING 22X25X30               | 3   |       |
| 45     | 99364400 | SCREW M 10x18-5931             | 4   |       |
| 44     | 96710600 | WASHER 10,2                    | 4   |       |
| 43     | 47200074 | PUMP FOOT                      | 2   |       |
| 42     | 90269200 | PACKING D.20X30X10 HP (66)     | 3   |       |
| 41     | 66216070 | INTERMEDIATE RING D.20         | 3   |       |
| 40     | 90269000 | PACKING D.20X28X6.5 LP (66)    | 3   |       |
| 39     | 90361600 | O-RING 34,65X1,78 (2137)       | 3   |       |
| 38     | 66080070 | PACKING RETAINER D. 20         | 3   |       |
| 37     | 98210000 | PLUG G3/8X13                   | 1   |       |
| 36     | 90164800 | OIL SEAL 30x55x7               | 1   |       |
| 35     | 47151022 | OPEN SIDE COVER (47-66)        | 1   |       |
| 34     | 66219566 | PISTON BOLT                    | 3   |       |
| 33     | 90358400 | O-RING D.10,82X1,78(2043)90SH3 |     |       |
| 32     | 66040009 | PISTON D. 20X54                | 3   |       |
| 31     | 96710100 | WASHER D. 10X28X0.5            | 3   |       |
| 30     | 66050066 | PISTON GUIDE - S.S.            | 3   |       |
| 29     | 97740500 | CONNECTING ROD-PIN D.14X39     | 3   |       |
| 28     | 99309900 | SCREW M 8x35 UNI 5931          | 6   |       |
| 27     | 90358500 | O-RING 10,82X1,78 (2043)       | 4   |       |
| 26     | 98204250 | PLUG G1/4"x12                  | 1   |       |
| 25     | 99188400 | SCREW M 6x20 UNI 5931          | 4   |       |
| 24     | 66160022 | REAR COVER                     | 1   |       |
| 23     | 90392200 | O-RING D.133.02X 2,62(3525)    | 1   |       |
| 22     | 66030001 | CONNECTING ROD                 | 3   |       |
| 21     | 91489200 | KEY 8(h9)X7X35 UNI 6604/A      | 1   |       |

## Illustration Male shaft (key)

| Pos. | Code     | Description                        | Qty | Notes |
|------|----------|------------------------------------|-----|-------|
| 20   | 66020035 | CRANKSHAFT C.19 - D. 24            | 1   |       |
| 19   | 98210600 | OIL DIP-STICK G3/8X80              | 1   |       |
| 18   | 66010022 | CRANKCASE                          | 1   |       |
| 17   | 91838000 | ROLLER BEARING NJ2206EC            | 2   |       |
| 16   | 90075600 | CIRCLIP D.45 (Z145)                | 1   |       |
| 15   | 70211801 | OIL SIGHT GLASS                    | 1   |       |
| 14   | 90387700 | O-RING 39,34X2,62 (3156)           | 1   |       |
| 13   | 90391300 | O-RING 67,95X2,62 (3268)           | 2   |       |
| 12   | 47151222 | SIDE CRANKCASE COVER FOR OIL GAUGE | 1   |       |
| 11   | 99303900 | SCREW M 8x16 UNI 5931              | 8   |       |
| 10   | 36712701 | INTAKE/DEL.VALVE ASSY(66)          | 6   |       |
| 9    | 66130041 | VALVE CAP M32x1.5x29.5             | 6   |       |
| 8    | 90516500 | ANTI-EXTR.RING D.24.7x29x1.5       | 6   |       |
| 7    | 36203551 | VALVE CAGE                         | 6   |       |
| 6    | 94738800 | SPRING Dm. 10x18.5                 | 6   |       |
| 5    | 36203476 | SPHERICAL VALVE                    | 6   |       |
| 4    | 36203366 | VALVE SEAT                         | 6   |       |
| 3    | 90385700 | O-RING 23,81X2,62 (132)            | 12  |       |
| 2    | 99380100 | SCREW M10X90 UNI 5931 8.8          | 8   |       |
| 1    | 66120041 | PUMP HEAD (PISTON D.20)            | 1   |       |

# Illustration Double male shaft (key)

| KIT 169 | KIT 2 | KIT 3 | KIT 171 | KIT 170 |
|---------|-------|-------|---------|---------|
|         |       |       |         |         |

**\*\*** Lubrificare con grasso di vasellina  
 cod. 12.0021.00  
**\*\*** Lubricate with vaseline grease  
 cod. 12.0021.00

Fissare con Loctite 542  
 colore ROSSO cod. 12.0062.00  
**\*** Fix with red Loctite 542  
 cod. 12.0062.00

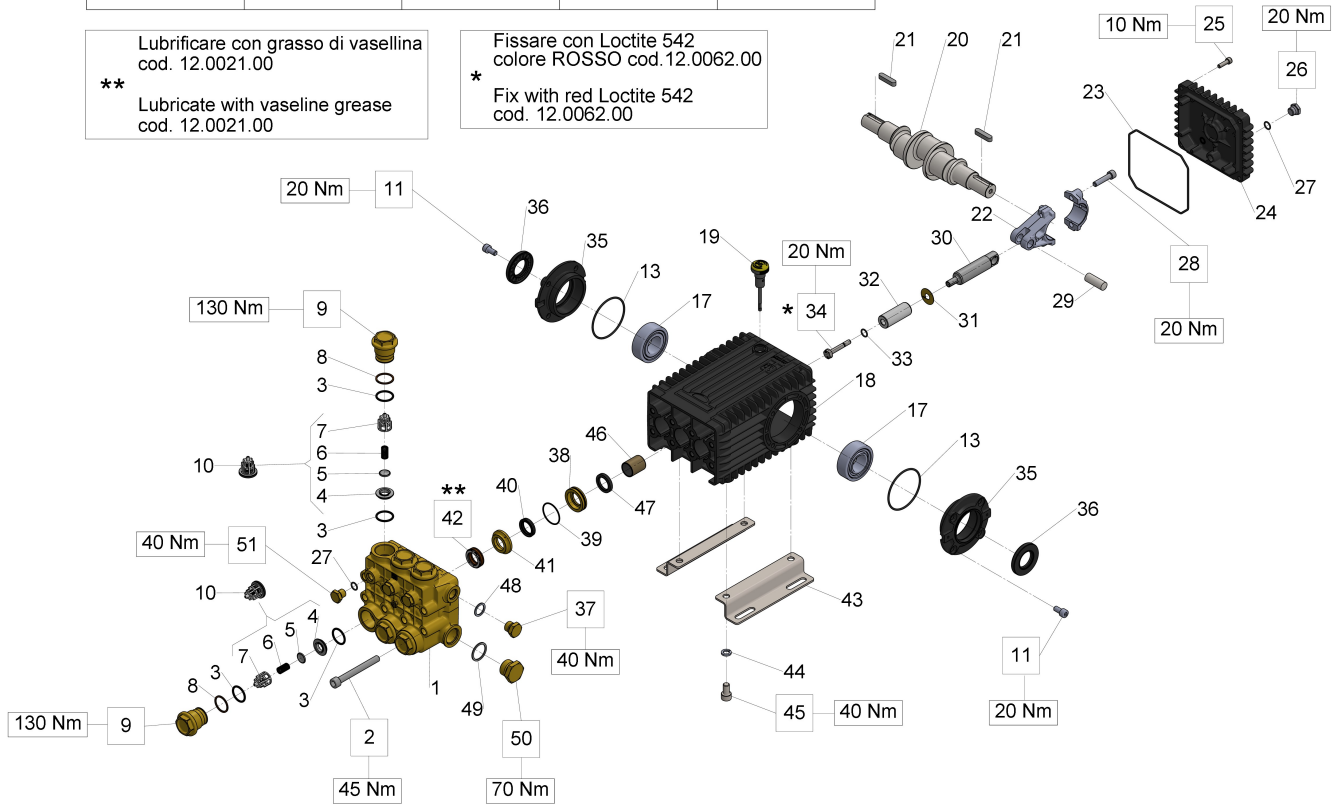

## Illustration Double male shaft (key)

| Pos.   | Code     | Description                    | Qty | Notes |
|--------|----------|--------------------------------|-----|-------|
| KIT3   | 34000301 | KIT 3 OIL SEAL D.30X55X7       | 1   |       |
| KIT2   | 34000201 | KIT 2 OIL SEAL D. 22X32X5,5    | 1   |       |
| KIT171 | 34017101 | KIT 171 COMPL.SEAL D.20 (66)   | 1   |       |
| KIT170 | 34017001 | KIT 170 PACKING D.20 (66)      | 1   |       |
| KIT169 | 34016901 | KIT 169 INTAKE/DEL.VALVE (66)  | 1   |       |
| 51     | 98204300 | PLUG G1/4X10                   | 3   |       |
| 50     | 98226800 | PLUG G3/4X16                   | 1   |       |
| 49     | 96770000 | WASHER 26,5X32X1,5             | 1   |       |
| 48     | 96738000 | WASHER 17,5X23X1,5             | 1   |       |
| 47     | 90162500 | OIL SEAL 22x32x5               | 3   |       |
| 46     | 90912600 | BUSHING 22X25X30               | 3   |       |
| 45     | 99364400 | SCREW M 10x18-5931             | 4   |       |
| 44     | 96710600 | WASHER 10,2                    | 4   |       |
| 43     | 47200074 | PUMP FOOT                      | 2   |       |
| 42     | 90269200 | PACKING D.20X30X10 HP (66)     | 3   |       |
| 41     | 66216070 | INTERMEDIATE RING D.20         | 3   |       |
| 40     | 90269000 | PACKING D.20X28X6.5 LP (66)    | 3   |       |
| 39     | 90361600 | O-RING 34,65X1,78 (2137)       | 3   |       |
| 38     | 66080070 | PACKING RETAINER D. 20         | 3   |       |
| 37     | 98210000 | PLUG G3/8X13                   | 1   |       |
| 36     | 90164800 | OIL SEAL 30x55x7               | 2   |       |
| 35     | 47151022 | OPEN SIDE COVER (47-66)        | 2   |       |
| 34     | 66219566 | PISTON BOLT                    | 3   |       |
| 33     | 90358400 | O-RING D.10,82X1,78(2043)90SH3 |     |       |
| 32     | 66040009 | PISTON D. 20X54                | 3   |       |
| 31     | 96710100 | WASHER D. 10X28X0.5            | 3   |       |
| 30     | 66050066 | PISTON GUIDE - S.S.            | 3   |       |
| 29     | 97740500 | CONNECTING ROD-PIN D.14X39     | 3   |       |
| 28     | 99309900 | SCREW M 8x35 UNI 5931          | 6   |       |
| 27     | 90358500 | O-RING 10,82X1,78 (2043)       | 4   |       |
| 26     | 98204250 | PLUG G1/4"x12                  | 1   |       |
| 25     | 99188400 | SCREW M 6x20 UNI 5931          | 4   |       |
| 24     | 66160022 | REAR COVER                     | 1   |       |
| 23     | 90392200 | O-RING D.133.02X 2,62(3525)    | 1   |       |
| 22     | 66030001 | CONNECTING ROD                 | 3   |       |
| 21     | 91489200 | KEY 8(h9)X7X35 UNI 6604/A      | 2   |       |

## Illustration Double male shaft (key)

| Pos. | Code     | Description                  | Qty | Notes |
|------|----------|------------------------------|-----|-------|
| 20   | 66021035 | CRANKSHAFT C.19 - DUAL PTO   | 1   |       |
| 19   | 98210600 | OIL DIP-STICK G3/8X80        | 1   |       |
| 18   | 66010022 | CRANKCASE                    | 1   |       |
| 17   | 91838000 | ROLLER BEARING NJ2206EC      | 2   |       |
| 13   | 90391300 | O-RING 67,95X2,62 (3268)     | 2   |       |
| 11   | 99303900 | SCREW M 8x16 UNI 5931        | 8   |       |
| 10   | 36712701 | INTAKE/DEL.VALVE ASSY(66)    | 6   |       |
| 9    | 66130041 | VALVE CAP M32x1.5x29.5       | 6   |       |
| 8    | 90516500 | ANTI-EXTR.RING D.24.7x29x1.5 | 6   |       |
| 7    | 36203551 | VALVE CAGE                   | 6   |       |
| 6    | 94738800 | SPRING Dm. 10x18.5           | 6   |       |
| 5    | 36203476 | SPHERICAL VALVE              | 6   |       |
| 4    | 36203366 | VALVE SEAT                   | 6   |       |
| 3    | 90385700 | O-RING 23,81X2,62 (132)      | 12  |       |
| 2    | 99380100 | SCREW M10X90 UNI 5931 8.8    | 8   |       |
| 1    | 66120041 | PUMP HEAD (PISTON D.20)      | 1   |       |

# Illustration Male shaft (key) - vers. ATEX

| KIT 169 | KIT 2 | KIT 3 | KIT 171 | KIT 170 |
|---------|-------|-------|---------|---------|
|         |       |       |         |         |

Lubrificare con grasso di vasellina  
cod. 12.0021.00  
\*\*  
Lubricate with vaseline grease  
cod. 12.0021.00

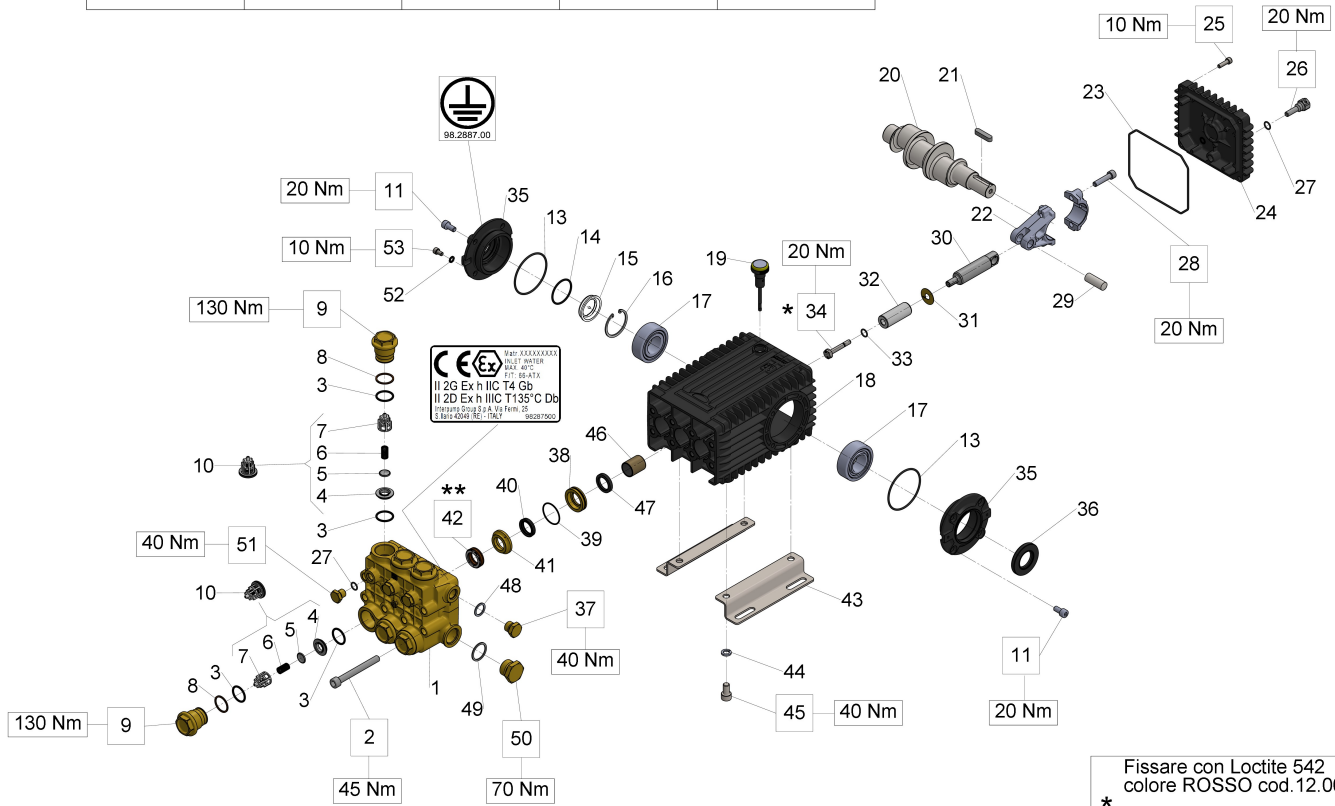

Fissare con Loctite 542  
colore ROSSO cod.12.0062.00  
\*  
Fix with red Loctite 542  
cod. 12.0062.00

## Illustration Male shaft (key) - vers. ATEX

| Pos.   | Code     | Description                     | Qty | Notes |
|--------|----------|---------------------------------|-----|-------|
| KIT3   | 34000301 | KIT 3 OIL SEAL D.30X55X7        | 1   |       |
| KIT2   | 34000201 | KIT 2 OIL SEAL D. 22X32X5,5     | 1   |       |
| KIT171 | 34017101 | KIT 171 COMPL.SEAL D.20 (66)    | 1   |       |
| KIT170 | 34017001 | KIT 170 PACKING D.20 (66)       | 1   |       |
| KIT169 | 34016901 | KIT 169 INTAKE/DEL.VALVE (66)   | 1   |       |
| 53     | 99180900 | SCREW M06X10 5931 A2-70         | 1   |       |
| 52     | 96693950 | WASHER 6.4x11.0x0.7 D6798A INOX | 1   |       |
| 51     | 98204300 | PLUG G1/4X10                    | 3   |       |
| 50     | 98226800 | PLUG G3/4X16                    | 1   |       |
| 49     | 96770000 | WASHER 26,5X32X1,5              | 1   |       |
| 48     | 96738000 | WASHER 17,5X23X1,5              | 1   |       |
| 47     | 90162500 | OIL SEAL 22x32x5                | 3   |       |
| 46     | 90912600 | BUSHING 22X25X30                | 3   |       |
| 45     | 99364400 | SCREW M 10x18-5931              | 4   |       |
| 44     | 96710600 | WASHER 10,2                     | 4   |       |
| 43     | 47200074 | PUMP FOOT                       | 2   |       |
| 42     | 90269200 | PACKING D.20X30X10 HP (66)      | 3   |       |
| 41     | 66216070 | INTERMEDIATE RING D.20          | 3   |       |
| 40     | 90269000 | PACKING D.20X28X6.5 LP (66)     | 3   |       |
| 39     | 90361600 | O-RING 34,65X1,78 (2137)        | 3   |       |
| 38     | 66080070 | PACKING RETAINER D. 20          | 3   |       |
| 37     | 98210000 | PLUG G3/8X13                    | 1   |       |
| 36     | 90164800 | OIL SEAL 30x55x7                | 1   |       |
| 35     | 47151322 | SIDE CRANKCASE COVER (ATEX)     | 1   |       |
| 35     | 47151022 | OPEN SIDE COVER (47-66)         | 1   |       |
| 34     | 66219566 | PISTON BOLT                     | 3   |       |
| 33     | 90358400 | O-RING D.10,82X1,78(2043)90SH3  |     |       |
| 32     | 66040009 | PISTON D. 20X54                 | 3   |       |
| 31     | 96710100 | WASHER D. 10X28X0.5             | 3   |       |
| 30     | 66050066 | PISTON GUIDE - S.S.             | 3   |       |
| 29     | 97740500 | CONNECTING ROD-PIN D.14X39      | 3   |       |
| 28     | 99309900 | SCREW M 8x35 UNI 5931           | 6   |       |
| 27     | 90358500 | O-RING 10,82X1,78 (2043)        | 4   |       |
| 26     | 98203600 | PLUG G1/4x8 FOR PROBE D.6 S.S.  | 1   |       |

## Illustration Male shaft (key) - vers. ATEX

| Pos. | Code     | Description                            | Qty | Notes |
|------|----------|--|-----|-------|
| 25   | 99188400 | SCREW M 6x20 UNI 5931                  | 4   |       |
| 24   | 66160022 | REAR COVER                             | 1   |       |
| 23   | 90392200 | O-RING D.133.02X 2,62(3525)            | 1   |       |
| 22   | 66030001 | CONNECTING ROD                         | 3   |       |
| 21   | 91489200 | KEY 8(h9)X7X35 UNI 6604/A              | 1   |       |
| 20   | 66020035 | CRANKSHAFT C.19 - D. 24                | 1   |       |
| 19   | 98210700 | OIL DIPSTICK G3/8X64<br>D4+FILTER ATEX | 1   |       |
| 18   | 66010022 | CRANKCASE                              | 1   |       |
| 17   | 91838000 | ROLLER BEARING NJ2206EC                | 2   |       |
| 16   | 90075500 | STOP RING J45 UNI7437                  | 1   |       |
| 15   | 70211751 |  | 1   |       |
| 14   | 90387700 | O-RING 39,34X2,62 (3156)               | 1   |       |
| 13   | 90391300 | O-RING 67,95X2,62 (3268)               | 2   |       |
| 11   | 99303900 | SCREW M 8x16 UNI 5931                  | 8   |       |
| 10   | 36712701 | INTAKE/DEL.VALVE ASSY(66)              | 6   |       |
| 9    | 66130041 | VALVE CAP M32x1.5x29.5                 | 6   |       |
| 8    | 90516500 | ANTI-EXTR.RING D.24.7x29x1.5           | 6   |       |
| 7    | 36203551 | VALVE CAGE                             | 6   |       |
| 6    | 94738800 | SPRING Dm. 10x18.5                     | 6   |       |
| 5    | 36203476 | SPHERICAL VALVE                        | 6   |       |
| 4    | 36203366 | VALVE SEAT                             | 6   |       |
| 3    | 90385700 | O-RING 23,81X2,62 (132)                | 12  |       |
| 2    | 99380100 | SCREW M10X90 UNI 5931 8.8              | 8   |       |
| 1    | 66120041 | PUMP HEAD (PISTON D.20)                | 1   |       |