



## C3W2013HT



### TECHNICAL INFORMATION

Flow (L/min)	13
Flow (US Gpm)	3,43
Rotation regime (rpm)	1450
Pressure (MPa)	20
Pressure (bar)	200
Pressure (psi)	2900
Power (hp)	6,8
Power (kW)	5
Overall dimensions L x l x h (mm)	265x223x140
Weight (kg)	9,5



Documents

Male shaft (key) - GAS

---

Male shaft (key) - NPT

---



## Illustration Male shaft (key) - GAS

Pos.	Code	Description	Qty	Notes
KIT409	34040901	KIT 409*TENUTE COMPLETE D.20 (59.CW HT)	1	
KIT350	34035001	KIT 350 PACKING D. 20 S. 59 SS	1	
KIT292	34029201	KIT 292 VALVE PLUGS (NICK.)59 S.	1	
KIT271	34027101	KIT 271 OIL SEAL D.15 58/59 SERIES	1	
KIT269	34026901	KIT 269 INTAKE/DELIVERY VALVES	1	
72	50200074	PUMP FOOT	2	
71	96701600	WASHER 8,4	4	
70	99303700	SCREW M 8x16-5739	4	
57	91489200	KEY 8(h9)X7X35 UNI 6604/A	1	
56	90164800	OIL SEAL 30x55x7	1	
55	47151022	OPEN SIDE COVER (47-66)	1	
54	90358500	O-RING 10,82X1,78 (2043)	1	
53	98204250	PLUG G1/4"x12	1	
52	59160022	REAR CRANKCASE COVER	1	
51	90392200	O-RING D.133.02X 2,62(3525)	1	
50	98211300	ASTA LIVELLO OLIO G3/8x54 D.41	1	
49	97567800	SHIM D.74,5X104X0,1	1	
49	97568000	SHIM D.74.5X104X0.3	1	
48	90391300	O-RING 67,95X2,62 (3268)	2	
47	91837500	TAPER BEARING	2	
46	99303900	SCREW M 8x16 UNI 5931	12	
45	90075600	CIRCLIP D.45 (ZJ45)	1	
44	59020335	CRANKSHAFT C.10	1	
43	70211801	OIL SIGHT GLASS	1	
42	90387700	O-RING 39,34X2,62 (3156)	1	
41	47151222	SIDE CRANKCASE COVER FOR OIL GAUGE	1	
40	99309900	SCREW M 8x35 UNI 5931	6	
39	59030001	CONNECTING ROD COMPLETE	3	
38	97739900	GUDGEON PIN D.14X34	3	
37	59050066	PISTON GUIDE	3	
36	90156550	OIL SEAL D.15X24X5/7	3	
35	58210451	PROTECTION	1	
34	59010022	PUMP CRANKCASE	1	
33	59211082	SPONGE GASKET D.3X103	1	
32	96699000	WASHER D.7.5X23X0.5	3	

## Illustration Male shaft (key) - GAS

Pos.	Code	Description	Qty	Notes
31	96751400	WASHER 21,5X27X1,5	1	
30	98217900	PLUG G 1/2X10 NICKEL	1	
29	96738000	WASHER 17,5X23X1,5	1	
28	98209900	PLUG G. 3/8X13 NICKEL	1	
27	59211270	RING FOR PACKING D.20 HT	3	
26	90225000	SEAL D.20X26.15 L.P.(66HT)	3	
24	90361200	O-RING 31,47X1,78 (2125)	3	
23	59607201	PACKING RETAINER+SLEEVE D.20 BR. HT	3	
22	90226000	SEAL D.20X30X10 H.P. (HT)	3	
21	99317700	VITE M08x60 5931 12.9 G321A+M	8	
20	98213750	PLUG M18X1,5X10 D.23 (NICK.)	3	
19	90359300	O-RING 15,60X1,78 (2062)	3	
18	36719301	OUTLET VALVE	3	
17	36211151	VALVE CAGE	3	
16	94733300	SPRING D.6.2x10.5 S.S.	3	
15	36211276	SPHERICAL VALVE	3	
14	36211366	VALVE SEAT	3	
13	90367400	O-RING D. 12X2 (120-20)	3	
12	59040009	PISTON D. 20X42	3	
11	96690500	WASHER D.5X11.5x0.4 INOX+FKM58/59/63HT	3	
10	99169000	SCREW M05X55 SPEC. A2-70	3	
9	98222500	VALVE CAP M24X1,5X17 NICKEL	3	
8	90384700	O-RING 20,29X2,62(3081)	3	
7	36711501	INTAKE/DELIVERY VALVE	3	
6	90384100	O-RING 17,12X2,62 (3068)	3	
5	36200366	VALVE SEAT	3	
4	36200176	VALVE PLATE	3	
3	94737600	SPRING D. 9,4X14,8	3	
2	36202551	VALVE CAGE	3	
1	59122036	MANIFOLD FOR PISTON D. 20 CW	1	

# Illustration Male shaft (key) - NPT

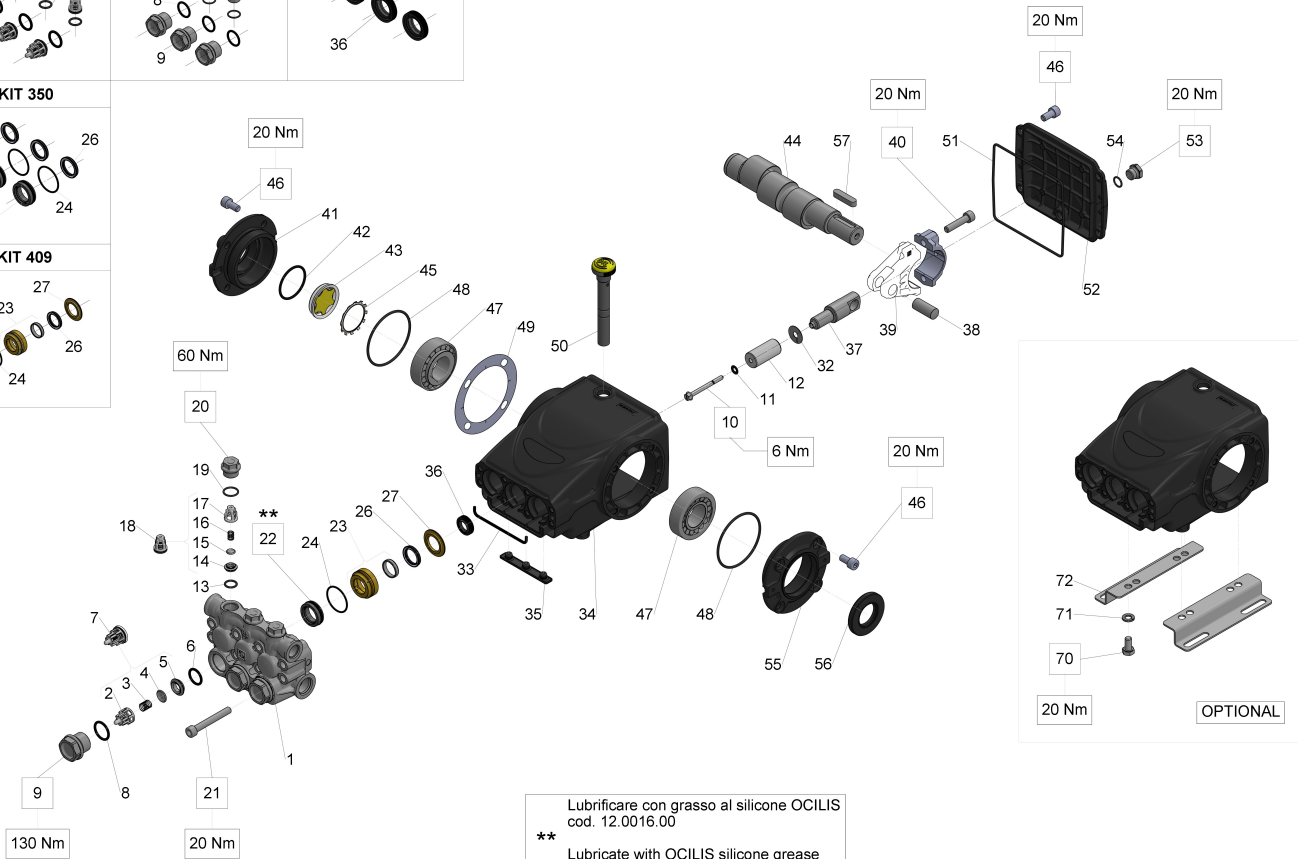
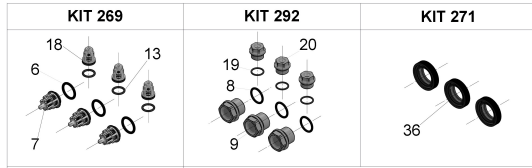

Lubrificare con grasso al silicone OCILIS cod. 12.0016.00  
 \*\* Lubricate with OCILIS silicone grease cod. 12.0016.00

## Illustration Male shaft (key) - NPT

Pos.	Code	Description	Qty	Notes
KIT409	34040901	KIT 409*TENUTE COMPLETE D.20 (59.CW HT)	1	
KIT350	34035001	KIT 350 PACKING D. 20 S. 59 SS	1	
KIT292	34029201	KIT 292 VALVE PLUGS (NICK.)59 S.	1	
KIT271	34027101	KIT 271 OIL SEAL D.15 58/59 SERIES	1	
KIT269	34026901	KIT 269 INTAKE/DELIVERY VALVES	1	
72	50200074	PUMP FOOT	2	
71	96701600	WASHER 8,4	4	
70	99303700	SCREW M 8x16-5739	4	
57	91489200	KEY 8(h9)X7X35 UNI 6604/A	1	
56	90164800	OIL SEAL 30x55x7	1	
55	47151022	OPEN SIDE COVER (47-66)	1	
54	90358500	O-RING 10,82X1,78 (2043)	1	
53	98204250	PLUG G1/4"x12	1	
52	59160022	REAR CRANKCASE COVER	1	
51	90392200	O-RING D.133.02X 2,62(3525)	1	
50	98211300	ASTA LIVELLO OLIO G3/8x54 D.41		
49	97567800	SHIM D.74,5X104X0,1	1	
49	97568000	SHIM D.74.5X104X0.3	1	
48	90391300	O-RING 67,95X2,62 (3268)	2	
47	91837500	TAPER BEARING	2	
46	99303900	SCREW M 8x16 UNI 5931	12	
45	90075600	CIRCLIP D.45 (ZJ45)	1	
44	59020335	CRANKSHAFT C.10	1	
43	70211801	OIL SIGHT GLASS	1	
42	90387700	O-RING 39,34X2,62 (3156)	1	
41	47151222	SIDE CRANKCASE COVER FOR OIL GAUGE	1	
40	99309900	SCREW M 8x35 UNI 5931	6	
39	59030001	CONNECTING ROD COMPLETE	3	
38	97739900	GUDGEON PIN D.14X34	3	
37	59050066	PISTON GUIDE	3	
36	90156550	OIL SEAL D.15X24X5/7	3	
35	58210451	PROTECTION	1	
34	59010022	PUMP CRANKCASE	1	
33	59211082	SPONGE GASKET D.3X103	1	
32	96699000	WASHER D.7.5X23X0.5	3	

## Illustration Male shaft (key) - NPT

Pos.	Code	Description	Qty	Notes
27	59211270	RING FOR PACKING D.20 HT	3	
26	90225000	SEAL D.20X26.15 L.P.(66HT)	3	
24	90361200	O-RING 31,47X1,78 (2125)	3	
23	59607201	PACKING RETAINER+SLEEVE D.20 BR. HT	3	
22	90226000	SEAL D.20X30X10 H.P. (HT)	3	
21	99317700	VITE M08x60 5931 12.9 G321A+M	8	
20	98213750	PLUG M18X1,5X10 D.23 (NICK.)	3	
19	90359300	O-RING 15,60X1,78 (2062)	3	
18	36719301	OUTLET VALVE	3	
17	36211151	VALVE CAGE	3	
16	94733300	SPRING D.6.2x10.5 S.S.	3	
15	36211276	SPHERICAL VALVE	3	
14	36211366	VALVE SEAT	3	
13	90367400	O-RING D. 12X2 (120-20)	3	
12	59040009	PISTON D. 20X42	3	
11	96690500	WASHER D.5X11.5x0.4 INOX+FKM58/59/63HT	3	
10	99169000	SCREW M05X55 SPEC. A2-70	3	
9	98222500	VALVE CAP M24X1,5X17 NICKEL	3	
8	90384700	O-RING 20,29X2,62(3081)	3	
7	36711501	INTAKE/DELIVERY VALVE	3	
6	90384100	O-RING 17,12X2,62 (3068)	3	
5	36200366	VALVE SEAT	3	
4	36200176	VALVE PLATE	3	
3	94737600	SPRING D. 9,4X14,8	3	
2	36202551	VALVE CAGE	3	
1	59125436		1	