



FE5101



TECHNICAL INFORMATION

| | |
|-----------------------------------|-------------|
| Flow (L/min) | 1,0 / 1,2 |
| Flow (US Gpm) | 0,26 / 0,32 |
| Rotation regime (rpm) | 1450 / 1750 |
| Pressure (MPa) | 10 |
| Pressure (bar) | 100 |
| Pressure (psi) | 1450 |
| Power (hp) | 0,28 / 0,33 |
| Power (kW) | 0,21 / 0,25 |
| Overall dimensions L x l x h (mm) | 177x175x130 |
| Weight (kg) | 5,2 |



Documents

Male shaft (key) - GAS

Male shaft (key) + integrated valve

Illustration Male shaft (key) - GAS

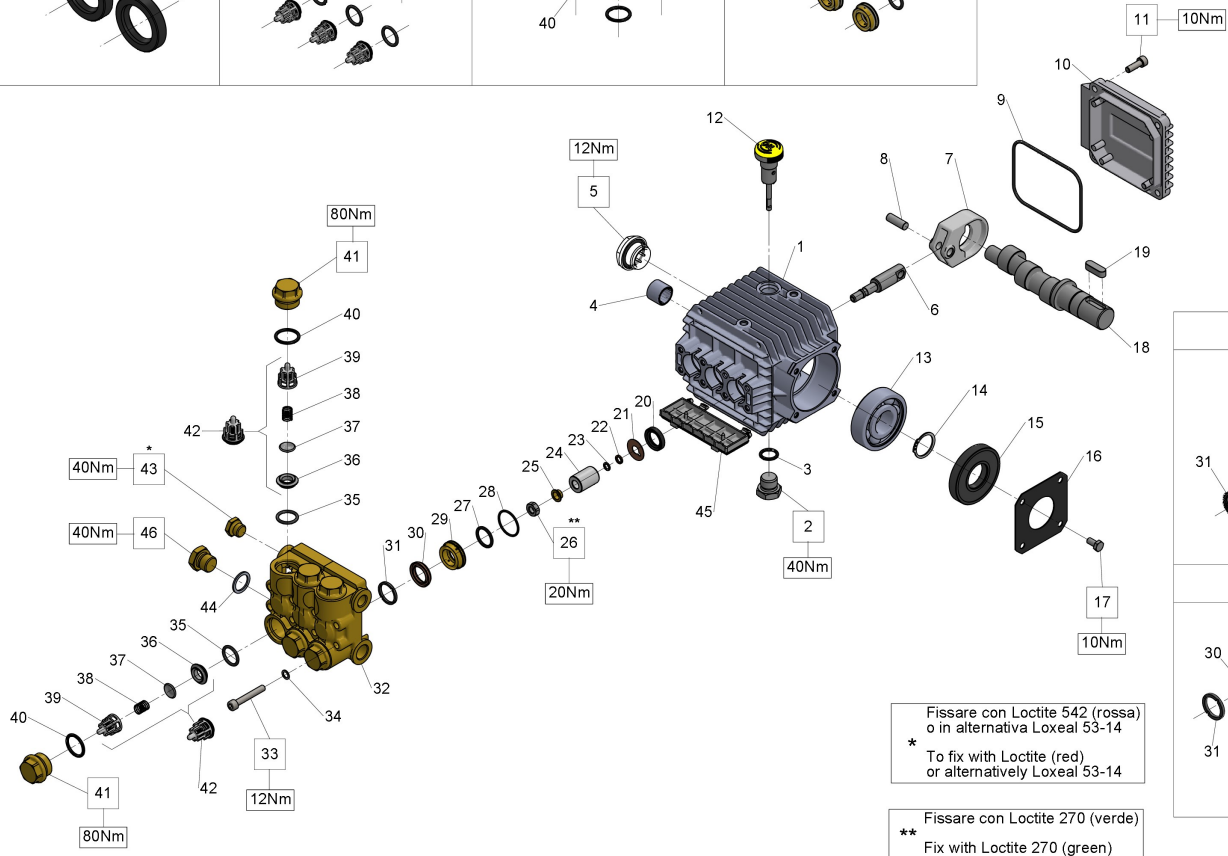
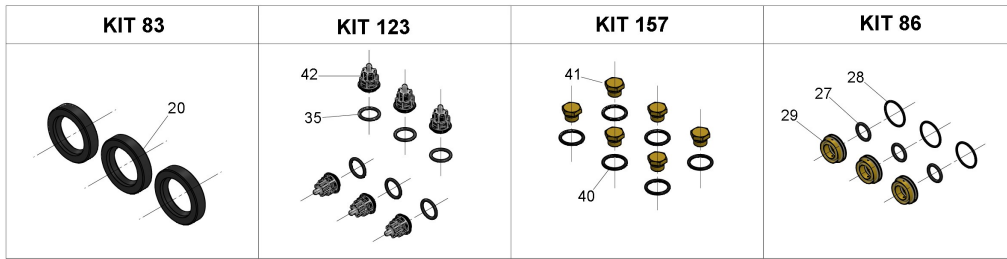

Fissare con Loctite 542 (rossa)
o in alternativa Loxeal 53-14

* To fix with Loctite (red)
or alternatively Loxeal 53-14

Fissare con Loctite 270 (verde)
Fix with Loctite 270 (green)

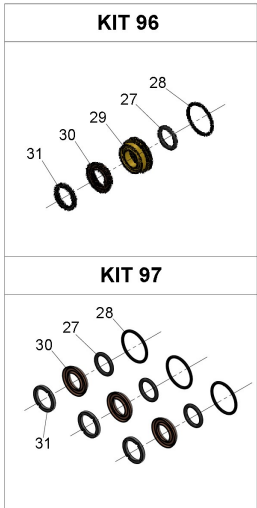

Illustration Male shaft (key) - GAS

| Pos. | Code | Description | Qty | Notes |
|--------|----------|-------------------------------|-----|-------|
| KIT97 | 34009701 | | 1 | |
| KIT96 | 34009601 | | 1 | |
| KIT86 | 34008601 | | 1 | |
| KIT83 | 34008301 | | 1 | |
| KIT157 | 34015701 | | 1 | |
| KIT123 | 34012301 | KIT 123 INTAKE/DELIVERY VALVE | 1 | |
| 46 | 98210000 | PLUG G3/8X13 | 1 | |
| 45 | 51209051 | | 1 | |
| 44 | 96738000 | WASHER 17,5X23X1,5 | 1 | |
| 43 | 98204100 | PLUG G1/4X9 | 1 | |
| 42 | 36711501 | INTAKE/DELIVERY VALVE | 6 | |
| 41 | 98221600 | | 6 | |
| 40 | 90384700 | O-RING 20,29X2,62(3081) | 6 | |
| 39 | 36202551 | VALVE CAGE | 6 | |
| 38 | 94737600 | SPRING D. 9,4X14,8 | 6 | |
| 37 | 36200176 | VALVE PLATE | 6 | |
| 36 | 36200366 | VALVE SEAT | 6 | |
| 35 | 90384100 | O-RING 17,12X2,62 (3068) | 6 | |
| 34 | 96693800 | WASHER 6,4X10X0,7 | 8 | |
| 33 | 99194300 | | 8 | |
| 32 | 51120041 | | 1 | |
| 31 | 51100051 | HEAD RING D. 15 | 3 | |
| 30 | 90262000 | PACKING D. 15X25X5/3,1 | 3 | |
| 29 | 51080070 | | 3 | |
| 28 | 90360400 | O-RING 25,12X1,78 (2100) | 3 | |
| 27 | 90383500 | O-RING 15,08X2,62 (119) | 3 | |
| 26 | 92221600 | NUT M8X13X5 | 3 | |
| 25 | 44211570 | WASHER D. 8 | 3 | |
| 24 | 51040009 | | 3 | |
| 23 | 90357300 | O-RING D. 5,28X1,78 (2021) | 3 | |
| 22 | 90502200 | ANTI-EXTRUSION RING | 3 | |
| 21 | 96707000 | | 3 | |
| 20 | 90156500 | | 3 | |
| 19 | 91487700 | KEY 8(h9)X7X25 UNI 6604/A | 1 | |
| 18 | 51022065 | | 1 | |
| 17 | 99180700 | SCREW M 6x12 UNI 5739 | 4 | |
| 16 | 50150074 | CRANKCASE COVER | 1 | |
| 15 | 90164100 | OIL SEAL D.25X62X10 | 1 | |
| 14 | 90063500 | CIRCLIP D. 25 UNI 7435 | 1 | |

Illustration Male shaft (key) - GAS

| Pos. | Code | Description | Qty | Notes |
|------|----------|-----------------------------|-----|-------|
| 13 | 91832800 | | 1 | |
| 12 | 98210300 | OIL DIP-STICK G3/8X51 | 1 | |
| 11 | 99186700 | SCREW M 6x18 UNI 5931 | 4 | |
| 10 | 51160022 | | 1 | |
| 9 | 90391700 | | 1 | |
| 8 | 97731000 | | 3 | |
| 7 | 51030122 | | 3 | |
| 6 | 51050056 | | 3 | |
| 5 | 97596800 | OIL LEVEL INDICATOR G3/4X15 | 1 | |
| 4 | 91801400 | | 1 | |
| 3 | 90383300 | O-RING 13,95X2,62 (3056) | 1 | |
| 2 | 98210050 | PLUG G3/8x13 TE22 | 1 | |
| 1 | 51010622 | | 1 | |

Illustration Male shaft (key) + integrated valve

| Pos. | Code | Description | Qty | Notes |
|--------|----------|-------------------------------|-----|-------|
| KIT97 | 34009701 | | 1 | |
| KIT96 | 34009601 | | 1 | |
| KIT86 | 34008601 | | 1 | |
| KIT83 | 34008301 | | 1 | |
| KIT267 | 34026701 | | 1 | |
| KIT157 | 34015701 | | 1 | |
| KIT123 | 34012301 | KIT 123 INTAKE/DELIVERY VALVE | 1 | |
| 62 | 51209051 | | 1 | |
| 61 | 36005470 | | 1 | |
| 60 | 99126100 | | 1 | |
| 59 | 94740000 | | 1 | |
| 58 | 36323770 | | 1 | |
| 57 | 90502000 | | 1 | |
| 56 | 90357000 | O-RING 4,48X1,78 (2018) | 1 | |
| 55 | 90356900 | | 1 | |
| 54 | 90500700 | | 1 | |
| 53 | 36005570 | | 1 | |
| 52 | 36323966 | | 1 | |
| 51 | 10008566 | | 1 | |
| 50 | 90357600 | | 1 | |
| 49 | 36005670 | | 1 | |
| 48 | 90382300 | O-RING 9,92X2,62 (112) | 1 | |
| 47 | 98210000 | PLUG G3/8X13 | 1 | |
| 46 | 96738000 | WASHER 17,5X23X1,5 | 1 | |
| 45 | 98205700 | PLUG M14X1,5X9 | 1 | |
| 44 | 98204100 | PLUG G1/4X9 | 2 | |
| 43 | 10007870 | NIPPLE D. 3 G3/8 | 1 | |
| 42 | 36711501 | INTAKE/DELIVERY VALVE | 6 | |
| 41 | 98221600 | | 6 | |
| 40 | 90384700 | O-RING 20,29X2,62(3081) | 7 | |
| 39 | 36202551 | VALVE CAGE | 6 | |
| 38 | 94737600 | SPRING D. 9,4X14,8 | 6 | |
| 37 | 36200176 | VALVE PLATE | 6 | |
| 36 | 36200366 | VALVE SEAT | 6 | |
| 35 | 90384100 | O-RING 17,12X2,62 (3068) | 2 | |
| 34 | 96693800 | WASHER 6,4X10X0,7 | 1 | |
| 33 | 99194300 | | 1 | |
| 32 | 51120141 | | 1 | |
| 31 | 51100051 | HEAD RING D. 15 | 3 | |
| 30 | 90262000 | PACKING D. 15X25X5/3,1 | 3 | |

Illustration Male shaft (key) + integrated valve

| Pos. | Code | Description | Qty | Notes |
|------|----------|-----------------------------|-----|-------|
| 29 | 51080070 | | 3 | |
| 28 | 90360400 | O-RING 25,12X1,78 (2100) | 3 | |
| 27 | 90383500 | O-RING 15,08X2,62 (119) | 3 | |
| 26 | 92221600 | NUT M8X13X5 | 3 | |
| 25 | 44211570 | WASHER D. 8 | 3 | |
| 24 | 51040009 | | 3 | |
| 23 | 90357300 | O-RING D. 5,28X1,78 (2021) | 3 | |
| 22 | 90502200 | ANTI-EXTRUSION RING | 3 | |
| 21 | 96707000 | | 3 | |
| 20 | 90156500 | | 3 | |
| 19 | 91487700 | KEY 8(h9)X7X25 UNI 6604/A | 1 | |
| 18 | 51022065 | | 1 | |
| 17 | 99180700 | SCREW M 6x12 UNI 5739 | 4 | |
| 16 | 50150074 | CRANKCASE COVER | 1 | |
| 15 | 90164100 | OIL SEAL D.25X62X10 | 1 | |
| 14 | 90063500 | CIRCLIP D. 25 UNI 7435 | 1 | |
| 13 | 91832800 | | 1 | |
| 12 | 98210300 | OIL DIP-STICK G3/8X51 | 1 | |
| 11 | 99186700 | SCREW M 6x18 UNI 5931 | 4 | |
| 10 | 51160022 | | 1 | |
| 9 | 90391700 | | 1 | |
| 8 | 97731000 | | 3 | |
| 7 | 51030122 | | 3 | |
| 6 | 51050056 | | 3 | |
| 5 | 97596800 | OIL LEVEL INDICATOR G3/4X15 | 1 | |
| 4 | 91801400 | | 1 | |
| 3 | 90383300 | O-RING 13,95X2,62 (3056) | 2 | |
| 2 | 98210050 | PLUG G3/8x13 TE22 | 1 | |
| 1 | 51010622 | | 1 | |