



## WW968



### TECHNICAL INFORMATION

Flow (L/min)	15
Flow (US Gpm)	3,96
Rotation regime (rpm)	3400
Pressure (MPa)	25
Pressure (bar)	250
Pressure (psi)	3600
Power (hp)	10
Power (kW)	7,35
Overall dimensions L x l x h (mm)	225x223x142,5
Weight (kg)	8,7



## Documents

Male shaft (key)

---

Hollow shaft (key) Ø28,6 - vers. A

---

Hollow shaft (key) Ø25,4 - vers. C

---

# Illustration Male shaft (key)

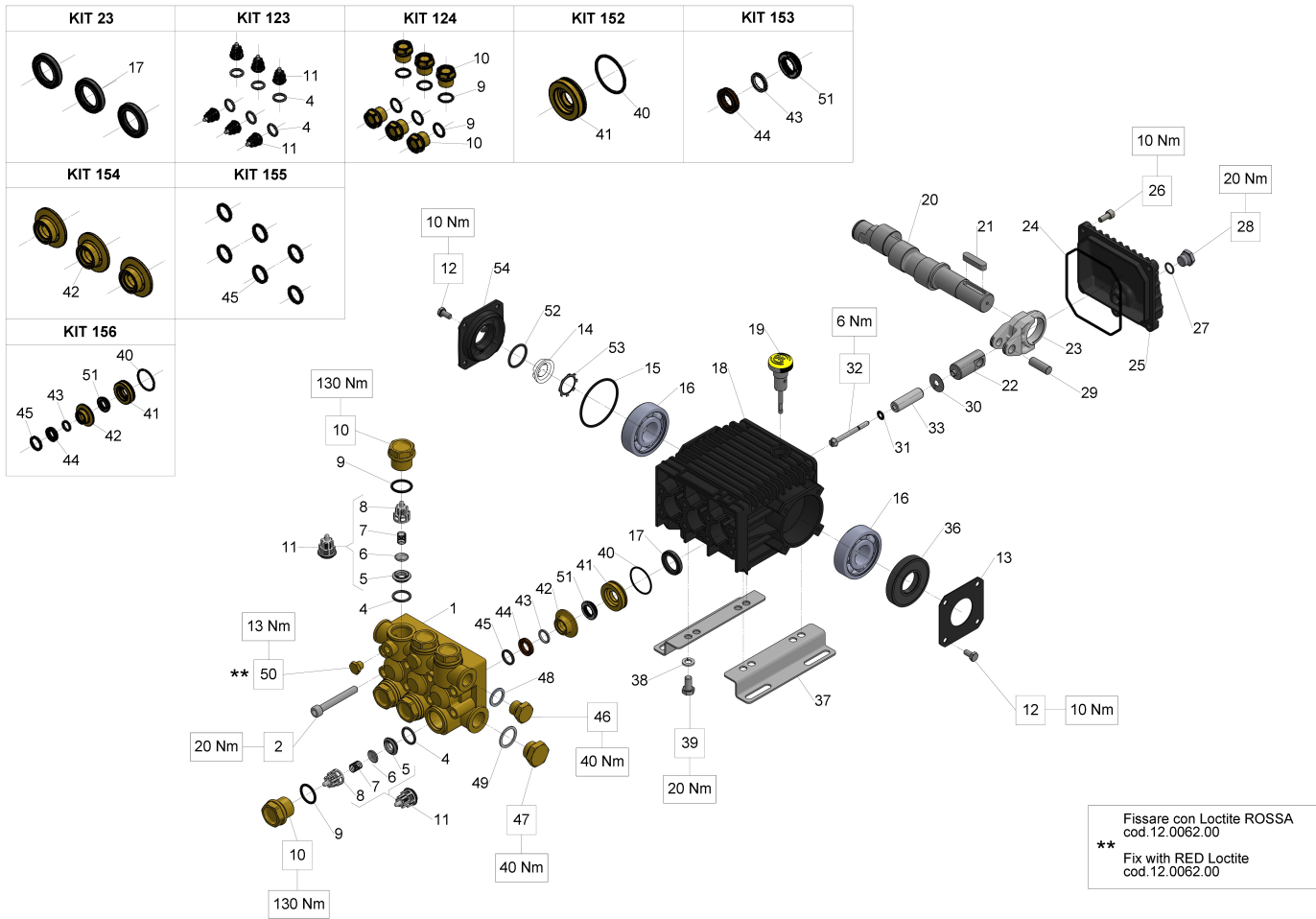

## Illustration Male shaft (key)

Pos.	Code	Description	Qty	Notes
KIT156	34015601	KIT 156 CPL.SEAL FOR PIST.D13	1	
KIT155	34015501	KIT 155 HEAD RING D. 13	1	
KIT154	34015401	KIT 154 INTERM.RING D. 13	1	
KIT153	34015301	KIT 153 PACKING D.13	1	
KIT152	34015201	KIT 152 PACKING RETAINER D.13	1	
KIT124	34012401	KIT 124 VALVE CAPS	1	
KIT123	34012301	KIT 123 INTAKE/DELIVERY VALVE	1	
KIT23	34002301	KIT 23 OIL SEAL D.20X30X5	1	
54	53150022	SIDE CRANKCASE COVER	1	
53	90067100	CIRCLIP ZJ30	1	
52	90385900	O-RING 25,07X2,62 (3100)	1	
51	90260300	PACKING D.13X23X5,8 L.P.	3	
50	98196600	PLUG G1/8X8	1	
49	96751400	WASHER 21,5X27X1,5	1	
48	96738000	WASHER 17,5X23X1,5	1	
47	98217600	PLUG G1/2X10	1	
46	98210000	PLUG G3/8X13	1	
45	44100251	HEAD RING D. 13	3	
44	90260200	PACKING D.13X21X4 H.P.	3	
43	90507600	ANTI-EXTRUSION RING D.13X17X2	3	
42	44216270	INTERMEDIATE RING D. 13	3	
41	44080370	PACKING RETAINER D. 13	3	
40	90361200	O-RING 31,47X1,78 (2125)	3	
39	99303700	SCREW M 8x16-5739	4	
38	96701600	WASHER 8,4	4	
37	50200074	PUMP FOOT	2	
36	90164100	OIL SEAL D.25X62X10	1	
33	58040009	PISTON D.13X42	3	
32	99169000	SCREW M05X55 SPEC. A2-70	3	
31	96690500	WASHER D.5X11.5x0.4 INOX+FKM58/59/63HT	3	
30	96699000	WASHER D.7.5X23X0.5	3	
29	97734000	CONNECTING-ROD PIN D.10X29,5	3	
28	98204250	PLUG G1/4"x12	1	
27	90358500	O-RING 10,82X1,78 (2043)	1	
26	99183700	SCREW M 6x14 UNI 5931	5	
25	44160022	REAR CRANKCASE COVER	1	

## Illustration Male shaft (key)

Pos.	Code	Description	Qty	Notes
24	90392000	O-RING 101,27X2,62 (3400)	1	
23	44030022	CONNECTING ROD	3	
22	44050266	PISTON GUIDE M5	3	
21	91489200	KEY 8(h9)X7X35 UNI 6604/A	1	
20	44020635	CRANKSHAFT C.13 (D.24)	1	
19	98210300	OIL DIP-STICK G3/8X51	1	
18	44010022	CRANKCASE	1	
17	90161400	OIL SEAL 20x30x5	3	
16	91833100	BALL BEARING 6305 SKF	2	
15	90389800	O-RING 56,82X2,62 (3225)	1	
14	53210851	OIL LEVEL GAUGE	1	
13	50150074	CRANKCASE COVER	1	
12	99180700	SCREW M 6x12 UNI 5739	8	
11	36711501	INTAKE/DELIVERY VALVE	6	
10	98222600	VALVE CAP M24X1,5X17	6	
9	90384700	O-RING 20,29X2,62(3081)	6	
8	36202551	VALVE CAGE	6	
7	94737600	SPRING D. 9,4X14,8	6	
6	36200176	VALVE PLATE	6	
5	36200366	VALVE SEAT	6	
4	90384100	O-RING 17,12X2,62 (3068)	6	
2	99317500	SCREW M 8x60 UNI 5931	8	
1	44120641	BRASS HEAD (D. 13)	1	

# Illustration Hollow shaft (key) Ø28,6 - vers. A

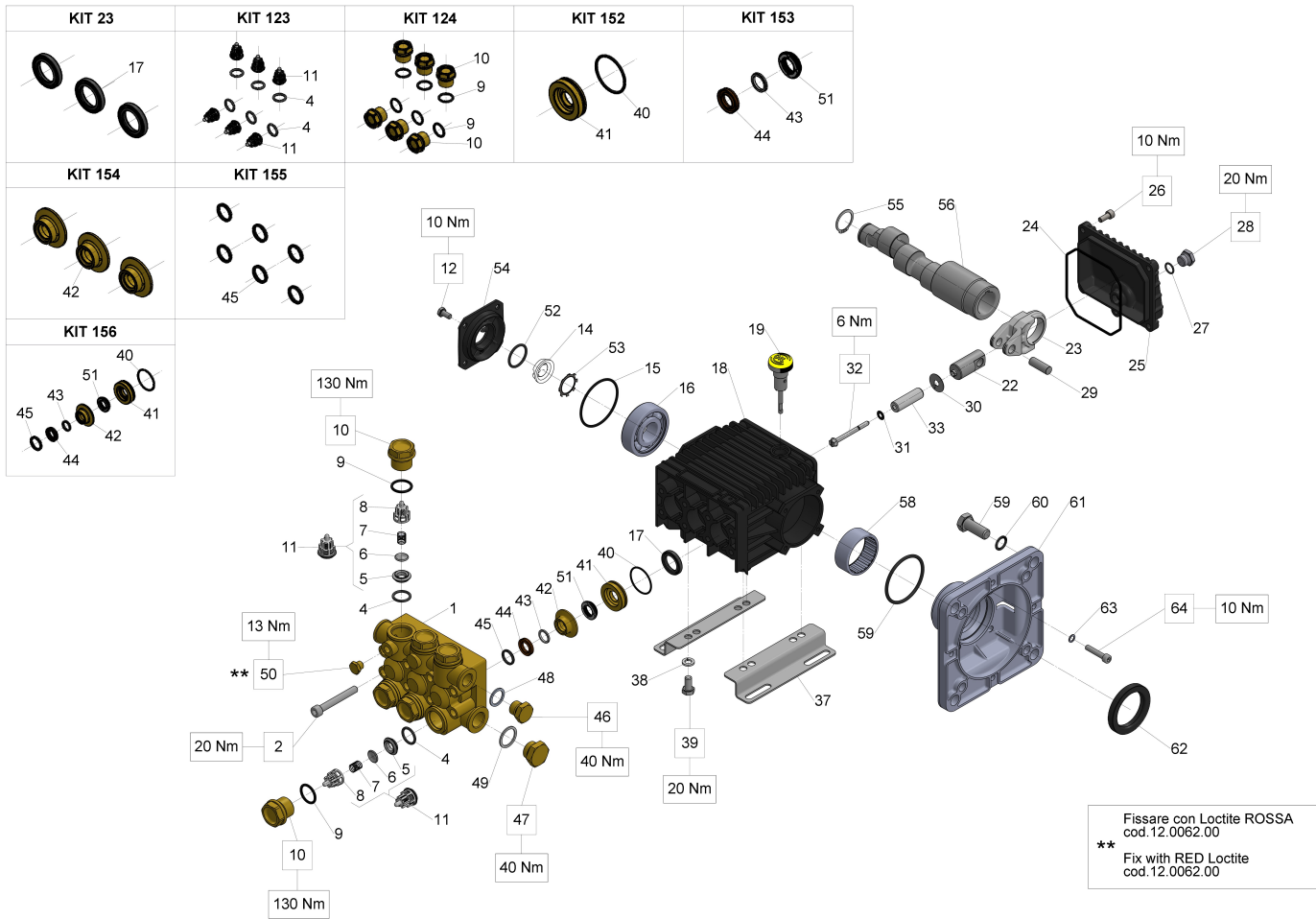

## Illustration Hollow shaft (key) Ø28,6 - vers. A

Pos.	Code	Description	Qty	Notes
KIT23	34002301	KIT 23 OIL SEAL D.20X30X5	1	
KIT156	34015601	KIT 156 CPL.SEAL FOR PIST.D13	1	
KIT155	34015501	KIT 155 HEAD RING D. 13	1	
KIT154	34015401	KIT 154 INTERM.RING D. 13	1	
KIT153	34015301	KIT 153 PACKING D.13	1	
KIT152	34015201	KIT 152 PACKING RETAINER D.13	1	
KIT124	34012401	KIT 124 VALVE CAPS	1	
KIT123	34012301	KIT 123 INTAKE/DELIVERY VALVE	1	
64	99191200	SCREW M 6x30 UNI 5931	4	
63	96693800	WASHER 6,4X10X0,7	4	
62	90169000	OIL SEAL D. 45X62X8	1	
61	10050422	FLANGE FOR EL.MOT.145-184TC(US	1	
60	96719500	WASHER 13X18X1,1	4	
59	99460000	SCREW 1/2-13X1-1/4"ANSI B18.2.	4	
59	90409700	O-RING 55,56X3,53 (159)	1	
58	91856800	NEEDLE BEARING DHK 4520	1	
56	44021665	CRANKSHAFT C.13(1-1/8" HOLLOW)	1	
55	90063500	CIRCLIP D. 25 UNI 7435	1	
54	53150022	SIDE CRANKCASE COVER	1	
53	90067100	CIRCLIP ZJ30	1	
52	90385900	O-RING 25,07X2,62 (3100)	1	
51	90260300	PACKING D.13X23X5,8 L.P.	3	
50	98196600	PLUG G1/8X8	1	
49	96751400	WASHER 21,5X27X1,5	1	
48	96738000	WASHER 17,5X23X1,5	1	
47	98217600	PLUG G1/2X10	1	
46	98210000	PLUG G3/8X13	1	
45	44100251	HEAD RING D. 13	3	
44	90260200	PACKING D.13X21X4 H.P.	3	
43	90507600	ANTI-EXTRUSION RING D.13X17X2	3	
42	44216270	INTERMEDIATE RING D. 13	3	
41	44080370	PACKING RETAINER D. 13	3	
40	90361200	O-RING 31,47X1,78 (2125)	3	
39	99303700	SCREW M 8x16-5739	4	
38	96701600	WASHER 8,4	4	
37	50200074	PUMP FOOT	2	

## Illustration Hollow shaft (key) Ø28,6 - vers. A

Pos.	Code	Description	Qty	Notes
33	58040009	PISTON D.13X42	3	
32	99169000	SCREW M05X55 SPEC. A2-70	3	
31	96690500	WASHER D.5X11.5x0.4 INOX+FKM58/59/63HT	3	
30	96699000	WASHER D.7.5X23X0.5	3	
29	97734000	CONNECTING-ROD PIN D.10X29,5	3	
28	98204250	PLUG G1/4"x12	1	
27	90358500	O-RING 10,82X1,78 (2043)	1	
26	99183700	SCREW M 6x14 UNI 5931	5	
25	44160022	REAR CRANKCASE COVER	1	
24	90392000	O-RING 101,27X2,62 (3400)	1	
23	44030022	CONNECTING ROD	3	
22	44050266	PISTON GUIDE M5	3	
19	98210300	OIL DIP-STICK G3/8X51	1	
18	44010022	CRANKCASE	1	
17	90161400	OIL SEAL 20x30x5	3	
16	91833100	BALL BEARING 6305 SKF	1	
15	90389800	O-RING 56,82X2,62 (3225)	1	
14	53210851	OIL LEVEL GAUGE	1	
12	99180700	SCREW M 6x12 UNI 5739	4	
11	36711501	INTAKE/DELIVERY VALVE	6	
10	98222600	VALVE CAP M24X1,5X17	6	
9	90384700	O-RING 20,29X2,62(3081)	6	
8	36202551	VALVE CAGE	6	
7	94737600	SPRING D. 9,4X14,8	6	
6	36200176	VALVE PLATE	6	
5	36200366	VALVE SEAT	6	
4	90384100	O-RING 17,12X2,62 (3068)	6	
2	99317500	SCREW M 8x60 UNI 5931	8	
1	44120641	BRASS HEAD (D. 13)	1	

# Illustration Hollow shaft (key) Ø25,4 - vers. C

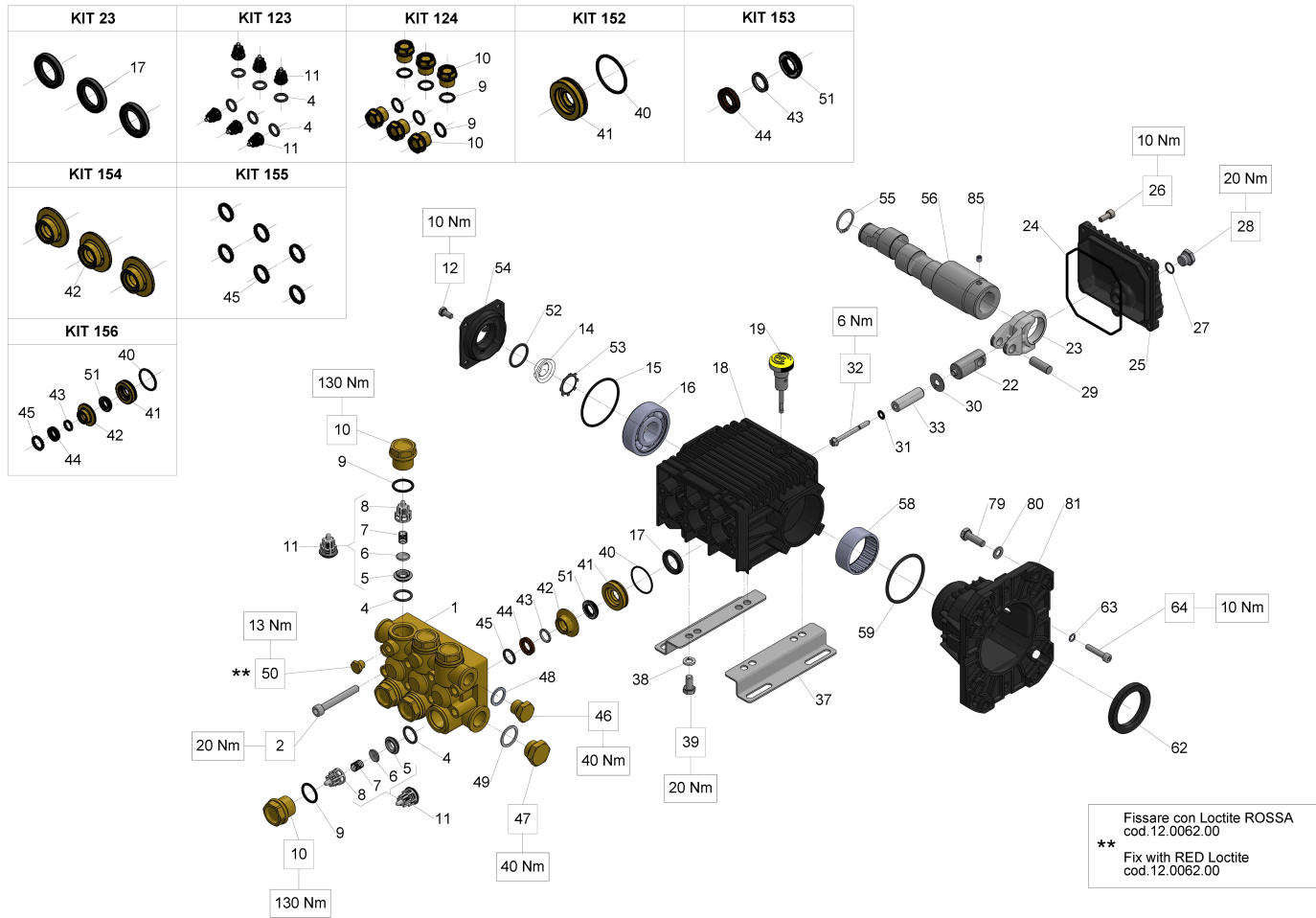

## Illustration Hollow shaft (key) Ø25,4 - vers. C

Pos.	Code	Description	Qty	Notes
KIT23	34002301	KIT 23 OIL SEAL D.20X30X5	1	
KIT156	34015601	KIT 156 CPL.SEAL FOR PIST.D13	1	
KIT155	34015501	KIT 155 HEAD RING D. 13	1	
KIT154	34015401	KIT 154 INTERM.RING D. 13	1	
KIT153	34015301	KIT 153 PACKING D.13	1	
KIT152	34015201	KIT 152 PACKING RETAINER D.13	1	
KIT124	34012401	KIT 124 VALVE CAPS	1	
KIT123	34012301	KIT 123 INTAKE/DELIVERY VALVE	1	
85	99179000	SCREW M6X6 UNI 5929 12.9	1	
81	10051822	FLANGE FOR PETROL ENGINE	1	
80	96702000	WASHER 8,4X15X1,5	4	
80	96710400	WASHER 10,5X16X1	4	
79	99275500	SCREW 5/16"-24X1" ANSI B18.2.1	4	
79	99334600	SCREW 3/8"-16X1-1/4"B18.2.1 G5	4	
64	99191200	SCREW M 6x30 UNI 5931	4	
63	96693800	WASHER 6,4X10X0,7	4	
62	90169000	OIL SEAL D. 45X62X8	1	
59	90409700	O-RING 55,56X3,53 (159)	1	
58	91856800	NEEDLE BEARING DHK 4520	1	
56	44022165	CRANKSHAFT C.13 (D.1" HOLLOW)	1	
55	90063500	CIRCLIP D. 25 UNI 7435	1	
54	53150022	SIDE CRANKCASE COVER	1	
53	90067100	CIRCLIP ZJ30	1	
52	90385900	O-RING 25,07X2,62 (3100)	1	
51	90260300	PACKING D.13X23X5,8 L.P.	3	
50	98196600	PLUG G1/8X8	1	
49	96751400	WASHER 21,5X27X1,5	1	
48	96738000	WASHER 17,5X23X1,5	1	
47	98217600	PLUG G1/2X10	1	
46	98210000	PLUG G3/8X13	1	
45	44100251	HEAD RING D. 13	3	
44	90260200	PACKING D.13X21X4 H.P.	3	
43	90507600	ANTI-EXTRUSION RING D.13X17X2	3	
42	44216270	INTERMEDIATE RING D. 13	3	
41	44080370	PACKING RETAINER D. 13	3	
40	90361200	O-RING 31,47X1,78 (2125)	3	

## Illustration Hollow shaft (key) Ø25,4 - vers. C

Pos.	Code	Description	Qty	Notes
39	99303700	SCREW M 8x16-5739	4	
38	96701600	WASHER 8,4	4	
37	50200074	PUMP FOOT	2	
33	58040009	PISTON D.13X42	3	
32	99169000	SCREW M05X55 SPEC. A2-70	3	
31	96690500	WASHER D.5X11.5x0.4 INOX+FKM58/59/63HT	3	
30	96699000	WASHER D.7.5X23X0.5	3	
29	97734000	CONNECTING-ROD PIN D.10X29,5	3	
28	98204250	PLUG G1/4"x12	1	
27	90358500	O-RING 10,82X1,78 (2043)	1	
26	99183700	SCREW M 6x14 UNI 5931	5	
25	44160022	REAR CRANKCASE COVER	1	
24	90392000	O-RING 101,27X2,62 (3400)	1	
23	44030022	CONNECTING ROD	3	
22	44050266	PISTON GUIDE M5	3	
19	98210300	OIL DIP-STICK G3/8X51	1	
18	44010022	CRANKCASE	1	
17	90161400	OIL SEAL 20x30x5	3	
16	91833100	BALL BEARING 6305 SKF	1	
15	90389800	O-RING 56,82X2,62 (3225)	1	
14	53210851	OIL LEVEL GAUGE	1	
12	99180700	SCREW M 6x12 UNI 5739	4	
11	36711501	INTAKE/DELIVERY VALVE	6	
10	98222600	VALVE CAP M24X1,5X17	6	
9	90384700	O-RING 20,29X2,62(3081)	6	
8	36202551	VALVE CAGE	6	
7	94737600	SPRING D. 9,4X14,8	6	
6	36200176	VALVE PLATE	6	
5	36200366	VALVE SEAT	6	
4	90384100	O-RING 17,12X2,62 (3068)	6	
2	99317500	SCREW M 8x60 UNI 5931	8	
1	44120641	BRASS HEAD (D. 13)	1	