



WK6



TECHNICAL INFORMATION

Flow (L/min)	62
Flow (US Gpm)	16,4
Rotation regime (rpm)	1000
Pressure (MPa)	10
Pressure (bar)	100
Pressure (psi)	1450
Power (hp)	16,1
Power (kW)	11,84
Overall dimensions L x l x h (mm)	405x340,5x253,5
Weight (kg)	35



Documents

Male shaft (key) - GAS

Male shaft (key) - NPT

Male shaft (key) - GAS + flange A - GAS

Hollow shaft (spline) + SAE B flange - GAS

Hollow shaft (spline) + SAE B flange - NPT

Hy-Pack version - GAS + gear motor 70cc

Hy-Pack version - GAS + piston motor 47cc

Hy-Pack version - GAS + gear motor 62cc

Hy-Pack version - GAS + piston motor 64cc

Hy-Pack versione - GAS + gear motor 48cc

Male shaft (key) - GAS - ATEX

Illustration Male shaft (key) - GAS

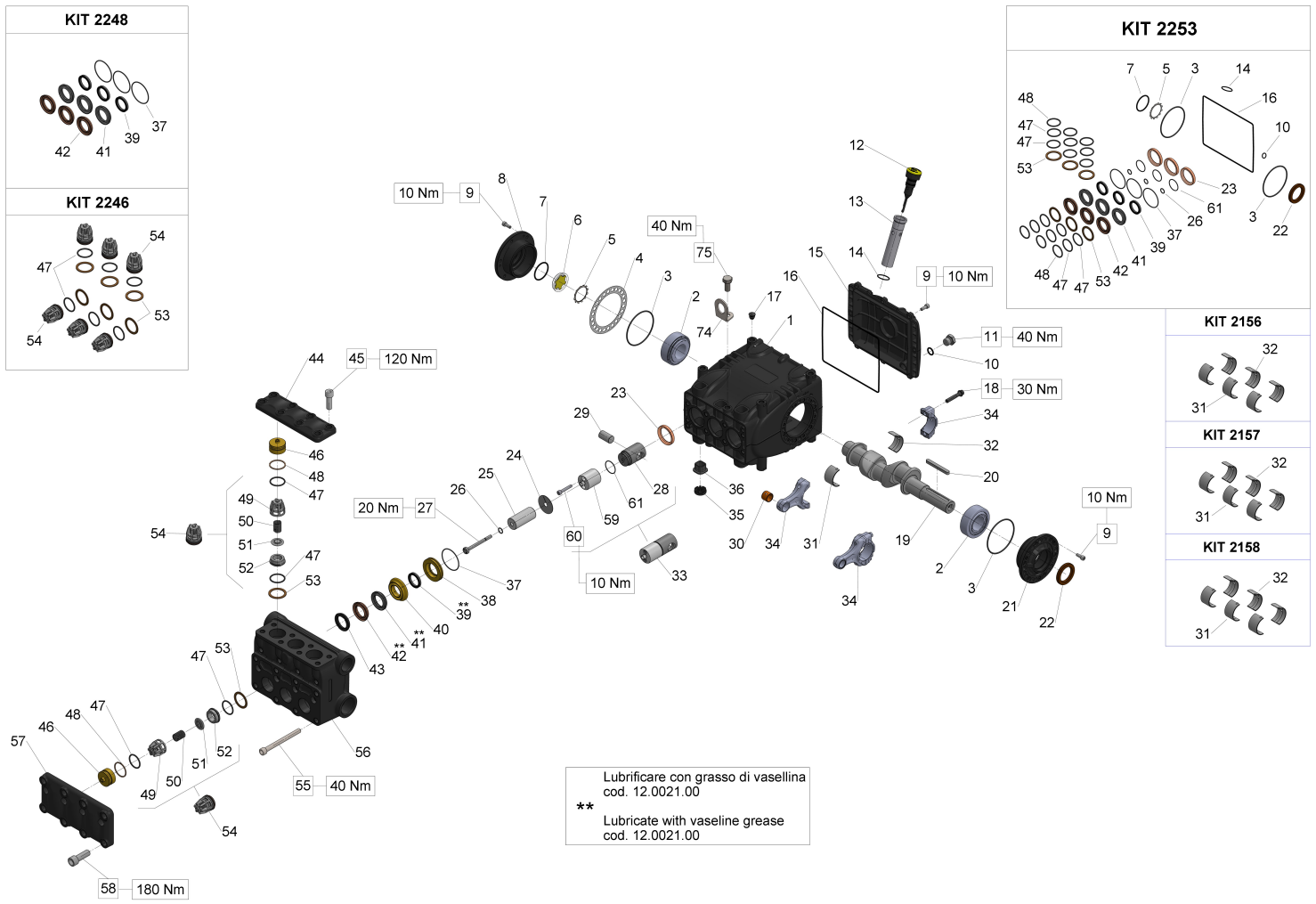

Illustration Male shaft (key) - GAS

Pos.	Code	Description	Qty	Notes
KIT2253	34225301	KIT 2253 CPL.SEAL D.32	1	
KIT2248	34224801	KIT 2248 PACKING D. 32	1	
KIT2246	34224601	KIT 2246 INTAKE/DELIVERY VALVE	1	
KIT2158	34215801	KIT 2158*CONROD BUSHINGS +0,50	1	
KIT2157	34215701	KIT 2157*CONROD BUSHINGS +0,25	1	
KIT2156	34215601	KIT 2156*CONROD BUSHING	1	
75	99426600	VITE TE M12X25-UNI5739 ZINC.	1	
74	71223074	STAFFA DI SOLLEVAMENTO	1	
61	90352800	O-RING D. 29.00x1.50 NBR 70SH 3		
60	99192500	SCREW M06X35 5931 A2-70	6	
59	70050266	PISTON GUIDE ROD	3	
58	99485000	SCREW M14X40 UNI5931 12.9 DACR.	8	
57	70225015	INLET VALVE COVER	KT 1	
56	70126615	MANIFOL FOR PISTON D.32	KT 1	S
55	99381600	SCREW M10X110 UNI5931 8.8	4	
54	36720801	INTAKE/DELIVERY VALVE KT SER.	6	
53	90517850	ANELLO ANTIEST. 31.0x40.0x1.7 (S.66)	6	
52	36204866	VALVE SEAT (70HT)	6	
51	36211766	SPHERICAL VALVE	6	
50	94745000	SPRING D. 16X27,5	6	
49	36204751	VALVE CAGE (70HT)	6	
48	90518000	ANTI-EXTR.RING D.32.4X36.5X1.5	6	
47	90386500	O-RING 29,82X2,62 (3118)	12	
46	70225370	VALVE PLUG	6	
45	99429500	SCREW M12X35 UNI5931 12.31 DACR.	8	
44	70225115	OUTLET VALVE COVER	KT 1	
43	72100051	HEAD RING D.32	3	
42	90278800	PACKING D.32X44	3	
41	90278400	RESTOP RING D. 32x44x5,5/3	3	
40	70225270	INTERMEDIATE RING D.32	3	
39	90278000	PACKING D.32x40x5,5 L.P	3	
38	70082270	PACKING RETAINER D.32	3	

Illustration Male shaft (key) - GAS

Pos.	Code	Description	Qty	Notes
37	90362600	O-RING D. 50,52X1,78 (2200)	3	
36	70222551	CRANKCASE PLUG	6	
35	71225951	PLUG CAP	3	
34	70030501	CONNECTING ROD COMPLETE	3	
33	70606801	PISTON GUIDE ASSY	3	
32	90922500	LOWER HALF CONROD BUSHING 3 +0.50 (BIG END) S.70	3	
32	90922400	LOWER HALF CONROD BUSHING 3 +0.25 (BIG END) S.70	3	
32	90922300	LOWER HALF CONROD BUSHING 3 (BIG END) S.70	3	
31	90922200	UPPER HALF CONROD BUSHING 3 +0.5 (BIG END) S.70	3	
31	90922100	UPPER HALF CONROD BUSHING 3 +0.25 (BIG END) S.70	3	
31	90922000	UPPER HALF CONROD BUSHING 3 (BIG END) S.70	3	
30	90910000	CONROD BUSHING (SMALL END) 3 S.70	3	
29	97742000	GUDGEON PIN D.18X36	3	
28	70050115	PISTON GUIDE T.N.	3	
27	70224136	PISTON BOLT	3	
26	90358400	O-RING D.10,82X1,78(2043)90SH3	3	
25	70041309	PISTON D. 32X63	3	
24	96709900	WASHER D.10X45	3	
23	90167700	OIL SEAL D.36X47X7	3	
22	90166800	OIL SEAL D.35X52X7	1	
21	70150022	BEARING COVER (PTO SIDE)	1	
20	91490000	KEY 8h9X7X70 UNI 6604/A	1	
19	70020635	CRANKSHAFT C.26	1	
18	99312300	CONN.ROD BOLT M8X1X42	6	
17	98200500	PLUG D. 15	5	
16	90394200	OR D.190.17X2.62 NBR 70SH	1	
15	70160622	CRANKCASE COVER KT	1	
14	90360400	O-RING 25,12X1,78 (2100)	1	
13	72210695	DIP STICK TUBE	1	
12	98211500	OIL DIPSTICK D.21,5X70	1	
11	98210050	PLUG G3/8x13 TE22	1	
10	90383300	O-RING 13,95X2,62 (3056)	1	

Illustration Male shaft (key) - GAS

Pos.	Code	Description	Qty	Notes
9	99185400	SCREW M6X16 UNI 5931 8.8 Z.	20	
8	70150122	BEARING COVER (OIL GLASS SIDE)	1	
7	90387700	O-RING 39,34X2,62 (3156)	1	
6	70211801	OIL SIGHT GLASS	1	
5	90075600	CIRCLIP D.45 (ZJ45)	1	
4	70220381	SHIM 0.25 MM.	1	
4	70220081	SHIM 0.1 MM.	1	
3	90391500	O-RING D. 80.6X2.62 (3318)	2	
2	91847700	TAPER ROLLER BEARING 33207/Q	2	
1	70010022	CRANKCASE	1	

Illustration Male shaft (key) - NPT

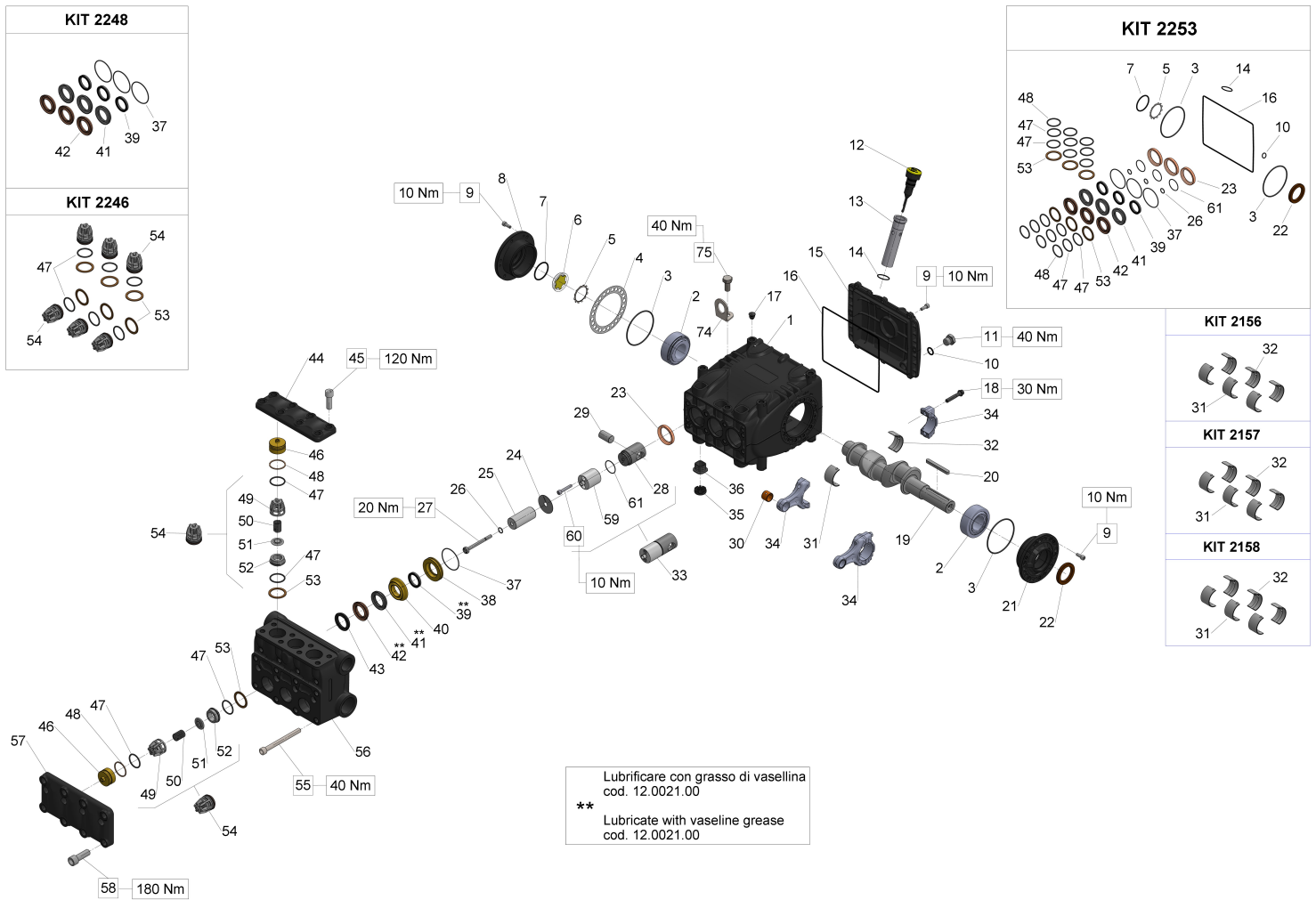

Illustration Male shaft (key) - NPT

Pos.	Code	Description	Qty	Notes
KIT2253	34225301	KIT 2253 CPL.SEAL D.32	1	
KIT2248	34224801	KIT 2248 PACKING D. 32	1	
KIT2246	34224601	KIT 2246 INTAKE/DELIVERY VALVE	1	
KIT2158	34215801	KIT 2158*CONROD BUSHINGS +0,50	1	
KIT2157	34215701	KIT 2157*CONROD BUSHINGS +0,25	1	
KIT2156	34215601	KIT 2156*CONROD BUSHING	1	
75	99426600	VITE TE M12X25-UNI5739 ZINC.	1	
74	71223074	STAFFA DI SOLLEVAMENTO	1	
61	90352800	O-RING D. 29.00x1.50 NBR 70SH 3		
60	99192500	SCREW M06X35 5931 A2-70	6	
59	70050266	PISTON GUIDE ROD	3	
58	99485000	SCREW M14X40 UNI5931 12.9 DACR.	8	
57	70225015	INLET VALVE COVER	KT 1	
56	70126915	MANIFOLD FOR PIST.D.32 NPT	1	
55	99381600	SCREW M10X110 UNI5931 8.8	4	
54	36720801	INTAKE/DELIVERY VALVE KT SER.	6	
53	90517850	ANELLO ANTIEST. 31.0x40.0x1.7 (S.66)	6	
52	36204866	VALVE SEAT (70HT)	6	
51	36211766	SPHERICAL VALVE	6	
50	94745000	SPRING D. 16X27,5	6	
49	36204751	VALVE CAGE (70HT)	6	
48	90518000	ANTI-EXTR.RING D.32.4X36.5X1.5	6	
47	90386500	O-RING 29,82X2,62 (3118)	12	
46	70225370	VALVE PLUG	6	
45	99429500	SCREW M12X35 UNI5931 12.31 DACR.	8	
44	70225115	OUTLET VALVE COVER	KT 1	
43	72100051	HEAD RING D.32	3	
42	90278800	PACKING D.32X44	3	
41	90278400	RESTOP RING D. 32x44x5,5/3	3	
40	70225270	INTERMEDIATE RING D.32	3	
39	90278000	PACKING D.32x40x5,5 L.P	3	
38	70082270	PACKING RETAINER D.32	3	

Illustration Male shaft (key) - NPT

Pos.	Code	Description	Qty	Notes
37	90362600	O-RING D. 50,52X1,78 (2200)	3	
36	70222551	CRANKCASE PLUG	6	
35	71225951	PLUG CAP	3	
34	70030501	CONNECTING ROD COMPLETE	3	
33	70606801	PISTON GUIDE ASSY	3	
32	90922500	LOWER HALF CONROD BUSHING 3 +0.50 (BIG END) S.70	3	
32	90922400	LOWER HALF CONROD BUSHING 3 +0.25 (BIG END) S.70	3	
32	90922300	LOWER HALF CONROD BUSHING 3 (BIG END) S.70	3	
31	90922200	UPPER HALF CONROD BUSHING 3 +0.5 (BIG END) S.70	3	
31	90922100	UPPER HALF CONROD BUSHING 3 +0.25 (BIG END) S.70	3	
31	90922000	UPPER HALF CONROD BUSHING 3 (BIG END) S.70	3	
30	90910000	CONROD BUSHING (SMALL END) 3 S.70	3	
29	97742000	GUDGEON PIN D.18X36	3	
28	70050115	PISTON GUIDE T.N.	3	
27	70224136	PISTON BOLT	3	
26	90358400	O-RING D.10,82X1,78(2043)90SH3	3	
25	70041309	PISTON D. 32X63	3	
24	96709900	WASHER D.10X45	3	
23	90167700	OIL SEAL D.36X47X7	3	
22	90166800	OIL SEAL D.35X52X7	1	
21	70150022	BEARING COVER (PTO SIDE)	1	
20	91490000	KEY 8h9X7X70 UNI 6604/A	1	
19	70020635	CRANKSHAFT C.26	1	
18	99312300	CONN.ROD BOLT M8X1X42	6	
17	98200500	PLUG D. 15	5	
16	90394200	OR D.190.17X2.62 NBR 70SH	1	
15	70160622	CRANKCASE COVER KT	1	
14	90360400	O-RING 25,12X1,78 (2100)	1	
13	72210695	DIP STICK TUBE	1	
12	98211500	OIL DIPSTICK D.21,5X70	1	
11	98210050	PLUG G3/8x13 TE22	1	
10	90383300	O-RING 13,95X2,62 (3056)	1	

Illustration Male shaft (key) - NPT

Pos.	Code	Description	Qty	Notes
9	99185400	SCREW M6X16 UNI 5931 8.8 Z.	20	
8	70150122	BEARING COVER (OIL GLASS SIDE)	1	
7	90387700	O-RING 39,34X2,62 (3156)	1	
6	70211801	OIL SIGHT GLASS	1	
5	90075600	CIRCLIP D.45 (ZJ45)	1	
4	70220381	SHIM 0.25 MM.	1	
4	70220081	SHIM 0.1 MM.	1	
3	90391500	O-RING D. 80.6X2.62 (3318)	2	
2	91847700	TAPER ROLLER BEARING 33207/Q	2	
1	70010022	CRANKCASE	1	
	~A0001076			

Illustration Male shaft (key) - GAS + flange A - GAS

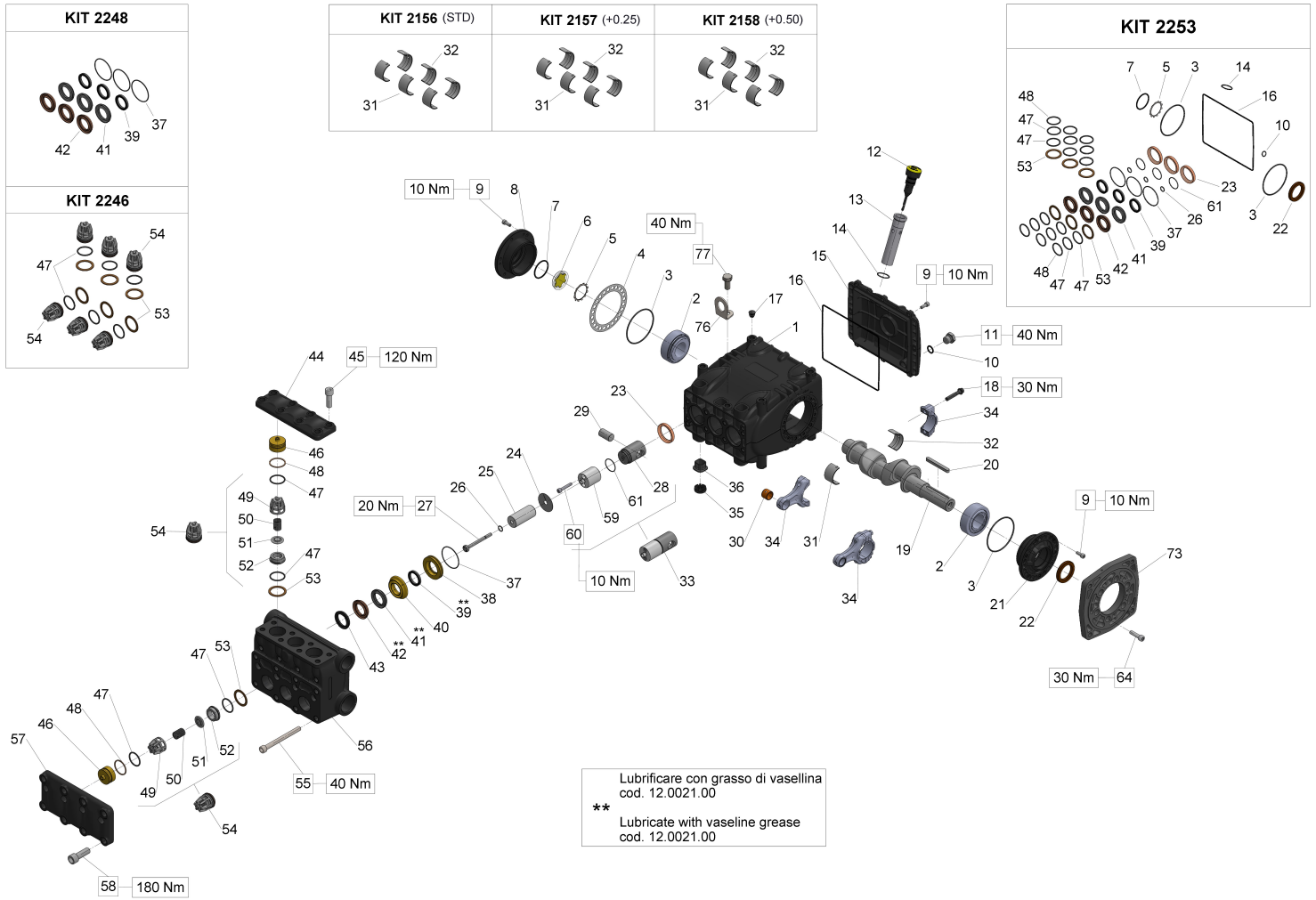

Illustration Male shaft (key) - GAS + flange A - GAS

Pos.	Code	Description	Qty	Notes
KIT2253	34225301	KIT 2253 CPL.SEAL D.32	1	
KIT2248	34224801	KIT 2248 PACKING D. 32	1	
KIT2246	34224601	KIT 2246 INTAKE/DELIVERY VALVE	1	
KIT2158	34215801	KIT 2158*CONROD BUSHINGS +0,50	1	
KIT2157	34215701	KIT 2157*CONROD BUSHINGS +0,25	1	
KIT2156	34215601	KIT 2156*CONROD BUSHING	1	
77	99426600	VITE TE M12X25-UNI5739 ZINC.	1	
76	71223074	STAFFA DI SOLLEVAMENTO	1	
73	10067320	FLANGE FOR HYDRAULIC MOTOR1 KE TYPE A		
64	99308400	SCREW M 8x30 UNI 5931	6	
61	90352800	O-RING D. 29.00x1.50 NBR 70SH 3		
60	99192500	SCREW M06X35 5931 A2-70	6	
59	70050266	PISTON GUIDE ROD	3	
58	99485000	SCREW M14X40 UNI5931 12.9 DACR.	8	
57	70225015	INLET VALVE COVER	KT 1	
56	70126615	MANIFOL FOR PISTON D.32	KT 1 S	
55	99381600	SCREW M10X110 UNI5931 8.8	4	
54	36720801	INTAKE/DELIVERY VALVE KT SER.	6	
53	90517850	ANELLO ANTIEST. 31.0x40.0x1.7 (S.66)	6	
52	36204866	VALVE SEAT (70HT)	6	
51	36211766	SPHERICAL VALVE	6	
50	94745000	SPRING D. 16X27,5	6	
49	36204751	VALVE CAGE (70HT)	6	
48	90518000	ANTI-EXTR.RING D.32.4X36.5X1.5	6	
47	90386500	O-RING 29,82X2,62 (3118)	12	
46	70225370	VALVE PLUG	6	
45	99429500	SCREW M12X35 UNI5931 12.31 DACR.	8	
44	70225115	OUTLET VALVE COVER	KT 1	
43	72100051	HEAD RING D.32	3	
42	90278800	PACKING D.32X44	3	
41	90278400	RESTOP RING D. 32x44x5,5/3	3	

Illustration Male shaft (key) - GAS + flange A - GAS

Pos.	Code	Description	Qty	Notes
40	70225270	INTERMEDIATE RING D.32	3	
39	90278000	PACKING D.32x40x5,5 L.P	3	
38	70082270	PACKING RETAINER D.32	3	
37	90362600	O-RING D. 50,52X1,78 (2200)	3	
36	70222551	CRANKCASE PLUG	6	
35	71225951	PLUG CAP	3	
34	70030501	CONNECTING ROD COMPLETE	3	
33	70606801	PISTON GUIDE ASSY	3	
32	90922500	LOWER HALF CONROD BUSHING 3 +0.50 (BIG END) S.70	3	
32	90922400	LOWER HALF CONROD BUSHING 3 +0.25 (BIG END) S.70	3	
32	90922300	LOWER HALF CONROD BUSHING 3 (BIG END) S.70	3	
31	90922200	UPPER HALF CONROD BUSHING 3 +0.5 (BIG END) S.70	3	
31	90922100	UPPER HALF CONROD BUSHING 3 +0.25 (BIG END) S.70	3	
31	90922000	UPPER HALF CONROD BUSHING 3 (BIG END) S.70	3	
30	90910000	CONROD BUSHING (SMALL END) 3 S.70	3	
29	97742000	GUDGEON PIN D.18X36	3	
28	70050115	PISTON GUIDE T.N.	3	
27	70224136	PISTON BOLT	3	
26	90358400	O-RING D.10,82X1,78(2043)90SH3	3	
25	70041309	PISTON D. 32X63	3	
24	96709900	WASHER D.10X45	3	
23	90167700	OIL SEAL D.36X47X7	3	
22	90166800	OIL SEAL D.35X52X7	1	
21	70150022	BEARING COVER (PTO SIDE)	1	
20	91490000	KEY 8h9X7X70 UNI 6604/A	1	
19	70020635	CRANKSHAFT C.26	1	
18	99312300	CONN.ROD BOLT M8X1X42	6	
17	98200500	PLUG D. 15	5	
16	90394200	OR D.190.17X2.62 NBR 70SH	1	
15	70160622	CRANKCASE COVER KT	1	
14	90360400	O-RING 25,12X1,78 (2100)	1	
13	72210695	DIP STICK TUBE	1	

Illustration Male shaft (key) - GAS + flange A - GAS

Pos.	Code	Description	Qty	Notes
12	98211500	OIL DIPSTICK D.21,5X70	1	
11	98210050	PLUG G3/8x13 TE22	1	
10	90383300	O-RING 13,95X2,62 (3056)	1	
9	99185400	SCREW M6X16 UNI 5931 8.8 Z.	20	
8	70150122	BEARING COVER (OIL GLASS SIDE)	1	
7	90387700	O-RING 39,34X2,62 (3156)	1	
6	70211801	OIL SIGHT GLASS	1	
5	90075600	CIRCLIP D.45 (ZJ45)	1	
4	70220381	SHIM 0.25 MM.	1	
4	70220081	SHIM 0.1 MM.	1	
3	90391500	O-RING D. 80.6X2.62 (3318)	2	
2	91847700	TAPER ROLLER BEARING 33207/Q	2	
1	70010022	CRANKCASE	1	
	~A0001077			

Illustration Hollow shaft (spline) + SAE B flange - GAS

Pos.	Code	Description	Qty	Notes
KIT2253	34225301	KIT 2253 CPL.SEAL D.32	1	
KIT2248	34224801	KIT 2248 PACKING D. 32	1	
KIT2246	34224601	KIT 2246 INTAKE/DELIVERY VALVE	1	
KIT2158	34215801	KIT 2158*CONROD BUSHINGS +0,50	1	
KIT2157	34215701	KIT 2157*CONROD BUSHINGS +0,25	1	
KIT2156	34215601	KIT 2156*CONROD BUSHING	1	
77	99426600	VITE TE M12X25-UNI5739 ZINC.	1	
76	71223074	STAFFA DI SOLLEVAMENTO	1	
75	10085322	FLANGE FOR HYDRAULIC MOTOR1 SAE-B S.70	1	
69	ZRPM1	ZRPM1	1	
68	90206500	PLUG FOR BORE D.17 - TTN19	1	
67	92202500	NUT M6 UNI 5588 6S	1	
66	70227034	VITE M6X12 CON INCAVO COMPLETA	1	
65	70226771	ANELLO PER ALBERO D.30 H.PACK	1	
64	99308400	SCREW M 8x30 UNI 5931	6	
61	90352800	O-RING D. 29.00x1.50 NBR 70SH 3	3	
60	99192500	SCREW M06X35 5931 A2-70	6	
59	70050266	PISTON GUIDE ROD	3	
58	99485000	SCREW M14X40 UNI5931 12.9 DACR.	8	
57	70225015	INLET VALVE COVER	KT 1	
56	70126615	MANIFOL FOR PISTON D.32 S	KT 1	
55	99381600	SCREW M10X110 UNI5931 8.8	4	
54	36720801	INTAKE/DELIVERY VALVE SER.	KT 6	
53	90517850	ANELLO ANTIEST. 31.0x40.0x1.7 (S.66)	6	
52	36204866	VALVE SEAT (70HT)	6	
51	36211766	SPHERICAL VALVE	6	
50	94745000	SPRING D. 16X27,5	6	
49	36204751	VALVE CAGE (70HT)	6	
48	90518000	ANTI-EXTR.RING D.32.4X36.5X1.5	6	
47	90386500	O-RING 29,82X2,62 (3118)	12	
46	70225370	VALVE PLUG	6	

Illustration Hollow shaft (spline) + SAE B flange - GAS

Pos.	Code	Description	Qty	Notes
45	99429500	SCREW M12X35 UNI5931 12.31 DACR.	8	
44	70225115	OUTLET VALVE COVER	KT 1	
43	72100051	HEAD RING D.32	3	
42	90278800	PACKING D.32X44	3	
41	90278400	RESTOP RING D. 32x44x5,5/3	3	
40	70225270	INTERMEDIATE RING D.32	3	
39	90278000	PACKING D.32x40x5,5 L.P	3	
38	70082270	PACKING RETAINER D.32	3	
37	90362600	O-RING D. 50,52X1,78 (2200)	3	
36	70222551	CRANKCASE PLUG	6	
35	71225951	PLUG CAP	3	
34	70030501	CONNECTING ROD COMPLETE	3	
33	70606801	PISTON GUIDE ASSY	3	
32	90922500	LOWER HALF CONROD BUSHING 3 +0.50 (BIG END) S.70	3	
32	90922400	LOWER HALF CONROD BUSHING 3 +0.25 (BIG END) S.70	3	
32	90922300	LOWER HALF CONROD BUSHING 3 (BIG END) S.70	3	
31	90922200	UPPER HALF CONROD BUSHING 3 +0.5 (BIG END) S.70	3	
31	90922100	UPPER HALF CONROD BUSHING 3 +0.25 (BIG END) S.70	3	
31	90922000	UPPER HALF CONROD BUSHING 3 (BIG END) S.70	3	
30	90910000	CONROD BUSHING (SMALL END) 3 S.70	3	
29	97742000	GUDGEON PIN D.18X36	3	
28	70050115	PISTON GUIDE T.N.	3	
27	70224136	PISTON BOLT	3	
26	90358400	O-RING D.10,82X1,78(2043)90SH3	3	
25	70041309	PISTON D. 32X63	3	
24	96709900	WASHER D.10X45	3	
23	90167700	OIL SEAL D.36X47X7	3	
22	90166800	OIL SEAL D.35X52X7	1	
21	70150022	BEARING COVER (PTO SIDE)	1	
19	70020935	CRANKSHAFT C.26 HYP SAE-B	1	
18	99312300	CONN.ROD BOLT M8X1X42	6	

Illustration Hollow shaft (spline) + SAE B flange - GAS

Pos.	Code	Description	Qty	Notes
17	98200500	PLUG D. 15	5	
16	90394200	OR D.190.17X2.62 NBR 70SH	1	
15	70160622	CRANKCASE COVER KT	1	
14	90360400	O-RING 25,12X1,78 (2100)	1	
13	72210695	DIP STICK TUBE	1	
12	98211500	OIL DIPSTICK D.21,5X70	1	
11	98210050	PLUG G3/8x13 TE22	1	
10	90383300	O-RING 13,95X2,62 (3056)	1	
9	99185400	SCREW M6X16 UNI 5931 8.8 Z.	20	
8	70150122	BEARING COVER (OIL GLASS SIDE)	1	
7	90387700	O-RING 39,34X2,62 (3156)	1	
6	70211801	OIL SIGHT GLASS	1	
5	90075600	CIRCLIP D.45 (ZJ45)	1	
4	70220381	SHIM 0.25 MM.	1	
4	70220081	SHIM 0.1 MM.	1	
3	90391500	O-RING D. 80.6X2.62 (3318)	2	
2	91847700	TAPER ROLLER BEARING 33207/Q	2	
1	70010022	CRANKCASE	1	

Illustration Hollow shaft (spline) + SAE B flange - NPT

Pos.	Code	Description	Qty	Notes
KIT2253	34225301	KIT 2253 CPL.SEAL D.32	1	
KIT2248	34224801	KIT 2248 PACKING D. 32	1	
KIT2246	34224601	KIT 2246 INTAKE/DELIVERY VALVE	1	
KIT2158	34215801	KIT 2158*CONROD BUSHINGS +0,50	1	
KIT2157	34215701	KIT 2157*CONROD BUSHINGS +0,25	1	
KIT2156	34215601	KIT 2156*CONROD BUSHING	1	
77	99426600	VITE TE M12X25-UNI5739 ZINC.	1	
76	71223074	STAFFA DI SOLLEVAMENTO	1	
75	10085322	FLANGE FOR HYDRAULIC MOTOR1 SAE-B S.70	1	
69	ZRPM1	ZRPM1	1	
68	90206500	PLUG FOR BORE D.17 - TTN19	1	
67	92202500	NUT M6 UNI 5588 6S	1	
66	70227034	VITE M6X12 CON INCAVO COMPLETA	1	
65	70226771	ANELLO PER ALBERO D.30 H.PACK	1	
64	99308400	SCREW M 8x30 UNI 5931	6	
61	90352800	O-RING D. 29.00x1.50 NBR 70SH 3	3	
60	99192500	SCREW M06X35 5931 A2-70	6	
59	70050266	PISTON GUIDE ROD	3	
58	99485000	SCREW M14X40 UNI5931 12.9 DACR.	8	
57	70225015	INLET VALVE COVER	KT 1	
56	70126915	MANIFOLD FOR PIST.D.32 NPT	1	
55	99381600	SCREW M10X110 UNI5931 8.8	4	
54	36720801	INTAKE/DELIVERY VALVE KT SER.	6	
53	90517850	ANELLO ANTIEST. 31.0x40.0x1.7 6 (S.66)	6	
52	36204866	VALVE SEAT (70HT)	6	
51	36211766	SPHERICAL VALVE	6	
50	94745000	SPRING D. 16X27,5	6	
49	36204751	VALVE CAGE (70HT)	6	
48	90518000	ANTI-EXTR.RING D.32.4X36.5X1.5	6	
47	90386500	O-RING 29,82X2,62 (3118)	12	
46	70225370	VALVE PLUG	6	

Illustration Hollow shaft (spline) + SAE B flange - NPT

Pos.	Code	Description	Qty	Notes
45	99429500	SCREW M12X35 UNI5931 12.31 DACR.	8	
44	70225115	OUTLET VALVE COVER	KT 1	
43	72100051	HEAD RING D.32	3	
42	90278800	PACKING D.32X44	3	
41	90278400	RESTOP RING D. 32x44x5,5/3	3	
40	70225270	INTERMEDIATE RING D.32	3	
39	90278000	PACKING D.32x40x5,5 L.P	3	
38	70082270	PACKING RETAINER D.32	3	
37	90362600	O-RING D. 50,52X1,78 (2200)	3	
36	70222551	CRANKCASE PLUG	6	
35	71225951	PLUG CAP	3	
34	70030501	CONNECTING ROD COMPLETE	3	
33	70606801	PISTON GUIDE ASSY	3	
32	90922500	LOWER HALF CONROD BUSHING 3 +0.50 (BIG END) S.70	3	
32	90922400	LOWER HALF CONROD BUSHING 3 +0.25 (BIG END) S.70	3	
32	90922300	LOWER HALF CONROD BUSHING 3 (BIG END) S.70	3	
31	90922200	UPPER HALF CONROD BUSHING 3 +0.5 (BIG END) S.70	3	
31	90922100	UPPER HALF CONROD BUSHING 3 +0.25 (BIG END) S.70	3	
31	90922000	UPPER HALF CONROD BUSHING 3 (BIG END) S.70	3	
30	90910000	CONROD BUSHING (SMALL END) 3 S.70	3	
29	97742000	GUDGEON PIN D.18X36	3	
28	70050115	PISTON GUIDE T.N.	3	
27	70224136	PISTON BOLT	3	
26	90358400	O-RING D.10,82X1,78(2043)90SH3	3	
25	70041309	PISTON D. 32X63	3	
24	96709900	WASHER D.10X45	3	
23	90167700	OIL SEAL D.36X47X7	3	
22	90166800	OIL SEAL D.35X52X7	1	
21	70150022	BEARING COVER (PTO SIDE)	1	
19	70020935	CRANKSHAFT C.26 HYP SAE-B	1	
18	99312300	CONN.ROD BOLT M8X1X42	6	

Illustration Hollow shaft (spline) + SAE B flange - NPT

Pos.	Code	Description	Qty	Notes
17	98200500	PLUG D. 15	5	
16	90394200	OR D.190.17X2.62 NBR 70SH	1	
15	70160622	CRANKCASE COVER KT	1	
14	90360400	O-RING 25,12X1,78 (2100)	1	
13	72210695	DIP STICK TUBE	1	
12	98211500	OIL DIPSTICK D.21,5X70	1	
11	98210050	PLUG G3/8x13 TE22	1	
10	90383300	O-RING 13,95X2,62 (3056)	1	
9	99185400	SCREW M6X16 UNI 5931 8.8 Z.	20	
8	70150122	BEARING COVER (OIL GLASS SIDE)	1	
7	90387700	O-RING 39,34X2,62 (3156)	1	
6	70211801	OIL SIGHT GLASS	1	
5	90075600	CIRCLIP D.45 (ZJ45)	1	
4	70220381	SHIM 0.25 MM.	1	
4	70220081	SHIM 0.1 MM.	1	
3	90391500	O-RING D. 80.6X2.62 (3318)	2	
2	91847700	TAPER ROLLER BEARING 33207/Q	2	
1	70010022	CRANKCASE	1	
	~A0001078			

Illustration Hy-Pack version - GAS + gear motor 70cc

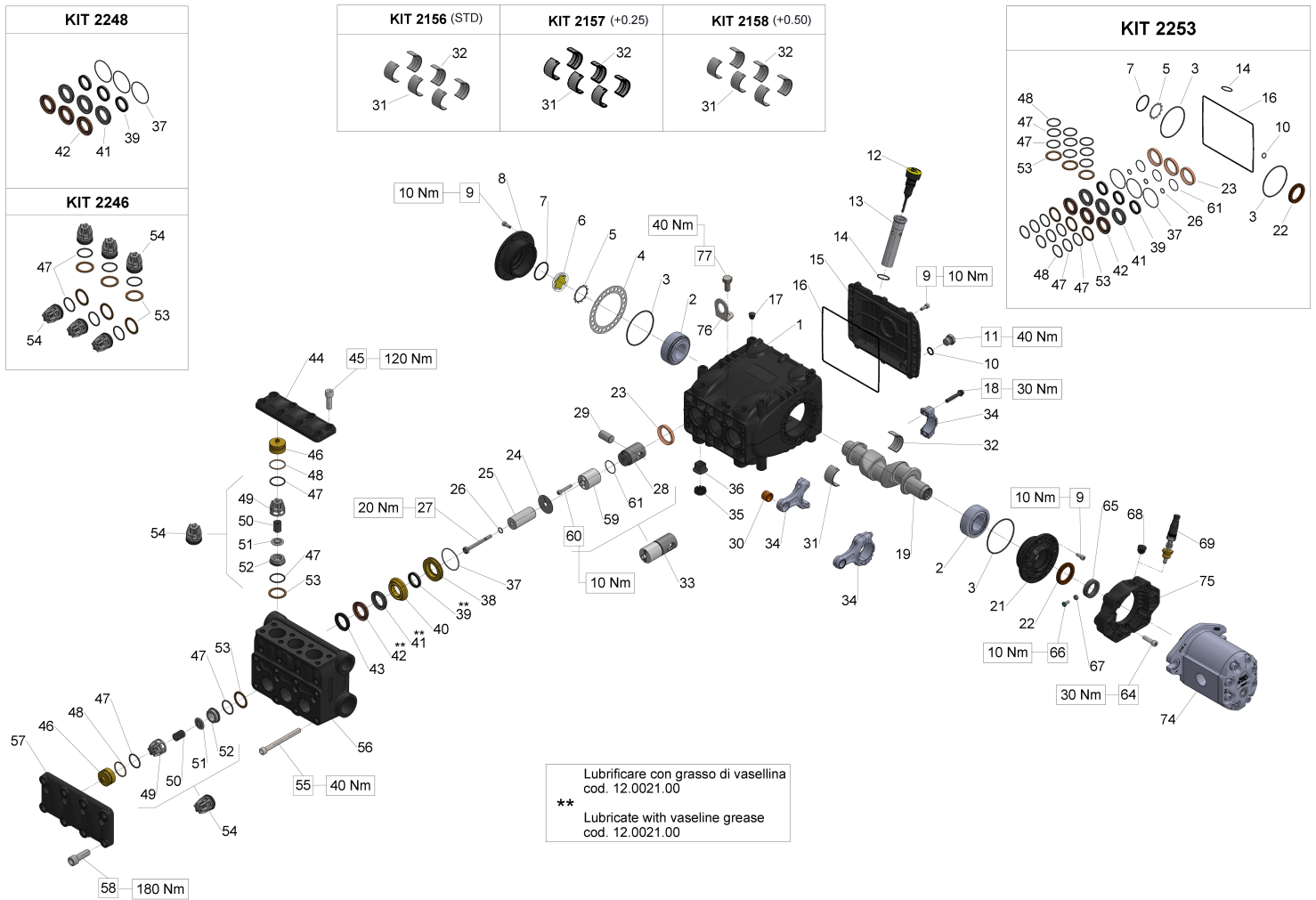

Illustration Hy-Pack version - GAS + gear motor 70cc

Pos.	Code	Description	Qty	Notes
KIT2253	34225301	KIT 2253 CPL.SEAL D.32	1	
KIT2248	34224801	KIT 2248 PACKING D. 32	1	
KIT2246	34224601	KIT 2246 INTAKE/DELIVERY VALVE	1	
KIT2158	34215801	KIT 2158*CONROD BUSHINGS +0,50	1	
KIT2157	34215701	KIT 2157*CONROD BUSHINGS +0,25	1	
KIT2156	34215601	KIT 2156*CONROD BUSHING	1	
77	99426600	VITE TE M12X25-UNI5739 ZINC.	1	
76	71223074	STAFFA DI SOLLEVAMENTO	1	
75	10085322	FLANGE FOR HYDRAULIC MOTOR1 SAE-B S.70	1	
74	95118000	MOTORE INGR. 070R / S-B SCA / 1 G	1	
69	ZRPM1	ZRPM1	1	
68	90206500	PLUG FOR BORE D.17 - TTN19	1	
67	92202500	NUT M6 UNI 5588 6S	1	
66	70227034	VITE M6X12 CON INCAVO COMPLETA	1	
65	70226771	ANELLO PER ALBERO D.30 H.PACK	1	
64	99308400	SCREW M 8x30 UNI 5931	6	
61	90352800	O-RING D. 29.00x1.50 NBR 70SH 3	3	
60	99192500	SCREW M06X35 5931 A2-70	6	
59	70050266	PISTON GUIDE ROD	3	
58	99485000	SCREW M14X40 UNI5931 12.9 DACR.	8	
57	70225015	INLET VALVE COVER	KT 1	
56	70126615	MANIFOL FOR PISTON D.32 S	KT 1	
55	99381600	SCREW M10X110 UNI5931 8.8	4	
54	36720801	INTAKE/DELIVERY VALVE KT SER.	6	
53	90517850	ANELLO ANTIEST. 31.0x40.0x1.7 6 (S.66)	6	
52	36204866	VALVE SEAT (70HT)	6	
51	36211766	SPHERICAL VALVE	6	
50	94745000	SPRING D. 16X27,5	6	
49	36204751	VALVE CAGE (70HT)	6	
48	90518000	ANTI-EXTR.RING D.32.4X36.5X1.5	6	
47	90386500	O-RING 29,82X2,62 (3118)	12	

Illustration Hy-Pack version - GAS + gear motor 70cc

Pos.	Code	Description	Qty	Notes
46	70225370	VALVE PLUG	6	
45	99429500	SCREW M12X35 UNI5931 12.31 DACR.	8	
44	70225115	OUTLET VALVE COVER	KT 1	
43	72100051	HEAD RING D.32	3	
42	90278800	PACKING D.32X44	3	
41	90278400	RESTOP RING D. 32x44x5,5/3	3	
40	70225270	INTERMEDIATE RING D.32	3	
39	90278000	PACKING D.32x40x5,5 L.P	3	
38	70082270	PACKING RETAINER D.32	3	
37	90362600	O-RING D. 50,52X1,78 (2200)	3	
36	70222551	CRANKCASE PLUG	6	
35	71225951	PLUG CAP	3	
34	70030501	CONNECTING ROD COMPLETE	3	
33	70606801	PISTON GUIDE ASSY	3	
32	90922500	LOWER HALF CONROD BUSHING 3 +0.50 (BIG END) S.70	3	
32	90922400	LOWER HALF CONROD BUSHING 3 +0.25 (BIG END) S.70	3	
32	90922300	LOWER HALF CONROD BUSHING 3 (BIG END) S.70	3	
31	90922200	UPPER HALF CONROD BUSHING 3 +0.5 (BIG END) S.70	3	
31	90922100	UPPER HALF CONROD BUSHING 3 +0.25 (BIG END) S.70	3	
31	90922000	UPPER HALF CONROD BUSHING 3 (BIG END) S.70	3	
30	90910000	CONROD BUSHING (SMALL END) 3 S.70	3	
29	97742000	GUDGEON PIN D.18X36	3	
28	70050115	PISTON GUIDE T.N.	3	
27	70224136	PISTON BOLT	3	
26	90358400	O-RING D.10,82X1,78(2043)90SH3		
25	70041309	PISTON D. 32X63	3	
24	96709900	WASHER D.10X45	3	
23	90167700	OIL SEAL D.36X47X7	3	
22	90166800	OIL SEAL D.35X52X7	1	
21	70150022	BEARING COVER (PTO SIDE)	1	
19	70020935	CRANKSHAFT C.26 HYP SAE-B	1	

Illustration Hy-Pack version - GAS + gear motor 70cc

Pos.	Code	Description	Qty	Notes
18	99312300	CONN.ROD BOLT M8X1X42	6	
17	98200500	PLUG D. 15	5	
16	90394200	OR D.190.17X2.62 NBR 70SH	1	
15	70160622	CRANKCASE COVER KT	1	
14	90360400	O-RING 25,12X1,78 (2100)	1	
13	72210695	DIP STICK TUBE	1	
12	98211500	OIL DIPSTICK D.21,5X70	1	
11	98210050	PLUG G3/8x13 TE22	1	
10	90383300	O-RING 13,95X2,62 (3056)	1	
9	99185400	SCREW M6X16 UNI 5931 8.8 Z.	20	
8	70150122	BEARING COVER (OIL GLASS SIDE)	1	
7	90387700	O-RING 39,34X2,62 (3156)	1	
6	70211801	OIL SIGHT GLASS	1	
5	90075600	CIRCLIP D.45 (ZJ45)	1	
4	70220381	SHIM 0.25 MM.	1	
4	70220081	SHIM 0.1 MM.	1	
3	90391500	O-RING D. 80.6X2.62 (3318)	2	
2	91847700	TAPER ROLLER BEARING 33207/Q	2	
1	70010022	CRANKCASE	1	

~A0001083

Illustration Hy-Pack version - GAS + piston motor 47cc

Pos.	Code	Description	Qty	Notes
KIT2253	34225301	KIT 2253 CPL.SEAL D.32	1	
KIT2248	34224801	KIT 2248 PACKING D. 32	1	
KIT2246	34224601	KIT 2246 INTAKE/DELIVERY VALVE	1	
KIT2158	34215801	KIT 2158*CONROD BUSHINGS +0,50	1	
KIT2157	34215701	KIT 2157*CONROD BUSHINGS +0,25	1	
KIT2156	34215601	KIT 2156*CONROD BUSHING	1	
77	99426600	VITE TE M12X25-UNI5739 ZINC.	1	
76	71223074	STAFFA DI SOLLEVAMENTO	1	
75	10085322	FLANGE FOR HYDRAULIC MOTOR1 SAE-B S.70	1	
74	95150000	MOTORE PIST. 047R / S-B SCA / 1 G	1	
69	ZRPM1	ZRPM1	1	
68	90206500	PLUG FOR BORE D.17 - TTN19	1	
67	92202500	NUT M6 UNI 5588 6S	1	
66	70227034	VITE M6X12 CON INCAVO COMPLETA	1	
65	70226771	ANELLO PER ALBERO D.30 H.PACK	1	
64	99308400	SCREW M 8x30 UNI 5931	6	
61	90352800	O-RING D. 29.00x1.50 NBR 70SH 3	3	
60	99192500	SCREW M06X35 5931 A2-70	6	
59	70050266	PISTON GUIDE ROD	3	
58	99485000	SCREW M14X40 UNI5931 12.9 DACR.	8	
57	70225015	INLET VALVE COVER	KT 1	
56	70126615	MANIFOL FOR PISTON D.32	KT 1 S	
55	99381600	SCREW M10X110 UNI5931 8.8	4	
54	36720801	INTAKE/DELIVERY VALVE KT SER.	6	
53	90517850	ANELLO ANTIEST. 31.0x40.0x1.7 6 (S.66)	6	
52	36204866	VALVE SEAT (70HT)	6	
51	36211766	SPHERICAL VALVE	6	
50	94745000	SPRING D. 16X27,5	6	
49	36204751	VALVE CAGE (70HT)	6	
48	90518000	ANTI-EXTR.RING D.32.4X36.5X1.5	6	
47	90386500	O-RING 29,82X2,62 (3118)	12	

Illustration Hy-Pack version - GAS + piston motor 47cc

Pos.	Code	Description	Qty	Notes
46	70225370	VALVE PLUG	6	
45	99429500	SCREW M12X35 UNI5931 12.31 DACR.	8	
44	70225115	OUTLET VALVE COVER	KT 1	
43	72100051	HEAD RING D.32	3	
42	90278800	PACKING D.32X44	3	
41	90278400	RESTOP RING D. 32x44x5,5/3	3	
40	70225270	INTERMEDIATE RING D.32	3	
39	90278000	PACKING D.32x40x5,5 L.P	3	
38	70082270	PACKING RETAINER D.32	3	
37	90362600	O-RING D. 50,52X1,78 (2200)	3	
36	70222551	CRANKCASE PLUG	6	
35	71225951	PLUG CAP	3	
34	70030501	CONNECTING ROD COMPLETE	3	
33	70606801	PISTON GUIDE ASSY	3	
32	90922500	LOWER HALF CONROD BUSHING 3 +0.50 (BIG END) S.70	3	
32	90922400	LOWER HALF CONROD BUSHING 3 +0.25 (BIG END) S.70	3	
32	90922300	LOWER HALF CONROD BUSHING 3 (BIG END) S.70	3	
31	90922200	UPPER HALF CONROD BUSHING 3 +0.5 (BIG END) S.70	3	
31	90922100	UPPER HALF CONROD BUSHING 3 +0.25 (BIG END) S.70	3	
31	90922000	UPPER HALF CONROD BUSHING 3 (BIG END) S.70	3	
30	90910000	CONROD BUSHING (SMALL END) 3 S.70	3	
29	97742000	GUDGEON PIN D.18X36	3	
28	70050115	PISTON GUIDE T.N.	3	
27	70224136	PISTON BOLT	3	
26	90358400	O-RING D.10,82X1,78(2043)90SH3		
25	70041309	PISTON D. 32X63	3	
24	96709900	WASHER D.10X45	3	
23	90167700	OIL SEAL D.36X47X7	3	
22	90166800	OIL SEAL D.35X52X7	1	
21	70150022	BEARING COVER (PTO SIDE)	1	
19	70020935	CRANKSHAFT C.26 HYP SAE-B	1	

Illustration Hy-Pack version - GAS + piston motor 47cc

Pos.	Code	Description	Qty	Notes
18	99312300	CONN.ROD BOLT M8X1X42	6	
17	98200500	PLUG D. 15	5	
16	90394200	OR D.190.17X2.62 NBR 70SH	1	
15	70160622	CRANKCASE COVER KT	1	
14	90360400	O-RING 25,12X1,78 (2100)	1	
13	72210695	DIP STICK TUBE	1	
12	98211500	OIL DIPSTICK D.21,5X70	1	
11	98210050	PLUG G3/8x13 TE22	1	
10	90383300	O-RING 13,95X2,62 (3056)	1	
9	99185400	SCREW M6X16 UNI 5931 8.8 Z.	20	
8	70150122	BEARING COVER (OIL GLASS SIDE)	1	
7	90387700	O-RING 39,34X2,62 (3156)	1	
6	70211801	OIL SIGHT GLASS	1	
5	90075600	CIRCLIP D.45 (ZJ45)	1	
4	70220381	SHIM 0.25 MM.	1	
4	70220081	SHIM 0.1 MM.	1	
3	90391500	O-RING D. 80.6X2.62 (3318)	2	
2	91847700	TAPER ROLLER BEARING 33207/Q	2	
1	70010022	CRANKCASE	1	
	~A0001081			

Illustration Hy-Pack version - GAS + gear motor 62cc

Pos.	Code	Description	Qty	Notes
KIT2253	34225301	KIT 2253 CPL.SEAL D.32	1	
KIT2248	34224801	KIT 2248 PACKING D. 32	1	
KIT2246	34224601	KIT 2246 INTAKE/DELIVERY VALVE	1	
KIT2158	34215801	KIT 2158*CONROD BUSHINGS +0,50	1	
KIT2157	34215701	KIT 2157*CONROD BUSHINGS +0,25	1	
KIT2156	34215601	KIT 2156*CONROD BUSHING	1	
77	99426600	VITE TE M12X25-UNI5739 ZINC.	1	
76	71223074	STAFFA DI SOLLEVAMENTO	1	
75	10085322	FLANGE FOR HYDRAULIC MOTOR1 SAE-B S.70		
74	95116000	GEAR MOTOR 062R / S-B SCA / G1		
69	ZRPM1	ZRPM1	1	
68	90206500	PLUG FOR BORE D.17 - TTN19	1	
67	92202500	NUT M6 UNI 5588 6S	1	
66	70227034	VITE M6X12 CON INCAVO COMPLETA	1	
65	70226771	ANELLO PER ALBERO D.30 H.PACK	1	
64	99308400	SCREW M 8x30 UNI 5931	6	
61	90352800	O-RING D. 29.00x1.50 NBR 70SH 3		
60	99192500	SCREW M06X35 5931 A2-70	6	
59	70050266	PISTON GUIDE ROD	3	
58	99485000	SCREW M14X40 UNI5931 12.9 DACR.	8	
57	70225015	INLET VALVE COVER	KT 1	
56	70126615	MANIFOL FOR PISTON D.32 S	KT 1	
55	99381600	SCREW M10X110 UNI5931 8.8	4	
54	36720801	INTAKE/DELIVERY VALVE KT SER.	6	
53	90517850	ANELLO ANTIEST. 31.0x40.0x1.7 (S.66)	6	
52	36204866	VALVE SEAT (70HT)	6	
51	36211766	SPHERICAL VALVE	6	
50	94745000	SPRING D. 16X27,5	6	
49	36204751	VALVE CAGE (70HT)	6	
48	90518000	ANTI-EXTR.RING D.32.4X36.5X1.5	6	
47	90386500	O-RING 29,82X2,62 (3118)	12	

Illustration Hy-Pack version - GAS + gear motor 62cc

Pos.	Code	Description	Qty	Notes
46	70225370	VALVE PLUG	6	
45	99429500	SCREW M12X35 UNI5931 12.31 DACR.	8	
44	70225115	OUTLET VALVE COVER	KT 1	
43	72100051	HEAD RING D.32	3	
42	90278800	PACKING D.32X44	3	
41	90278400	RESTOP RING D. 32x44x5,5/3	3	
40	70225270	INTERMEDIATE RING D.32	3	
39	90278000	PACKING D.32x40x5,5 L.P	3	
38	70082270	PACKING RETAINER D.32	3	
37	90362600	O-RING D. 50,52X1,78 (2200)	3	
36	70222551	CRANKCASE PLUG	6	
35	71225951	PLUG CAP	3	
34	70030501	CONNECTING ROD COMPLETE	3	
33	70606801	PISTON GUIDE ASSY	3	
32	90922500	LOWER HALF CONROD BUSHING 3 +0.50 (BIG END) S.70	3	
32	90922400	LOWER HALF CONROD BUSHING 3 +0.25 (BIG END) S.70	3	
32	90922300	LOWER HALF CONROD BUSHING 3 (BIG END) S.70	3	
31	90922200	UPPER HALF CONROD BUSHING 3 +0.5 (BIG END) S.70	3	
31	90922100	UPPER HALF CONROD BUSHING 3 +0.25 (BIG END) S.70	3	
31	90922000	UPPER HALF CONROD BUSHING 3 (BIG END) S.70	3	
30	90910000	CONROD BUSHING (SMALL END) 3 S.70	3	
29	97742000	GUDGEON PIN D.18X36	3	
28	70050115	PISTON GUIDE T.N.	3	
27	70224136	PISTON BOLT	3	
26	90358400	O-RING D.10,82X1,78(2043)90SH3		
25	70041309	PISTON D. 32X63	3	
24	96709900	WASHER D.10X45	3	
23	90167700	OIL SEAL D.36X47X7	3	
22	90166800	OIL SEAL D.35X52X7	1	
21	70150022	BEARING COVER (PTO SIDE)	1	
19	70020935	CRANKSHAFT C.26 HYP SAE-B	1	

Illustration Hy-Pack version - GAS + gear motor 62cc

Pos.	Code	Description	Qty	Notes
18	99312300	CONN.ROD BOLT M8X1X42	6	
17	98200500	PLUG D. 15	5	
16	90394200	OR D.190.17X2.62 NBR 70SH	1	
15	70160622	CRANKCASE COVER KT	1	
14	90360400	O-RING 25,12X1,78 (2100)	1	
13	72210695	DIP STICK TUBE	1	
12	98211500	OIL DIPSTICK D.21,5X70	1	
11	98210050	PLUG G3/8x13 TE22	1	
10	90383300	O-RING 13,95X2,62 (3056)	1	
9	99185400	SCREW M6X16 UNI 5931 8.8 Z.	20	
8	70150122	BEARING COVER (OIL GLASS SIDE)	1	
7	90387700	O-RING 39,34X2,62 (3156)	1	
6	70211801	OIL SIGHT GLASS	1	
5	90075600	CIRCLIP D.45 (ZJ45)	1	
4	70220381	SHIM 0.25 MM.	1	
4	70220081	SHIM 0.1 MM.	1	
3	90391500	O-RING D. 80.6X2.62 (3318)	2	
2	91847700	TAPER ROLLER BEARING 33207/Q	2	
1	70010022	CRANKCASE	1	

~A0001082

Illustration Hy-Pack version - GAS + piston motor 64cc

Pos.	Code	Description	Qty	Notes
KIT2253	34225301	KIT 2253 CPL.SEAL D.32	1	
KIT2248	34224801	KIT 2248 PACKING D. 32	1	
KIT2246	34224601	KIT 2246 INTAKE/DELIVERY VALVE	1	
KIT2158	34215801	KIT 2158*CONROD BUSHINGS +0,50	1	
KIT2157	34215701	KIT 2157*CONROD BUSHINGS +0,25	1	
KIT2156	34215601	KIT 2156*CONROD BUSHING	1	
77	99426600	VITE TE M12X25-UNI5739 ZINC.	1	
76	71223074	STAFFA DI SOLLEVAMENTO	1	
75	10085322	FLANGE FOR HYDRAULIC MOTOR1 SAE-B S.70	1	
74	95152150	PISTON MOTOR 064R / S-B SCA 1 / G	1	
69	ZRPM1	ZRPM1	1	
68	90206500	PLUG FOR BORE D.17 - TTN19	1	
67	92202500	NUT M6 UNI 5588 6S	1	
66	70227034	VITE M6X12 CON INCAVO COMPLETA	1	
65	70226771	ANELLO PER ALBERO D.30 H.PACK	1	
64	99308400	SCREW M 8x30 UNI 5931	6	
61	90352800	O-RING D. 29.00x1.50 NBR 70SH 3	3	
60	99192500	SCREW M06X35 5931 A2-70	6	
59	70050266	PISTON GUIDE ROD	3	
58	99485000	SCREW M14X40 UNI5931 12.9 DACR.	8	
57	70225015	INLET VALVE COVER	KT 1	
56	70126615	MANIFOL FOR PISTON D.32	KT 1 S	
55	99381600	SCREW M10X110 UNI5931 8.8	4	
54	36720801	INTAKE/DELIVERY VALVE KT SER.	6	
53	90517850	ANELLO ANTIEST. 31.0x40.0x1.7 6 (S.66)	6	
52	36204866	VALVE SEAT (70HT)	6	
51	36211766	SPHERICAL VALVE	6	
50	94745000	SPRING D. 16X27,5	6	
49	36204751	VALVE CAGE (70HT)	6	
48	90518000	ANTI-EXTR.RING D.32.4X36.5X1.5	6	
47	90386500	O-RING 29,82X2,62 (3118)	12	

Illustration Hy-Pack version - GAS + piston motor 64cc

Pos.	Code	Description	Qty	Notes
46	70225370	VALVE PLUG	6	
45	99429500	SCREW M12X35 UNI5931 12.31 DACR.	8	
44	70225115	OUTLET VALVE COVER	KT 1	
43	72100051	HEAD RING D.32	3	
42	90278800	PACKING D.32X44	3	
41	90278400	RESTOP RING D. 32x44x5,5/3	3	
40	70225270	INTERMEDIATE RING D.32	3	
39	90278000	PACKING D.32x40x5,5 L.P	3	
38	70082270	PACKING RETAINER D.32	3	
37	90362600	O-RING D. 50,52X1,78 (2200)	3	
36	70222551	CRANKCASE PLUG	6	
35	71225951	PLUG CAP	3	
34	70030501	CONNECTING ROD COMPLETE	3	
33	70606801	PISTON GUIDE ASSY	3	
32	90922500	LOWER HALF CONROD BUSHING 3 +0.50 (BIG END) S.70	3	
32	90922400	LOWER HALF CONROD BUSHING 3 +0.25 (BIG END) S.70	3	
32	90922300	LOWER HALF CONROD BUSHING 3 (BIG END) S.70	3	
31	90922200	UPPER HALF CONROD BUSHING 3 +0.5 (BIG END) S.70	3	
31	90922100	UPPER HALF CONROD BUSHING 3 +0.25 (BIG END) S.70	3	
31	90922000	UPPER HALF CONROD BUSHING 3 (BIG END) S.70	3	
30	90910000	CONROD BUSHING (SMALL END) 3 S.70	3	
29	97742000	GUDGEON PIN D.18X36	3	
28	70050115	PISTON GUIDE T.N.	3	
27	70224136	PISTON BOLT	3	
26	90358400	O-RING D.10,82X1,78(2043)90SH3		
25	70041309	PISTON D. 32X63	3	
24	96709900	WASHER D.10X45	3	
23	90167700	OIL SEAL D.36X47X7	3	
22	90166800	OIL SEAL D.35X52X7	1	
21	70150022	BEARING COVER (PTO SIDE)	1	
19	70020935	CRANKSHAFT C.26 HYP SAE-B	1	

Illustration Hy-Pack version - GAS + piston motor 64cc

Pos.	Code	Description	Qty	Notes
18	99312300	CONN.ROD BOLT M8X1X42	6	
17	98200500	PLUG D. 15	5	
16	90394200	OR D.190.17X2.62 NBR 70SH	1	
15	70160622	CRANKCASE COVER KT	1	
14	90360400	O-RING 25,12X1,78 (2100)	1	
13	72210695	DIP STICK TUBE	1	
12	98211500	OIL DIPSTICK D.21,5X70	1	
11	98210050	PLUG G3/8x13 TE22	1	
10	90383300	O-RING 13,95X2,62 (3056)	1	
9	99185400	SCREW M6X16 UNI 5931 8.8 Z.	20	
8	70150122	BEARING COVER (OIL GLASS SIDE)	1	
7	90387700	O-RING 39,34X2,62 (3156)	1	
6	70211801	OIL SIGHT GLASS	1	
5	90075600	CIRCLIP D.45 (ZJ45)	1	
4	70220381	SHIM 0.25 MM.	1	
4	70220081	SHIM 0.1 MM.	1	
3	90391500	O-RING D. 80.6X2.62 (3318)	2	
2	91847700	TAPER ROLLER BEARING 33207/Q	2	
1	70010022	CRANKCASE	1	
	~A0001080			

Illustration Hy-Pack versione - GAS + gear motor 48cc

Pos.	Code	Description	Qty	Notes
KIT2253	34225301	KIT 2253 CPL.SEAL D.32	1	
KIT2248	34224801	KIT 2248 PACKING D. 32	1	
KIT2246	34224601	KIT 2246 INTAKE/DELIVERY VALVE	1	
KIT2158	34215801	KIT 2158*CONROD BUSHINGS +0,50	1	
KIT2157	34215701	KIT 2157*CONROD BUSHINGS +0,25	1	
KIT2156	34215601	KIT 2156*CONROD BUSHING	1	
77	99426600	VITE TE M12X25-UNI5739 ZINC.	1	
76	71223074	STAFFA DI SOLLEVAMENTO	1	
75	10085322	FLANGE FOR HYDRAULIC MOTOR1 SAE-B S.70		
74	95115000	GEAR MOTOR 048R / S-B SCA / S1		
69	ZRPM1	ZRPM1	1	
68	90206500	PLUG FOR BORE D.17 - TTN19	1	
67	92202500	NUT M6 UNI 5588 6S	1	
66	70227034	VITE M6X12 CON INCAVO COMPLETA	1	
65	70226771	ANELLO PER ALBERO D.30 H.PACK	1	
64	99308400	SCREW M 8x30 UNI 5931	6	
61	90352800	O-RING D. 29.00x1.50 NBR 70SH 3		
60	99192500	SCREW M06X35 5931 A2-70	6	
59	70050266	PISTON GUIDE ROD	3	
58	99485000	SCREW M14X40 UNI5931 12.9 DACR.	8	
57	70225015	INLET VALVE COVER	KT 1	
56	70126615	MANIFOL FOR PISTON D.32 S	KT 1	
55	99381600	SCREW M10X110 UNI5931 8.8	4	
54	36720801	INTAKE/DELIVERY VALVE KT SER.	6	
53	90517850	ANELLO ANTIEST. 31.0x40.0x1.7 (S.66)	6	
52	36204866	VALVE SEAT (70HT)	6	
51	36211766	SPHERICAL VALVE	6	
50	94745000	SPRING D. 16X27,5	6	
49	36204751	VALVE CAGE (70HT)	6	
48	90518000	ANTI-EXTR.RING D.32.4X36.5X1.5	6	
47	90386500	O-RING 29,82X2,62 (3118)	12	

Illustration Hy-Pack versione - GAS + gear motor 48cc

Pos.	Code	Description	Qty	Notes
46	70225370	VALVE PLUG	6	
45	99429500	SCREW M12X35 UNI5931 12.31 DACR.	8	
44	70225115	OUTLET VALVE COVER	KT 1	
43	72100051	HEAD RING D.32	3	
42	90278800	PACKING D.32X44	3	
41	90278400	RESTOP RING D. 32x44x5,5/3	3	
40	70225270	INTERMEDIATE RING D.32	3	
39	90278000	PACKING D.32x40x5,5 L.P	3	
38	70082270	PACKING RETAINER D.32	3	
37	90362600	O-RING D. 50,52X1,78 (2200)	3	
36	70222551	CRANKCASE PLUG	6	
35	71225951	PLUG CAP	3	
34	70030501	CONNECTING ROD COMPLETE	3	
33	70606801	PISTON GUIDE ASSY	3	
32	90922500	LOWER HALF CONROD BUSHING 3 +0.50 (BIG END) S.70	3	
32	90922400	LOWER HALF CONROD BUSHING 3 +0.25 (BIG END) S.70	3	
32	90922300	LOWER HALF CONROD BUSHING 3 (BIG END) S.70	3	
31	90922200	UPPER HALF CONROD BUSHING 3 +0.5 (BIG END) S.70	3	
31	90922100	UPPER HALF CONROD BUSHING 3 +0.25 (BIG END) S.70	3	
31	90922000	UPPER HALF CONROD BUSHING 3 (BIG END) S.70	3	
30	90910000	CONROD BUSHING (SMALL END) 3 S.70	3	
29	97742000	GUDGEON PIN D.18X36	3	
28	70050115	PISTON GUIDE T.N.	3	
27	70224136	PISTON BOLT	3	
26	90358400	O-RING D.10,82X1,78(2043)90SH3		
25	70041309	PISTON D. 32X63	3	
24	96709900	WASHER D.10X45	3	
23	90167700	OIL SEAL D.36X47X7	3	
22	90166800	OIL SEAL D.35X52X7	1	
21	70150022	BEARING COVER (PTO SIDE)	1	
19	70020935	CRANKSHAFT C.26 HYP SAE-B	1	

Illustration Hy-Pack versione - GAS + gear motor 48cc

Pos.	Code	Description	Qty	Notes
18	99312300	CONN.ROD BOLT M8X1X42	6	
17	98200500	PLUG D. 15	5	
16	90394200	OR D.190.17X2.62 NBR 70SH	1	
15	70160622	CRANKCASE COVER KT	1	
14	90360400	O-RING 25,12X1,78 (2100)	1	
13	72210695	DIP STICK TUBE	1	
12	98211500	OIL DIPSTICK D.21,5X70	1	
11	98210050	PLUG G3/8x13 TE22	1	
10	90383300	O-RING 13,95X2,62 (3056)	1	
9	99185400	SCREW M6X16 UNI 5931 8.8 Z.	20	
8	70150122	BEARING COVER (OIL GLASS SIDE)	1	
7	90387700	O-RING 39,34X2,62 (3156)	1	
6	70211801	OIL SIGHT GLASS	1	
5	90075600	CIRCLIP D.45 (ZJ45)	1	
4	70220381	SHIM 0.25 MM.	1	
4	70220081	SHIM 0.1 MM.	1	
3	90391500	O-RING D. 80.6X2.62 (3318)	2	
2	91847700	TAPER ROLLER BEARING 33207/Q	2	
1	70010022	CRANKCASE	1	
	~A0001079			

Illustration Male shaft (key) - GAS - ATEX

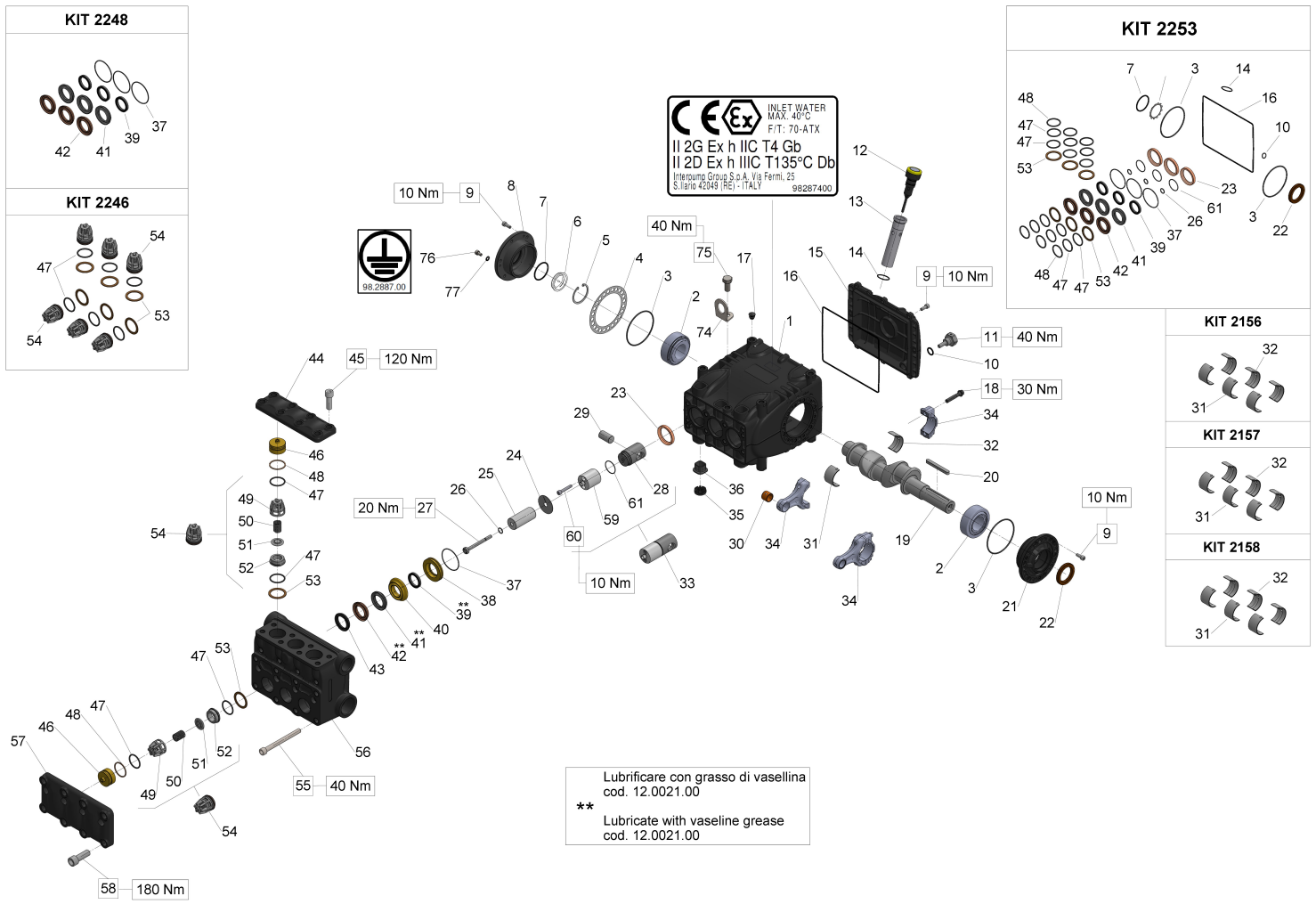

Illustration Male shaft (key) - GAS - ATEX

Pos.	Code	Description	Qty	Notes
KIT2253	34225301	KIT 2253 CPL.SEAL D.32	1	
KIT2248	34224801	KIT 2248 PACKING D. 32	1	
KIT2246	34224601	KIT 2246 INTAKE/DELIVERY VALVE	1	
KIT2158	34215801	KIT 2158*CONROD BUSHINGS +0,50	1	
KIT2157	34215701	KIT 2157*CONROD BUSHINGS +0,25	1	
KIT2156	34215601	KIT 2156*CONROD BUSHING	1	
77	96693950	WASHER 6.4x11.0x0.7 D6798A INOX	1	
76	99180900	SCREW M06X10 5931 A2-70	1	
75	99426600	VITE TE M12X25-UNI5739 ZINC. 1		
74	71223074	STAFFA DI SOLLEVAMENTO	1	
61	90352800	O-RING D. 29.00x1.50 NBR 70SH 3		
60	99192500	SCREW M06X35 5931 A2-70	6	
59	70050266	PISTON GUIDE ROD	3	
58	99485000	SCREW M14X40 UNI5931 12.9 DACR.	8	
57	70225015	INLET VALVE COVER	KT 1	
56	70126615	MANIFOL FOR PISTON D.32	KT 1	S
55	99381600	SCREW M10X110 UNI5931 8.8	4	
54	36720801	INTAKE/DELIVERY VALVE KT SER.	6	
53	90517850	ANELLO ANTIEST. 31.0x40.0x1.7 (S.66)	6	
52	36204866	VALVE SEAT (70HT)	6	
51	36211766	SPHERICAL VALVE	6	
50	94745000	SPRING D. 16X27,5	6	
49	36204751	VALVE CAGE (70HT)	6	
48	90518000	ANTI-EXTR.RING D.32.4X36.5X1.5	6	
47	90386500	O-RING 29,82X2,62 (3118)	12	
46	70225370	VALVE PLUG	6	
45	99429500	SCREW M12X35 UNI5931 12.31 DACR.	8	
44	70225115	OUTLET VALVE COVER	KT 1	
43	72100051	HEAD RING D.32	3	
42	90278800	PACKING D.32X44	3	
41	90278400	RESTOP RING D. 32x44x5,5/3	3	

Illustration Male shaft (key) - GAS - ATEX

Pos.	Code	Description	Qty	Notes
40	70225270	INTERMEDIATE RING D.32	3	
39	90278000	PACKING D.32x40x5,5 L.P	3	
38	70082270	PACKING RETAINER D.32	3	
37	90362600	O-RING D. 50,52X1,78 (2200)	3	
36	70222551	CRANKCASE PLUG	6	
35	71225951	PLUG CAP	3	
34	70030501	CONNECTING ROD COMPLETE	3	
33	70606801	PISTON GUIDE ASSY	3	
32	90922500	LOWER HALF CONROD BUSHING 3 +0.50 (BIG END) S.70	3	
32	90922400	LOWER HALF CONROD BUSHING 3 +0.25 (BIG END) S.70	3	
32	90922300	LOWER HALF CONROD BUSHING 3 (BIG END) S.70	3	
31	90922200	UPPER HALF CONROD BUSHING 3 +0.5 (BIG END) S.70	3	
31	90922100	UPPER HALF CONROD BUSHING 3 +0.25 (BIG END) S.70	3	
31	90922000	UPPER HALF CONROD BUSHING 3 (BIG END) S.70	3	
30	90910000	CONROD BUSHING (SMALL END) 3 S.70	3	
29	97742000	GUDGEON PIN D.18X36	3	
28	70050115	PISTON GUIDE T.N.	3	
27	70224136	PISTON BOLT	3	
26	90358400	O-RING D.10,82X1,78(2043)90SH3	3	
25	70041309	PISTON D. 32X63	3	
24	96709900	WASHER D.10X45	3	
23	90167700	OIL SEAL D.36X47X7	3	
22	90166800	OIL SEAL D.35X52X7	1	
21	70150022	BEARING COVER (PTO SIDE)	1	
20	91490000	KEY 8h9X7X70 UNI 6604/A	1	
19	70020635	CRANKSHAFT C.26	1	
18	99312300	CONN.ROD BOLT M8X1X42	6	
17	98200500	PLUG D. 15	5	
16	90394200	OR D.190.17X2.62 NBR 70SH	1	
15	70160622	CRANKCASE COVER KT	1	
14	90360400	O-RING 25,12X1,78 (2100)	1	
13	72210695	DIP STICK TUBE	1	

Illustration Male shaft (key) - GAS - ATEX

Pos.	Code	Description	Qty	Notes
12	98211600	ASTA LIVELLO OLIO D.21.5x70 ATEX (S.70)	1	
11	98210080	PLUG G 3/8 X 13 SS	1	
10	90383300	O-RING 13,95X2,62 (3056)	1	
9	99185400	SCREW M6X16 UNI 5931 8.8 Z.	20	
8	70150622	COPERCHIO CUSCINETTO LATO SPIA ATEX	1	
7	90387700	O-RING 39,34X2,62 (3156)	1	
6	70211751		1	
5	90075500	STOP RING J45 UNI7437	1	
4	70220381	SHIM 0.25 MM.	1	
4	70220081	SHIM 0.1 MM.	1	
3	90391500	O-RING D. 80.6X2.62 (3318)	2	
2	91847700	TAPER ROLLER BEARING 33207/Q	2	
1	70010022	CRANKCASE	1	