



VHT6639



TECHNICAL INFORMATION

| | |
|-----------------------------------|-------------------|
| Flow (L/min) | 39 / 32 |
| Flow (US Gpm) | 10,30 / 8,45 |
| Rotation regime (rpm) | 1750 / 1450 |
| Pressure (MPa) | 20 |
| Pressure (bar) | 200 |
| Pressure (psi) | 2900 |
| Power (hp) | 20 / 16,60 |
| Power (kW) | 14,70 / 12,20 |
| Overall dimensions L x l x h (mm) | 340,5x242,5x177,5 |
| Weight (kg) | 18,5 |



Documents

Male shaft (key)

Male shaft (key) - vers. ATEX

Illustration Male shaft (key)

| KIT 375 | KIT 2 | KIT 3 | KIT 377 | KIT 208 |
|---------|-------|-------|---------|---------|
| | | | | |

Lubrificare con grasso di vasellina
cod. 12.0021.00
**
Lubricate with vaseline grease
cod. 12.0021.00

Fissare con Loctite 542
colore ROSSO cod.12.0062.00
*
Fix with red Loctite 542
cod. 12.0062.00

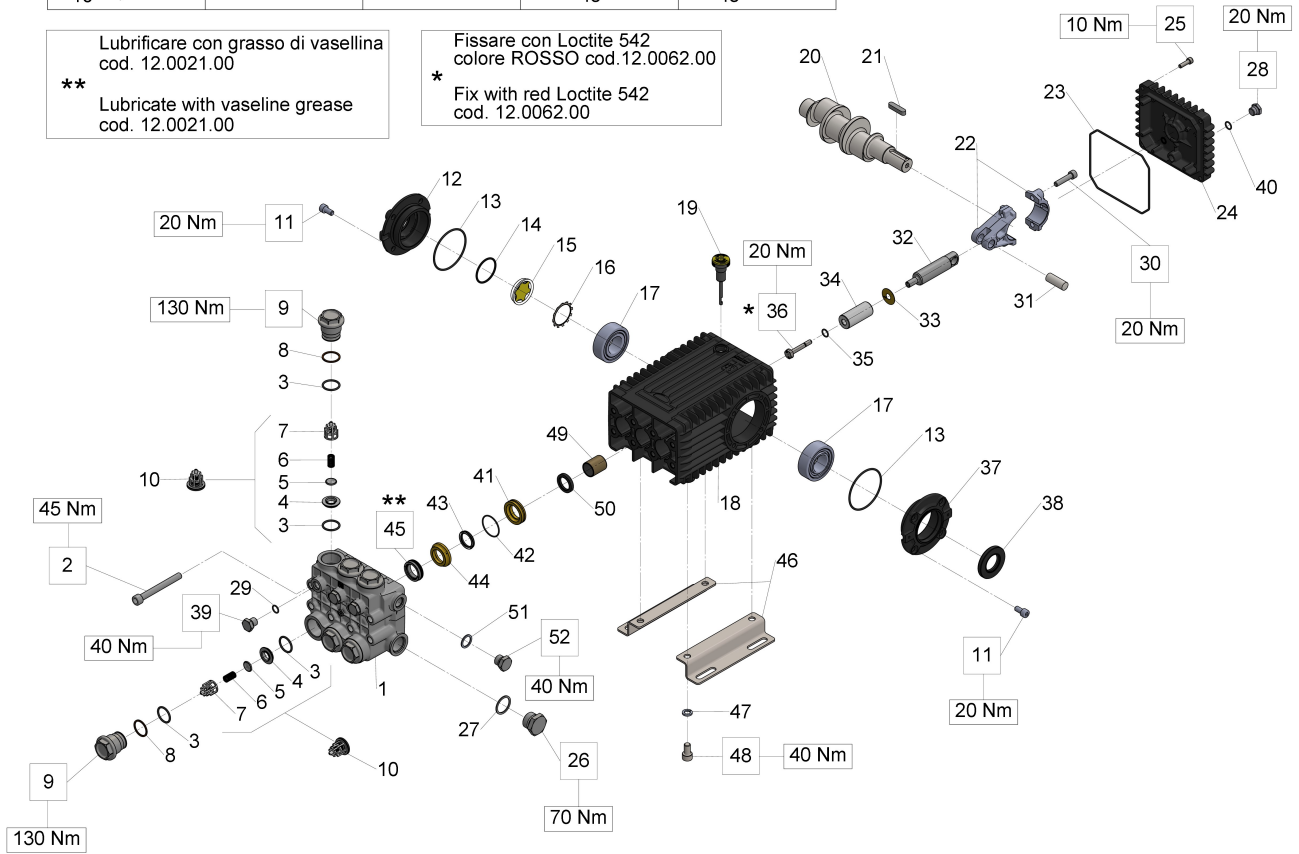

Illustration Male shaft (key)

| Pos. | Code | Description | Qty | Notes |
|--------|----------|--|-----|-------|
| KIT3 | 34000301 | KIT 3 OIL SEAL D.30X55X7 | 1 | |
| KIT2 | 34000201 | KIT 2 OIL SEAL D. 22X32X5,5 | 1 | |
| KIT377 | 34037701 | | 1 | |
| KIT375 | 34037501 | | 1 | |
| KIT208 | 34020801 | | 1 | |
| 52 | 98209900 | PLUG G. 3/8X13 NICKEL | 1 | |
| 51 | 96738000 | WASHER 17,5X23X1,5 | 1 | |
| 50 | 90162500 | OIL SEAL 22x32x5 | 3 | |
| 49 | 90912600 | BUSHING 22X25X30 | 3 | |
| 48 | 99364400 | SCREW M 10x18-5931 | 4 | |
| 47 | 96710600 | WASHER 10,2 | 4 | |
| 46 | 47200074 | PUMP FOOT | 2 | |
| 45 | 90231200 | H.P. SEAL D.22X32X10 (66HT) | 3 | |
| 44 | 66216170 | INTERMEDIATE RING D.22 | 3 | |
| 43 | 90230000 | L.P. SEAL D.22 (HT) | 3 | |
| 42 | 90361650 | O-RING D. 34.65x1.78 HNBR 70SH 2137 | 3 | |
| 41 | 66081370 | | 3 | |
| 40 | 90358500 | O-RING 10,82X1,78 (2043) | 1 | |
| 39 | 98204700 | | 3 | |
| 38 | 90164800 | OIL SEAL 30x55x7 | 1 | |
| 37 | 47151022 | OPEN SIDE COVER (47-66) | 1 | |
| 36 | 66219566 | PISTON BOLT | 3 | |
| 35 | 90358450 | | 3 | |
| 34 | 66040109 | PISTON D. 22X54 | 3 | |
| 33 | 96710100 | WASHER D. 10X28X0.5 | 3 | |
| 32 | 66050066 | PISTON GUIDE - S.S. | 3 | |
| 31 | 97740500 | CONNECTING ROD-PIN D.14X39 | 3 | |
| 30 | 99309900 | SCREW M 8x35 UNI 5931 | 6 | |
| 29 | 90358550 | O-RING D.10.82x1.78 HNBR 70SH 2043 | 3 | |
| 28 | 98204250 | PLUG G1/4"x12 | 1 | |
| 27 | 96770000 | WASHER 26,5X32X1,5 | 1 | |
| 26 | 98226900 | | 1 | |
| 25 | 99188400 | SCREW M 6x20 UNI 5931 | 4 | |
| 24 | 66160022 | REAR COVER | 1 | |
| 23 | 90392200 | O-RING D.133.02X 2,62(3525) | 1 | |
| 22 | 66030001 | CONNECTING ROD | 3 | |
| 21 | 91489200 | KEY 8(h9)X7X35 UNI 6604/A | 1 | |

Illustration Male shaft (key)

| Pos. | Code | Description | Qty | Notes |
|------|----------|---------------------------------------|-----|-------|
| 20 | 66020435 | CRANKSHAFT C.21 - D. 24 | 1 | |
| 19 | 98210600 | OIL DIP-STICK G3/8X80 | 1 | |
| 18 | 66010022 | CRANKCASE | 1 | |
| 17 | 91838000 | ROLLER BEARING NJ2206EC | 2 | |
| 16 | 90075600 | CIRCLIP D.45 (ZJ45) | 1 | |
| 15 | 70211801 | OIL SIGHT GLASS | 1 | |
| 14 | 90387700 | O-RING 39,34X2,62 (3156) | 1 | |
| 13 | 90391300 | O-RING 67,95X2,62 (3268) | 2 | |
| 12 | 47151222 | SIDE CRANKCASE COVER FOR OIL GAUGE | 1 | |
| 11 | 99303900 | SCREW M 8x16 UNI 5931 | 8 | |
| 10 | 36726301 | | 6 | |
| 9 | 66130341 | | 6 | |
| 8 | 90516500 | ANTI-EXTR.RING D.24.7x29x1.5 | 6 | |
| 7 | 36203551 | VALVE CAGE | 6 | |
| 6 | 94738800 | SPRING Dm. 10x18.5 | 6 | |
| 5 | 36203476 | SPHERICAL VALVE | 6 | |
| 4 | 36203366 | VALVE SEAT | 6 | |
| 3 | 90385750 | | 12 | |
| 2 | 99380100 | SCREW M10X90 UNI 5931 8.8 | 8 | |
| 1 | 66120741 | | 1 | |

Illustration Male shaft (key) - vers. ATEX

| KIT 375 | KIT 2 | KIT 3 | KIT 377 | KIT 208 |
|---------|-------|-------|---------|---------|
| | | | | |

Lubrificare con grasso di vasellina
cod. 12.0021.00
**
Lubricate with vaseline grease
cod. 12.0021.00

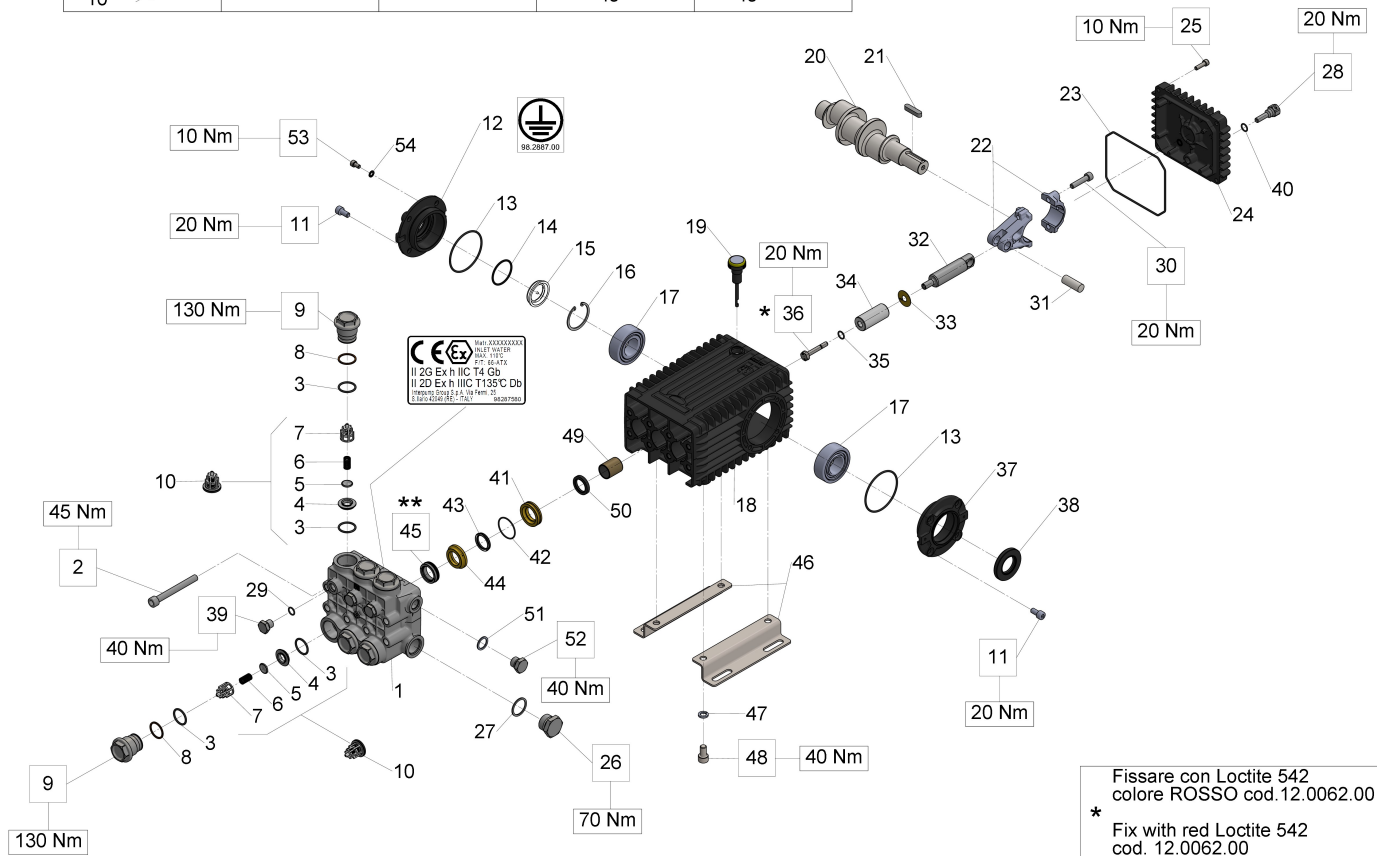

Illustration Male shaft (key) - vers. ATEX

| Pos. | Code | Description | Qty | Notes |
|--------|----------|-------------------------------------|-----|-------|
| KIT3 | 34000301 | KIT 3 OIL SEAL D.30X55X7 | 1 | |
| KIT2 | 34000201 | KIT 2 OIL SEAL D. 22X32X5,5 | 1 | |
| KIT377 | 34037701 | | 1 | |
| KIT375 | 34037501 | | 1 | |
| KIT208 | 34020801 | | 1 | |
| 54 | 96693950 | WASHER 6.4x11.0x0.7 D6798A INOX | 1 | |
| 53 | 99180900 | SCREW M06X10 5931 A2-70 | 1 | |
| 52 | 98209900 | PLUG G. 3/8X13 NICKEL | 1 | |
| 51 | 96738000 | WASHER 17,5X23X1,5 | 1 | |
| 50 | 90162500 | OIL SEAL 22x32x5 | 3 | |
| 49 | 90912600 | BUSHING 22X25X30 | 3 | |
| 48 | 99364400 | SCREW M 10x18-5931 | 4 | |
| 47 | 96710600 | WASHER 10,2 | 4 | |
| 46 | 47200074 | PUMP FOOT | 2 | |
| 45 | 90231200 | H.P. SEAL D.22X32X10 (66HT) | 3 | |
| 44 | 66216170 | INTERMEDIATE RING D.22 | 3 | |
| 43 | 90230000 | L.P. SEAL D.22 (HT) | 3 | |
| 42 | 90361650 | O-RING D. 34.65x1.78 HNBR 70SH 2137 | 3 | |
| 41 | 66081370 | | 3 | |
| 40 | 90358500 | O-RING 10,82X1,78 (2043) | 1 | |
| 39 | 98204700 | | 3 | |
| 38 | 90164800 | OIL SEAL 30x55x7 | 1 | |
| 37 | 47151022 | OPEN SIDE COVER (47-66) | 1 | |
| 36 | 66219566 | PISTON BOLT | 3 | |
| 35 | 90358450 | | 3 | |
| 34 | 66040109 | PISTON D. 22X54 | 3 | |
| 33 | 96710100 | WASHER D. 10X28X0.5 | 3 | |
| 32 | 66050066 | PISTON GUIDE - S.S. | 3 | |
| 31 | 97740500 | CONNECTING ROD-PIN D.14X39 | 3 | |
| 30 | 99309900 | SCREW M 8x35 UNI 5931 | 6 | |
| 29 | 90358550 | O-RING D.10.82x1.78 HNBR 70SH 2043 | 3 | |
| 28 | 98203600 | PLUG G1/4x8 FOR PROBE D.6 S.S. | 1 | |
| 27 | 96770000 | WASHER 26,5X32X1,5 | 1 | |
| 26 | 98226900 | | 1 | |
| 25 | 99188400 | SCREW M 6x20 UNI 5931 | 4 | |
| 24 | 66160022 | REAR COVER | 1 | |
| 23 | 90392200 | O-RING D.133.02X 2,62(3525) | 1 | |

Illustration Male shaft (key) - vers. ATEX

| Pos. | Code | Description | Qty | Notes |
|------|----------|--|-----|-------|
| 22 | 66030001 | CONNECTING ROD | 3 | |
| 21 | 91489200 | KEY 8(h9)X7X35 UNI 6604/A | 1 | |
| 20 | 66020435 | CRANKSHAFT C.21 - D. 24 | 1 | |
| 19 | 98210700 | OIL DIPSTICK G3/8X64 D4+FILTER ATEX | 1 | |
| 18 | 66010022 | CRANKCASE | 1 | |
| 17 | 91838000 | ROLLER BEARING NJ2206EC | 2 | |
| 16 | 90075500 | STOP RING J45 UNI7437 | 1 | |
| 15 | 70211751 | | 1 | |
| 14 | 90387700 | O-RING 39,34X2,62 (3156) | 1 | |
| 13 | 90391300 | O-RING 67,95X2,62 (3268) | 2 | |
| 12 | 47151322 | SIDE CRANKCASE COVER (ATEX) | 1 | |
| 11 | 99303900 | SCREW M 8x16 UNI 5931 | 8 | |
| 10 | 36726301 | | 6 | |
| 9 | 66130341 | | 6 | |
| 8 | 90516500 | ANTI-EXTR.RING D.24.7x29x1.5 | 6 | |
| 7 | 36203551 | VALVE CAGE | 6 | |
| 6 | 94738800 | SPRING Dm. 10x18.5 | 6 | |
| 5 | 36203476 | SPHERICAL VALVE | 6 | |
| 4 | 36203366 | VALVE SEAT | 6 | |
| 3 | 90385750 | | 12 | |
| 2 | 99380100 | SCREW M10X90 UNI 5931 8.8 | 8 | |
| 1 | 66120741 | | 1 | |