

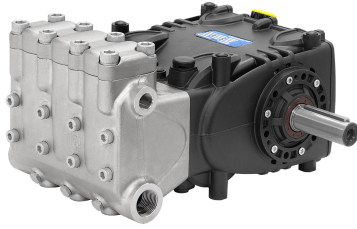

## WK531



### TECHNICAL INFORMATION

Flow (L/min)	30
Flow (US Gpm)	7,9
Rotation regime (rpm)	1450
Pressure (MPa)	50
Pressure (bar)	500
Pressure (psi)	7250
Power (hp)	39
Power (kW)	28,7
Overall dimensions L x l x h (mm)	395x340,5x258
Weight (kg)	39



## Documents

Male shaft (key) - GAS

---

Male shaft (key) - NPT

---

Male shaft (key) + flange A - GAS

---

Hollow shaft (spline) + SAE B flange - GAS

---

Hollow shaft (spline) + SAE B flange - NPT

---

Male shaft (key) - GAS - ATEX

---

# Illustration Male shaft (key) - GAS

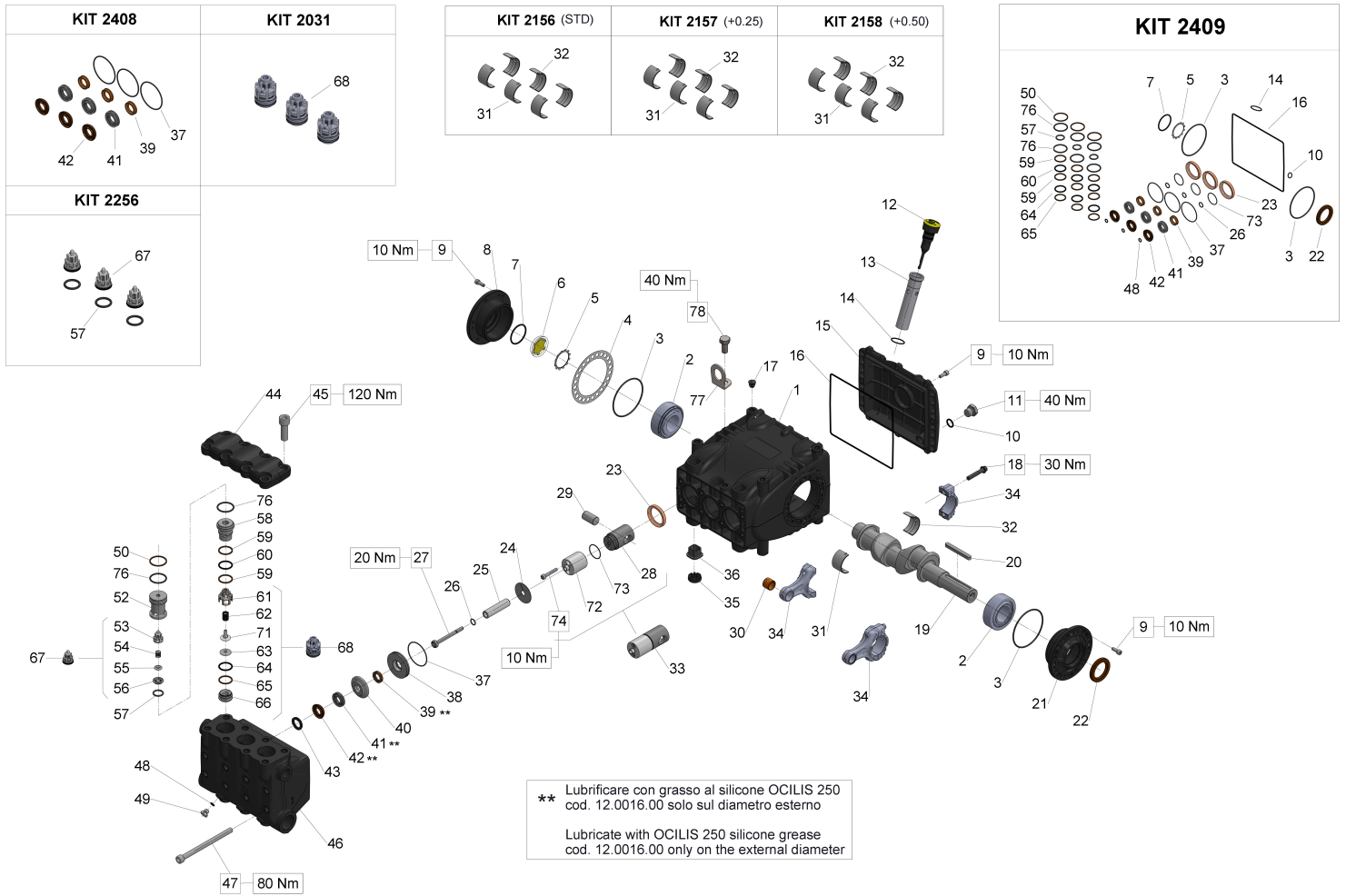

## Illustration Male shaft (key) - GAS

Pos.	Code	Description	Qty	Notes
KIT2409	34240901		1	
KIT2408	34240801		1	
KIT2256	34225601		1	
KIT2158	34215801	KIT 2158*CONROD BUSHINGS +0,50	1	
KIT2157	34215701	KIT 2157*CONROD BUSHINGS +0,25	1	
KIT2156	34215601	KIT 2156*CONROD BUSHING	1	
KIT2031	34203101		1	
78	99426600	VITE TE M12X25-UNI5739 ZINC.	1	
77	71223074	STAFFA DI SOLLEVAMENTO	1	
76	90386600		2	
74	99192500	SCREW M06X35 5931 A2-70	6	
73	90352800	O-RING D. 29.00x1.50 NBR 70SH 3		
72	70050266	PISTON GUIDE ROD	3	
71	36210151		1	
68	36714401		1	
67	36712101	INTAKE/DELIVERY VALVE	1	
66	36204966		1	
65	90515500		1	
64	90385600		1	
63	36205066		1	
62	94739700		1	
61	36213805		1	
60	90385800		1	
59	90516500	ANTI-EXTR.RING D.24.7x29x1.5	2	
58	70224266		1	
57	90384100	O-RING 17,12X2,62 (3068)	1	
56	36200366	VALVE SEAT	1	
55	36203266	SPHERICAL VALVE	1	
54	94737600	SPRING D. 9,4X14,8	1	
53	36202551	VALVE CAGE	1	
52	70224366		1	
50	90517750		1	
49	98197200	PLUG G1/8X8 S.S.	1	
48	90357600		1	
47	99382800		4	
46	70125636		1	
45	99485000	SCREW M14X40 UNI5931 12.9 DACR.	4	

## Illustration Male shaft (key) - GAS

Pos.	Code	Description	Qty	Notes
44	70224036		1	
43	70100651		3	
42	90266100		3	
41	90266000		3	
40	70227766		3	
39	90266200		3	
38	70082366		3	
37	90362600	O-RING D. 50,52X1,78 (2200)	3	
36	70222551	CRANKCASE PLUG	6	
35	71225951	PLUG CAP	3	
34	70030501	CONNECTING ROD COMPLETE	3	
33	70606801	PISTON GUIDE ASSY	3	
32	90922200	UPPER HALF CONROD BUSHING +0.5 (BIG END) S.70	3	
32	90922100	UPPER HALF CONROD BUSHING +0.25 (BIG END) S.70	3	
32	90922300	LOWER HALF CONROD BUSHING (BIG END) S.70	3	
31	90922500	LOWER HALF CONROD BUSHING +0.50 (BIG END) S.70	3	
31	90922400	LOWER HALF CONROD BUSHING +0.25 (BIG END) S.70	3	
31	90922000	UPPER HALF CONROD BUSHING (BIG END) S.70	3	
30	90910000	CONROD BUSHING (SMALL END) S.70	3	
29	97742000	GUDGEON PIN D.18X36	3	
28	70050115	PISTON GUIDE T.N.	3	
27	70224136	PISTON BOLT	3	
26	90358400	O-RING D.10,82X1,78(2043)90SH3		
25	70041809		3	
24	96709900	WASHER D.10X45	3	
23	90167700	OIL SEAL D.36X47X7	3	
22	90166800	OIL SEAL D.35X52X7	1	
21	70150022	BEARING COVER (PTO SIDE)	1	
20	91490000	KEY 8h9X7X70 UNI 6604/A	1	
19	70020635	CRANKSHAFT C.26	1	
18	99312300	CONN.ROD BOLT M8X1X42	6	
17	98200500	PLUG D. 15	5	
16	90394200	OR D.190.17X2.62 NBR 70SH	1	

## Illustration Male shaft (key) - GAS

---

Pos.	Code	Description	Qty	Notes
15	70160622	CRANKCASE COVER KT	1	
14	90360400	O-RING 25,12X1,78 (2100)	1	
13	72210695	DIP STICK TUBE	1	
12	98211500	OIL DIPSTICK D.21,5X70	1	
11	98210050	PLUG G3/8x13 TE22	1	
10	90383300	O-RING 13,95X2,62 (3056)	1	
9	99185400	SCREW M6X16 UNI 5931 8.8 Z.	20	
8	70150122	BEARING COVER (OIL GLASS SIDE)	1	
7	90387700	O-RING 39,34X2,62 (3156)	1	
6	70211801	OIL SIGHT GLASS	1	
5	90075600	CIRCLIP D.45 (ZJ45)	1	
4	70220381	SHIM 0.25 MM.	1	
4	70220081	SHIM 0.1 MM.	1	
3	90391500	O-RING D. 80.6X2.62 (3318)	2	
2	91847700	TAPER ROLLER BEARING 33207/Q	2	
1	70010022	CRANKCASE	1	

# Illustration Male shaft (key) - NPT

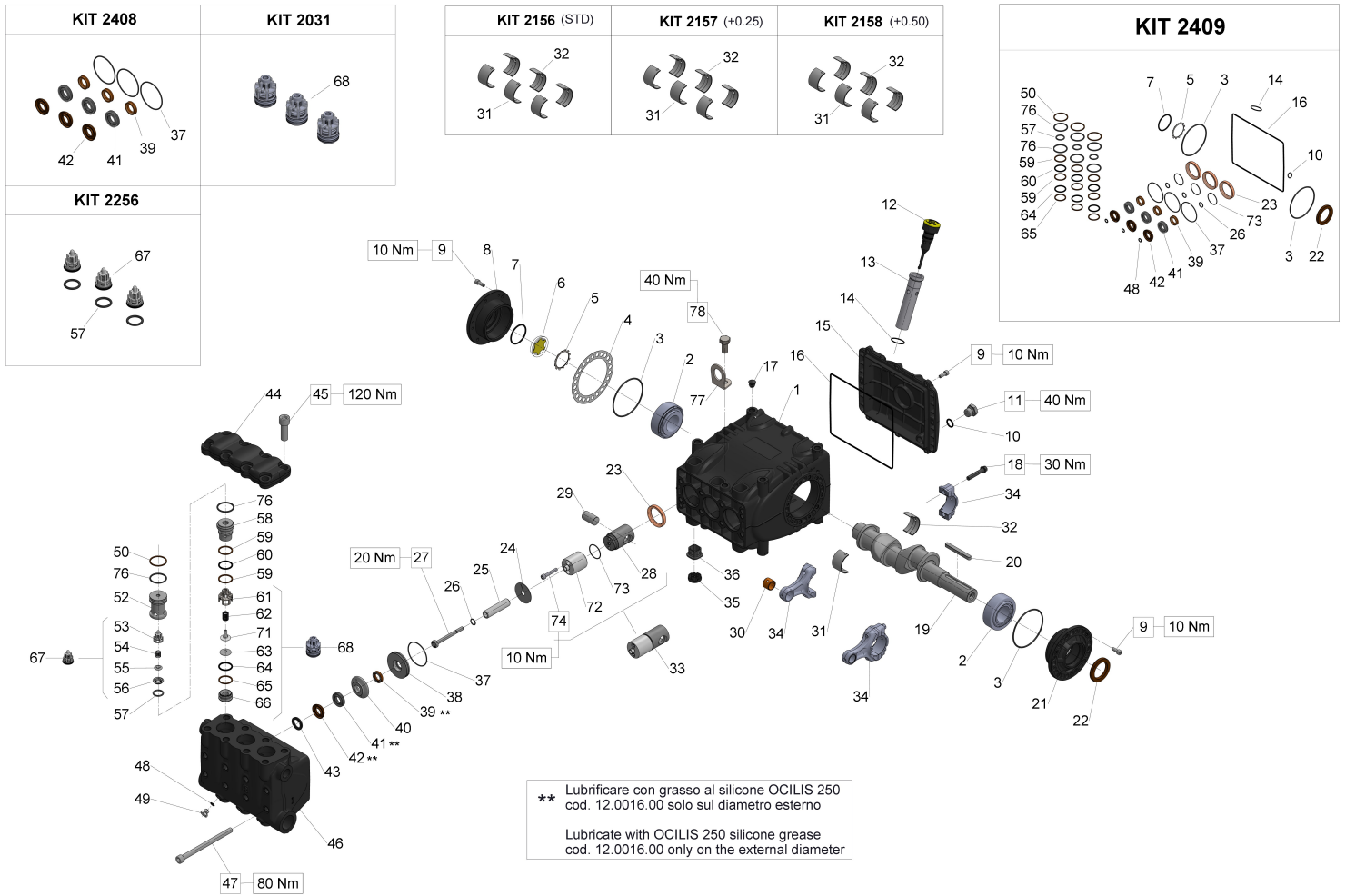

## Illustration Male shaft (key) - NPT

Pos.	Code	Description	Qty	Notes
KIT2409	34240901		1	
KIT2408	34240801		1	
KIT2256	34225601		1	
KIT2158	34215801	KIT 2158*CONROD BUSHINGS +0,50	1	
KIT2157	34215701	KIT 2157*CONROD BUSHINGS +0,25	1	
KIT2156	34215601	KIT 2156*CONROD BUSHING	1	
KIT2031	34203101		1	
78	99426600	VITE TE M12X25-UNI5739 ZINC.	1	
77	71223074	STAFFA DI SOLLEVAMENTO	1	
76	90386600		2	
74	99192500	SCREW M06X35 5931 A2-70	6	
73	90352800	O-RING D. 29.00x1.50 NBR 70SH 3		
72	70050266	PISTON GUIDE ROD	3	
71	36210151		1	
68	36714401		1	
67	36712101	INTAKE/DELIVERY VALVE	1	
66	36204966		1	
65	90515500		1	
64	90385600		1	
63	36205066		1	
62	94739700		1	
61	36213805		1	
60	90385800		1	
59	90516500	ANTI-EXTR.RING D.24.7x29x1.5	2	
58	70224266		1	
57	90384100	O-RING 17,12X2,62 (3068)	1	
56	36200366	VALVE SEAT	1	
55	36203266	SPHERICAL VALVE	1	
54	94737600	SPRING D. 9,4X14,8	1	
53	36202551	VALVE CAGE	1	
52	70224366		1	
50	90517750		1	
49	98197200	PLUG G1/8X8 S.S.	1	
48	90357600		1	
47	99382800		4	
46	70125936		1	
45	99485000	SCREW M14X40 UNI5931 12.9 DACR.	4	

## Illustration Male shaft (key) - NPT

Pos.	Code	Description	Qty	Notes
44	70224036		1	
43	70100651		3	
42	90266100		3	
41	90266000		3	
40	70227766		3	
39	90266200		3	
38	70082366		3	
37	90362600	O-RING D. 50,52X1,78 (2200)	3	
36	70222551	CRANKCASE PLUG	6	
35	71225951	PLUG CAP	3	
34	70030501	CONNECTING ROD COMPLETE	3	
33	70606801	PISTON GUIDE ASSY	3	
32	90922200	UPPER HALF CONROD BUSHING +0.5 (BIG END) S.70	3	
32	90922100	UPPER HALF CONROD BUSHING +0.25 (BIG END) S.70	3	
32	90922300	LOWER HALF CONROD BUSHING (BIG END) S.70	3	
31	90922500	LOWER HALF CONROD BUSHING +0.50 (BIG END) S.70	3	
31	90922400	LOWER HALF CONROD BUSHING +0.25 (BIG END) S.70	3	
31	90922000	UPPER HALF CONROD BUSHING (BIG END) S.70	3	
30	90910000	CONROD BUSHING (SMALL END) S.70	3	
29	97742000	GUDGEON PIN D.18X36	3	
28	70050115	PISTON GUIDE T.N.	3	
27	70224136	PISTON BOLT	3	
26	90358400	O-RING D.10,82X1,78(2043)90SH3		
25	70041809		3	
24	96709900	WASHER D.10X45	3	
23	90167700	OIL SEAL D.36X47X7	3	
22	90166800	OIL SEAL D.35X52X7	1	
21	70150022	BEARING COVER (PTO SIDE)	1	
20	91490000	KEY 8h9X7X70 UNI 6604/A	1	
19	70020635	CRANKSHAFT C.26	1	
18	99312300	CONN.ROD BOLT M8X1X42	6	
17	98200500	PLUG D. 15	5	
16	90394200	OR D.190.17X2.62 NBR 70SH	1	

## Illustration Male shaft (key) - NPT

Pos.	Code	Description	Qty	Notes
15	70160622	CRANKCASE COVER KT	1	
14	90360400	O-RING 25,12X1,78 (2100)	1	
13	72210695	DIP STICK TUBE	1	
12	98211500	OIL DIPSTICK D.21,5X70	1	
11	98210050	PLUG G3/8x13 TE22	1	
10	90383300	O-RING 13,95X2,62 (3056)	1	
9	99185400	SCREW M6X16 UNI 5931 8.8 Z.	20	
8	70150122	BEARING COVER (OIL GLASS SIDE)	1	
7	90387700	O-RING 39,34X2,62 (3156)	1	
6	70211801	OIL SIGHT GLASS	1	
5	90075600	CIRCLIP D.45 (ZJ45)	1	
4	70220381	SHIM 0.25 MM.	1	
4	70220081	SHIM 0.1 MM.	1	
3	90391500	O-RING D. 80.6X2.62 (3318)	2	
2	91847700	TAPER ROLLER BEARING 33207/Q	2	
1	70010022	CRANKCASE	1	

# Illustration Male shaft (key) + flange A - GAS

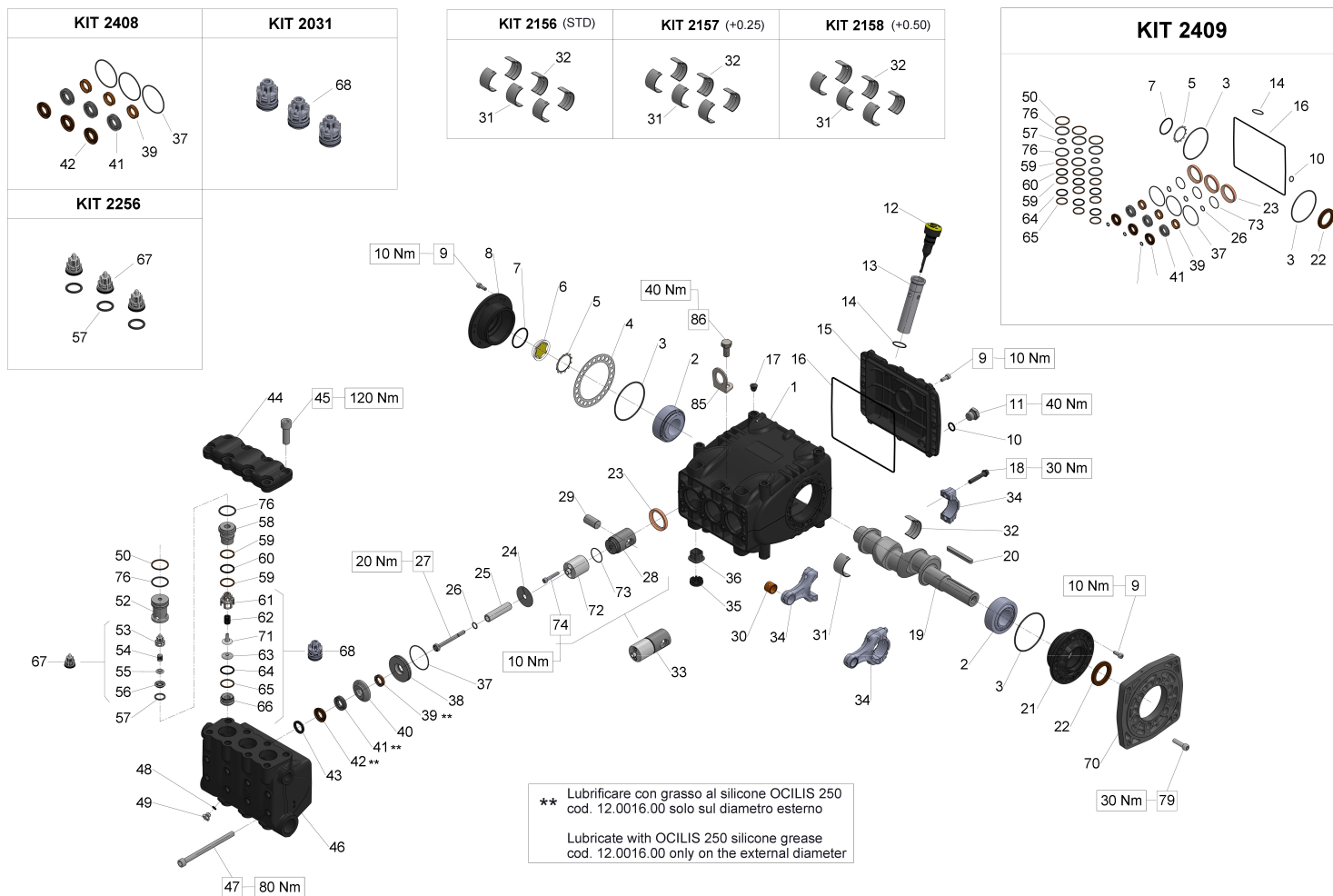

## Illustration Male shaft (key) + flange A - GAS

Pos.	Code	Description	Qty	Notes
KIT2409	34240901		1	
KIT2408	34240801		1	
KIT2256	34225601		1	
KIT2158	34215801	KIT 2158*CONROD BUSHINGS +0,50	1	
KIT2157	34215701	KIT 2157*CONROD BUSHINGS +0,25	1	
KIT2156	34215601	KIT 2156*CONROD BUSHING	1	
KIT2031	34203101		1	
86	99426600	VITE TE M12X25-UNI5739 ZINC.	1	
85	71223074	STAFFA DI SOLLEVAMENTO	1	
79	99308400	SCREW M 8x30 UNI 5931	6	
76	90386600		2	
74	99192500	SCREW M06X35 5931 A2-70	6	
73	90352800	O-RING D. 29.00x1.50 NBR 70SH 3	3	
72	70050266	PISTON GUIDE ROD	3	
71	36210151		1	
70	10067320	FLANGE FOR HYDRAULIC MOTOR1 KE TYPE A	1	
68	36714401		1	
67	36712101	INTAKE/DELIVERY VALVE	1	
66	36204966		1	
65	90515500		1	
64	90385600		1	
63	36205066		1	
62	94739700		1	
61	36213805		1	
60	90385800		1	
59	90516500	ANTI-EXTR.RING D.24.7x29x1.5	2	
58	70224266		1	
57	90384100	O-RING 17,12X2,62 (3068)	1	
56	36200366	VALVE SEAT	1	
55	36203266	SPHERICAL VALVE	1	
54	94737600	SPRING D. 9,4X14,8	1	
53	36202551	VALVE CAGE	1	
52	70224366		1	
50	90517750		1	
49	98197200	PLUG G1/8X8 S.S.	1	
48	90357600		1	
47	99382800		4	

## Illustration Male shaft (key) + flange A - GAS

Pos.	Code	Description	Qty	Notes
46	70125636		1	
45	99485000	SCREW M14X40 UNI5931 12.9 DACR.	4	
44	70224036		1	
43	70100651		3	
42	90266100		3	
41	90266000		3	
40	70227766		3	
39	90266200		3	
38	70082366		3	
37	90362600	O-RING D. 50,52X1,78 (2200)	3	
36	70222551	CRANKCASE PLUG	6	
35	71225951	PLUG CAP	3	
34	70030501	CONNECTING ROD COMPLETE	3	
33	70606801	PISTON GUIDE ASSY	3	
32	90922200	UPPER HALF CONROD BUSHING +0.5 (BIG END) S.70	3	
32	90922100	UPPER HALF CONROD BUSHING +0.25 (BIG END) S.70	3	
32	90922300	LOWER HALF CONROD BUSHING (BIG END) S.70	3	
31	90922500	LOWER HALF CONROD BUSHING +0.50 (BIG END) S.70	3	
31	90922400	LOWER HALF CONROD BUSHING +0.25 (BIG END) S.70	3	
31	90922000	UPPER HALF CONROD BUSHING (BIG END) S.70	3	
30	90910000	CONROD BUSHING (SMALL END) S.70	3	
29	97742000	GUDGEON PIN D.18X36	3	
28	70050115	PISTON GUIDE T.N.	3	
27	70224136	PISTON BOLT	3	
26	90358400	O-RING D.10,82X1,78(2043)90SH3		
25	70041809		3	
24	96709900	WASHER D.10X45	3	
23	90167700	OIL SEAL D.36X47X7	3	
22	90166800	OIL SEAL D.35X52X7	1	
21	70150022	BEARING COVER (PTO SIDE)	1	
20	91490000	KEY 8h9X7X70 UNI 6604/A	1	
19	70020635	CRANKSHAFT C.26	1	

## Illustration Male shaft (key) + flange A - GAS

Pos.	Code	Description	Qty	Notes
18	99312300	CONN.ROD BOLT M8X1X42	6	
17	98200500	PLUG D. 15	5	
16	90394200	OR D.190.17X2.62 NBR 70SH	1	
15	70160622	CRANKCASE COVER KT	1	
14	90360400	O-RING 25,12X1,78 (2100)	1	
13	72210695	DIP STICK TUBE	1	
12	98211500	OIL DIPSTICK D.21,5X70	1	
11	98210050	PLUG G3/8x13 TE22	1	
10	90383300	O-RING 13,95X2,62 (3056)	1	
9	99185400	SCREW M6X16 UNI 5931 8.8 Z.	20	
8	70150122	BEARING COVER (OIL GLASS SIDE)	1	
7	90387700	O-RING 39,34X2,62 (3156)	1	
6	70211801	OIL SIGHT GLASS	1	
5	90075600	CIRCLIP D.45 (ZJ45)	1	
4	70220381	SHIM 0.25 MM.	1	
4	70220081	SHIM 0.1 MM.	1	
3	90391500	O-RING D. 80.6X2.62 (3318)	2	
2	91847700	TAPER ROLLER BEARING 33207/Q	2	
1	70010022	CRANKCASE	1	

# Illustration Hollow shaft (spline) + SAE B flange - GAS

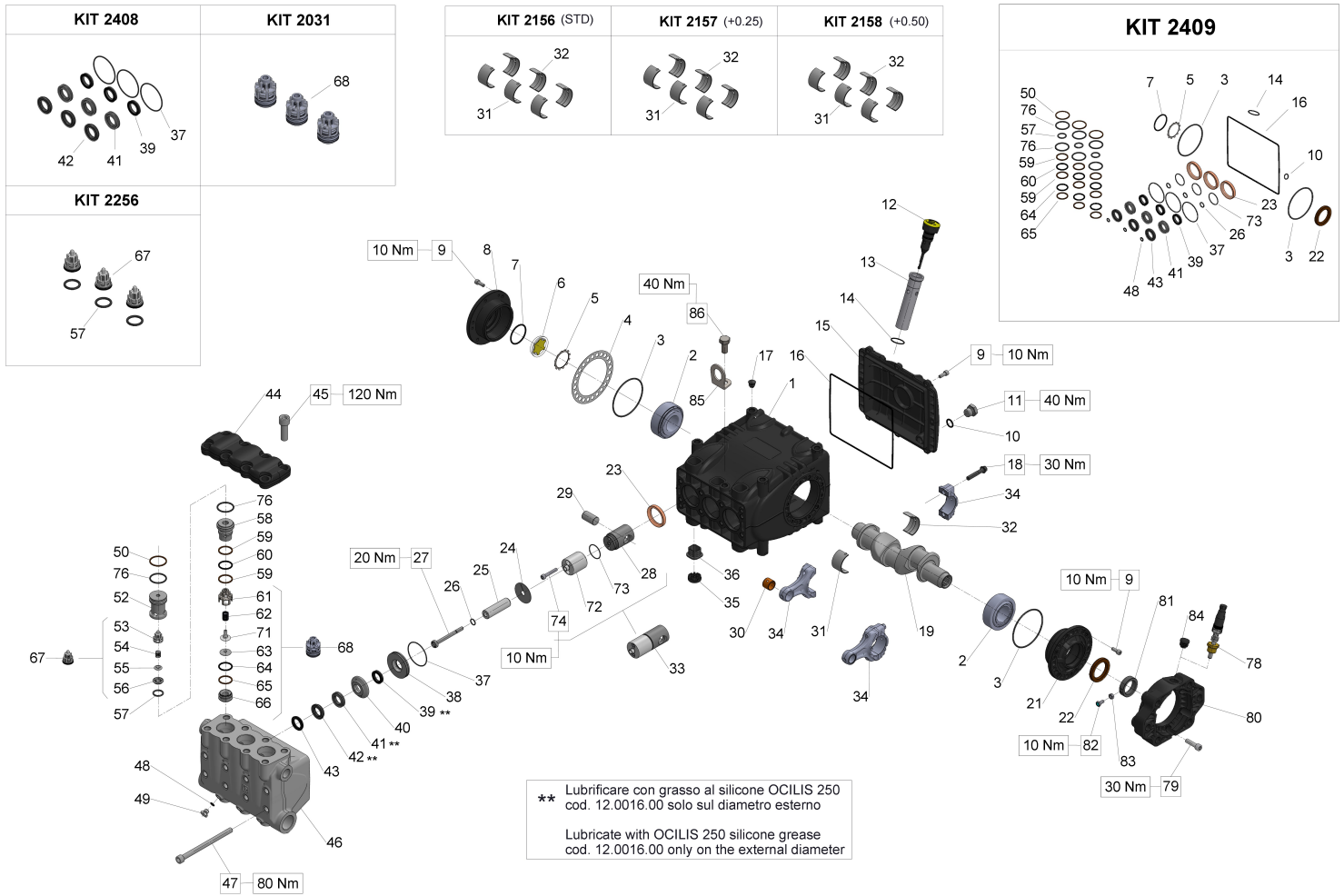

## Illustration Hollow shaft (spline) + SAE B flange - GAS

Pos.	Code	Description	Qty	Notes
KIT2409	34240901		1	
KIT2408	34240801		1	
KIT2256	34225601		1	
KIT2158	34215801	KIT 2158*CONROD BUSHINGS +0,50	1	
KIT2157	34215701	KIT 2157*CONROD BUSHINGS +0,25	1	
KIT2156	34215601	KIT 2156*CONROD BUSHING	1	
KIT2031	34203101		1	
86	99426600	VITE TE M12X25-UNI5739 ZINC.	1	
85	71223074	STAFFA DI SOLLEVAMENTO	1	
84	90206500	PLUG FOR BORE D.17 - TTN19	1	
83	92202500	NUT M6 UNI 5588 6S	1	
82	70227034	VITE M6X12 CON INCAVO COMPLETA	1	
81	70226771	ANELLO PER ALBERO D.30 H.PACK	1	
80	10085322	FLANGE FOR HYDRAULIC MOTOR1 SAE-B S.70	1	
79	99308400	SCREW M 8x30 UNI 5931	6	
78	ZRPM1	ZRPM1	1	
76	90386600		2	
74	99192500	SCREW M06X35 5931 A2-70	6	
73	90352800	O-RING D. 29.00x1.50 NBR 70SH	3	
72	70050266	PISTON GUIDE ROD	3	
71	36210151		1	
68	36714401		1	
67	36712101	INTAKE/DELIVERY VALVE	1	
66	36204966		1	
65	90515500		1	
64	90385600		1	
63	36205066		1	
62	94739700		1	
61	36213805		1	
60	90385800		1	
59	90516500	ANTI-EXTR.RING D.24.7x29x1.5	2	
58	70224266		1	
57	90384100	O-RING 17,12X2,62 (3068)	1	
56	36200366	VALVE SEAT	1	
55	36203266	SPHERICAL VALVE	1	
54	94737600	SPRING D. 9,4X14,8	1	

## Illustration Hollow shaft (spline) + SAE B flange - GAS

Pos.	Code	Description	Qty	Notes
53	36202551	VALVE CAGE	1	
52	70224366		1	
50	90517750		1	
49	98197200	PLUG G1/8X8 S.S.	1	
48	90357600		1	
47	99382800		4	
46	70125636		1	
45	99485000	SCREW M14X40 UNI5931 12.9 DACR.	4	
44	70224036		1	
43	70100651		3	
42	90266100		3	
41	90266000		3	
40	70227766		3	
39	90266200		3	
38	70082366		3	
37	90362600	O-RING D. 50,52X1,78 (2200)	3	
36	70222551	CRANKCASE PLUG	6	
35	71225951	PLUG CAP	3	
34	70030501	CONNECTING ROD COMPLETE	3	
33	70606801	PISTON GUIDE ASSY	3	
32	90922200	UPPER HALF CONROD BUSHING +0.5 (BIG END) S.70	3	
32	90922100	UPPER HALF CONROD BUSHING +0.25 (BIG END) S.70	3	
32	90922300	LOWER HALF CONROD BUSHING (BIG END) S.70	3	
31	90922500	LOWER HALF CONROD BUSHING +0.50 (BIG END) S.70	3	
31	90922400	LOWER HALF CONROD BUSHING +0.25 (BIG END) S.70	3	
31	90922000	UPPER HALF CONROD BUSHING (BIG END) S.70	3	
30	90910000	CONROD BUSHING (SMALL END) S.70	3	
29	97742000	GUDGEON PIN D.18X36	3	
28	70050115	PISTON GUIDE T.N.	3	
27	70224136	PISTON BOLT	3	
26	90358400	O-RING D.10,82X1,78(2043)90SH3		
25	70041809		3	

## Illustration Hollow shaft (spline) + SAE B flange - GAS

Pos.	Code	Description	Qty	Notes
24	96709900	WASHER D.10X45	3	
23	90167700	OIL SEAL D.36X47X7	3	
22	90166800	OIL SEAL D.35X52X7	1	
21	70150022	BEARING COVER (PTO SIDE)	1	
19	70020935	CRANKSHAFT C.26 HYP SAE-B	1	
18	99312300	CONN.ROD BOLT M8X1X42	6	
17	98200500	PLUG D. 15	5	
16	90394200	OR D.190.17X2.62 NBR 70SH	1	
15	70160622	CRANKCASE COVER KT	1	
14	90360400	O-RING 25,12X1,78 (2100)	1	
13	72210695	DIP STICK TUBE	1	
12	98211500	OIL DIPSTICK D.21,5X70	1	
11	98210050	PLUG G3/8x13 TE22	1	
10	90383300	O-RING 13,95X2,62 (3056)	1	
9	99185400	SCREW M6X16 UNI 5931 8.8 Z.	20	
8	70150122	BEARING COVER (OIL GLASS SIDE)	1	
7	90387700	O-RING 39,34X2,62 (3156)	1	
6	70211801	OIL SIGHT GLASS	1	
5	90075600	CIRCLIP D.45 (ZJ45)	1	
4	70220381	SHIM 0.25 MM.	1	
4	70220081	SHIM 0.1 MM.	1	
3	90391500	O-RING D. 80.6X2.62 (3318)	2	
2	91847700	TAPER ROLLER BEARING 33207/Q	2	
1	70010022	CRANKCASE	1	



## Illustration Hollow shaft (spline) + SAE B flange - NPT

Pos.	Code	Description	Qty	Notes
KIT2409	34240901		1	
KIT2408	34240801		1	
KIT2256	34225601		1	
KIT2158	34215801	KIT 2158*CONROD BUSHINGS +0,50	1	
KIT2157	34215701	KIT 2157*CONROD BUSHINGS +0,25	1	
KIT2156	34215601	KIT 2156*CONROD BUSHING	1	
KIT2031	34203101		1	
86	99426600	VITE TE M12X25-UNI5739 ZINC.	1	
85	71223074	STAFFA DI SOLLEVAMENTO	1	
84	90206500	PLUG FOR BORE D.17 - TTN19	1	
83	92202500	NUT M6 UNI 5588 6S	1	
82	70227034	VITE M6X12 CON INCAVO COMPLETA	1	
81	70226771	ANELLO PER ALBERO D.30 H.PACK	1	
80	10085322	FLANGE FOR HYDRAULIC MOTOR1 SAE-B S.70	1	
79	99308400	SCREW M 8x30 UNI 5931	6	
78	ZRPM1	ZRPM1	1	
76	90386600		2	
74	99192500	SCREW M06X35 5931 A2-70	6	
73	90352800	O-RING D. 29.00x1.50 NBR 70SH 3	3	
72	70050266	PISTON GUIDE ROD	3	
71	36210151		1	
68	36714401		1	
67	36712101	INTAKE/DELIVERY VALVE	1	
66	36204966		1	
65	90515500		1	
64	90385600		1	
63	36205066		1	
62	94739700		1	
61	36213805		1	
60	90385800		1	
59	90516500	ANTI-EXTR.RING D.24.7x29x1.5	2	
58	70224266		1	
57	90384100	O-RING 17,12X2,62 (3068)	1	
56	36200366	VALVE SEAT	1	
55	36203266	SPHERICAL VALVE	1	
54	94737600	SPRING D. 9,4X14,8	1	

## Illustration Hollow shaft (spline) + SAE B flange - NPT

Pos.	Code	Description	Qty	Notes
53	36202551	VALVE CAGE	1	
52	70224366		1	
50	90517750		1	
49	98197200	PLUG G1/8X8 S.S.	1	
48	90357600		1	
47	99382800		4	
46	70125936		1	
45	99485000	SCREW M14X40 UNI5931 12.9 DACR.	4	
44	70224036		1	
43	70100651		3	
42	90266100		3	
41	90266000		3	
40	70227766		3	
39	90266200		3	
38	70082366		3	
37	90362600	O-RING D. 50,52X1,78 (2200)	3	
36	70222551	CRANKCASE PLUG	6	
35	71225951	PLUG CAP	3	
34	70030501	CONNECTING ROD COMPLETE	3	
33	70606801	PISTON GUIDE ASSY	3	
32	90922200	UPPER HALF CONROD BUSHING +0.5 (BIG END) S.70	3	
32	90922100	UPPER HALF CONROD BUSHING +0.25 (BIG END) S.70	3	
32	90922300	LOWER HALF CONROD BUSHING (BIG END) S.70	3	
31	90922500	LOWER HALF CONROD BUSHING +0.50 (BIG END) S.70	3	
31	90922400	LOWER HALF CONROD BUSHING +0.25 (BIG END) S.70	3	
31	90922000	UPPER HALF CONROD BUSHING (BIG END) S.70	3	
30	90910000	CONROD BUSHING (SMALL END) S.70	3	
29	97742000	GUDGEON PIN D.18X36	3	
28	70050115	PISTON GUIDE T.N.	3	
27	70224136	PISTON BOLT	3	
26	90358400	O-RING D.10,82X1,78(2043)90SH3		
25	70041809		3	

## Illustration Hollow shaft (spline) + SAE B flange - NPT

Pos.	Code	Description	Qty	Notes
24	96709900	WASHER D.10X45	3	
23	90167700	OIL SEAL D.36X47X7	3	
22	90166800	OIL SEAL D.35X52X7	1	
21	70150022	BEARING COVER (PTO SIDE)	1	
19	70020935	CRANKSHAFT C.26 HYP SAE-B	1	
18	99312300	CONN.ROD BOLT M8X1X42	6	
17	98200500	PLUG D. 15	5	
16	90394200	OR D.190.17X2.62 NBR 70SH	1	
15	70160622	CRANKCASE COVER KT	1	
14	90360400	O-RING 25,12X1,78 (2100)	1	
13	72210695	DIP STICK TUBE	1	
12	98211500	OIL DIPSTICK D.21,5X70	1	
11	98210050	PLUG G3/8x13 TE22	1	
10	90383300	O-RING 13,95X2,62 (3056)	1	
9	99185400	SCREW M6X16 UNI 5931 8.8 Z.	20	
8	70150122	BEARING COVER (OIL GLASS SIDE)	1	
7	90387700	O-RING 39,34X2,62 (3156)	1	
6	70211801	OIL SIGHT GLASS	1	
5	90075600	CIRCLIP D.45 (ZJ45)	1	
4	70220381	SHIM 0.25 MM.	1	
4	70220081	SHIM 0.1 MM.	1	
3	90391500	O-RING D. 80.6X2.62 (3318)	2	
2	91847700	TAPER ROLLER BEARING 33207/Q	2	
1	70010022	CRANKCASE	1	

# Illustration Male shaft (key) - GAS - ATEX

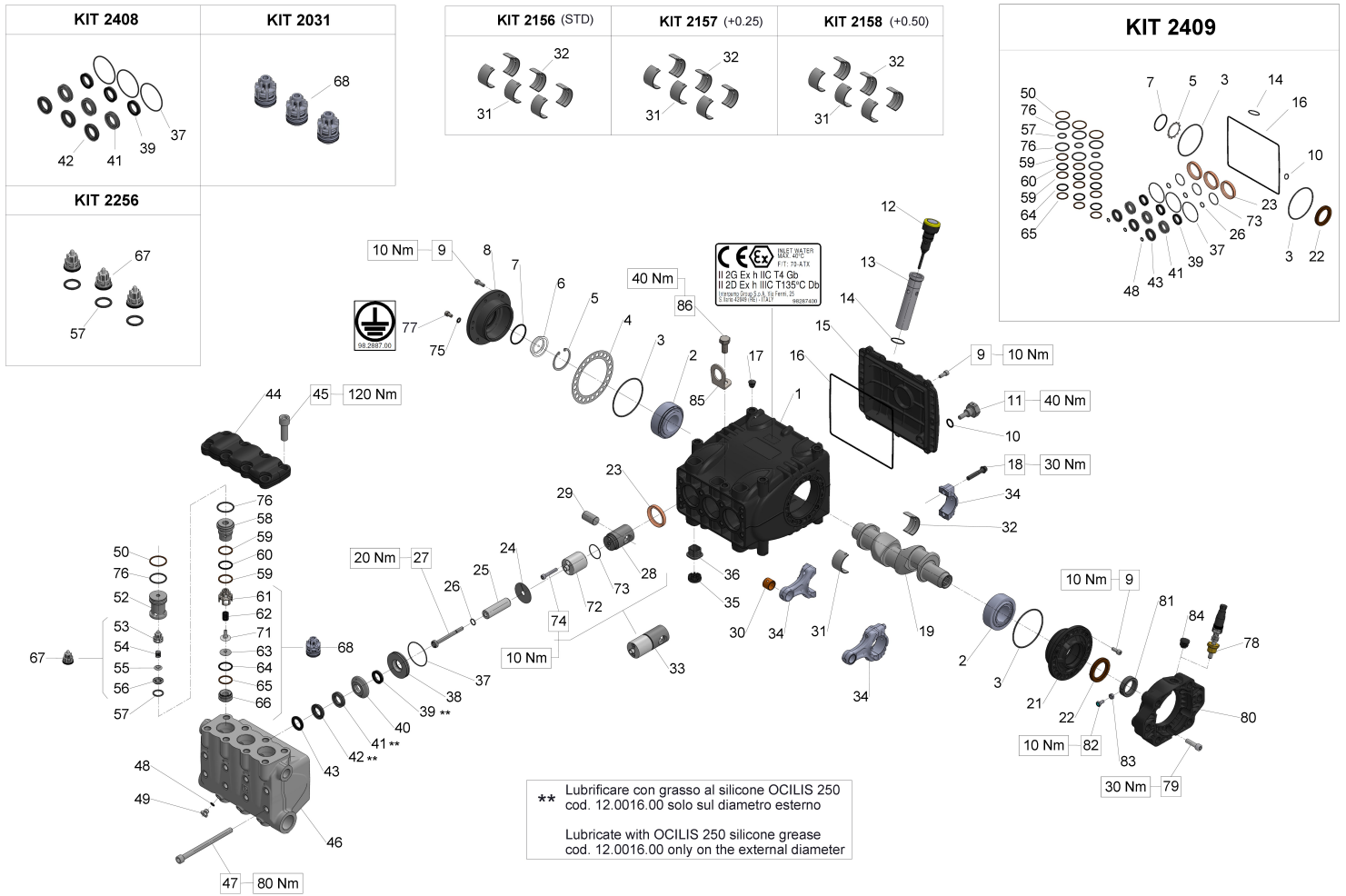

## Illustration Male shaft (key) - GAS - ATEX

Pos.	Code	Description	Qty	Notes
KIT2409	34240901		1	
KIT2408	34240801		1	
KIT2256	34225601		1	
KIT2158	34215801	KIT 2158*CONROD BUSHINGS +0,50	1	
KIT2157	34215701	KIT 2157*CONROD BUSHINGS +0,25	1	
KIT2156	34215601	KIT 2156*CONROD BUSHING	1	
KIT2031	34203101		1	
86	99426600	VITE TE M12X25-UNI5739 ZINC.	1	
85	71223074	STAFFA DI SOLLEVAMENTO	1	
84	90206500	PLUG FOR BORE D.17 - TTN19	1	
83	92202500	NUT M6 UNI 5588 6S	1	
82	70227034	VITE M6X12 CON INCAVO COMPLETA	1	
81	70226771	ANELLO PER ALBERO D.30 H.PACK	1	
80	10085322	FLANGE FOR HYDRAULIC MOTOR1 SAE-B S.70	1	
79	99308400	SCREW M 8x30 UNI 5931	6	
78	ZRPM1	ZRPM1	1	
77	99180900	SCREW M06X10 5931 A2-70	1	
76	90386600		2	
75	96693950	WASHER 6.4x11.0x0.7 D6798A INOX	1	
74	99192500	SCREW M06X35 5931 A2-70	6	
73	90352800	O-RING D. 29.00x1.50 NBR 70SH 3	3	
72	70050266	PISTON GUIDE ROD	3	
71	36210151		1	
68	36714401		1	
67	36712101	INTAKE/DELIVERY VALVE	1	
66	36204966		1	
65	90515500		1	
64	90385600		1	
63	36205066		1	
62	94739700		1	
61	36213805		1	
60	90385800		1	
59	90516500	ANTI-EXTR.RING D.24.7x29x1.5	2	
58	70224266		1	
57	90384100	O-RING 17,12X2,62 (3068)	1	

## Illustration Male shaft (key) - GAS - ATEX

Pos.	Code	Description	Qty	Notes
56	36200366	VALVE SEAT	1	
55	36203266	SPHERICAL VALVE	1	
54	94737600	SPRING D. 9,4X14,8	1	
53	36202551	VALVE CAGE	1	
52	70224366		1	
50	90517750		1	
49	98197200	PLUG G1/8X8 S.S.	1	
48	90357600		1	
47	99382800		4	
46	70125636		1	
45	99485000	SCREW M14X40 UNI5931 12.9 DACR.	4	
44	70224036		1	
43	70100651		3	
42	90266100		3	
41	90266000		3	
40	70227766		3	
39	90266200		3	
38	70082366		3	
37	90362600	O-RING D. 50,52X1,78 (2200)	3	
36	70222551	CRANKCASE PLUG	6	
35	71225951	PLUG CAP	3	
34	70030501	CONNECTING ROD COMPLETE	3	
33	70606801	PISTON GUIDE ASSY	3	
32	90922200	UPPER HALF CONROD BUSHING +0.5 (BIG END) S.70	3	
32	90922100	UPPER HALF CONROD BUSHING +0.25 (BIG END) S.70	3	
32	90922300	LOWER HALF CONROD BUSHING (BIG END) S.70	3	
31	90922500	LOWER HALF CONROD BUSHING +0.50 (BIG END) S.70	3	
31	90922400	LOWER HALF CONROD BUSHING +0.25 (BIG END) S.70	3	
31	90922000	UPPER HALF CONROD BUSHING (BIG END) S.70	3	
30	90910000	CONROD BUSHING (SMALL END) S.70	3	
29	97742000	GUDGEON PIN D.18X36	3	
28	70050115	PISTON GUIDE T.N.	3	
27	70224136	PISTON BOLT	3	

## Illustration Male shaft (key) - GAS - ATEX

Pos.	Code	Description	Qty	Notes
26	90358400	O-RING D.10,82X1,78(2043)90SH3		
25	70041809		3	
24	96709900	WASHER D.10X45	3	
23	90167700	OIL SEAL D.36X47X7	3	
22	90166800	OIL SEAL D.35X52X7	1	
21	70150022	BEARING COVER (PTO SIDE)	1	
19	70020935	CRANKSHAFT C.26 HYP SAE-B	1	
18	99312300	CONN.ROD BOLT M8X1X42	6	
17	98200500	PLUG D. 15	5	
16	90394200	OR D.190.17X2.62 NBR 70SH	1	
15	70160622	CRANKCASE COVER KT	1	
14	90360400	O-RING 25,12X1,78 (2100)	1	
13	72210695	DIP STICK TUBE	1	
12	98211600	ASTA LIVELLO OLIO D.21.5x70 ATEX (S.70)	1	
11	98210080	PLUG G 3/8 X 13 SS	1	
10	90383300	O-RING 13,95X2,62 (3056)	1	
9	99185400	SCREW M6X16 UNI 5931 8.8 Z.	20	
8	70150622	COPERCHIO CUSCINETTO LATO SPIA ATEX	1	
7	90387700	O-RING 39,34X2,62 (3156)	1	
6	70211751		1	
5	90075500	STOP RING J45 UNI7437	1	
4	70220381	SHIM 0.25 MM.	1	
4	70220081	SHIM 0.1 MM.	1	
3	90391500	O-RING D. 80.6X2.62 (3318)	2	
2	91847700	TAPER ROLLER BEARING 33207/Q	2	
1	70010022	CRANKCASE	1	