

**MOTOPOMPES POUR VD2 / VD5
(avec retour à la cuve)**



Caracteristiques techniques

	DW 60 R / A_VD2	DW 120 R / VD5
Débit max à 2,5 bar	60 l/h	110 l/h
Tension d'alimentation	230 Vac Monophasé 50 Hz	
Consommation maximale	150 W	
Raccordement Aspiration	G1/4"	
Raccordement Refoulement	G1/8"	
Raccordement Retour	G1/4"	
Pression max.	10 bar	
Réglage pression	2 – 10 bar	
Régulation Bypass d'usine	4 bar	4 bar
Poids	4,65 Kg	5 kg
Dimensions (approx)	310 x 200 x 210 mm	

Débit:

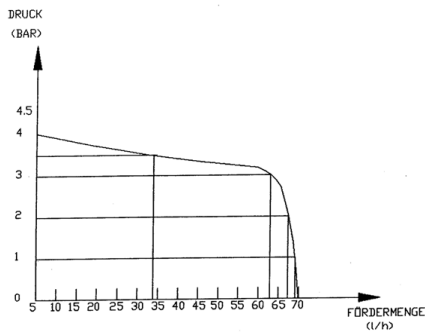

DW 60

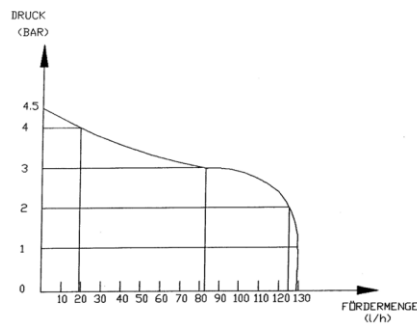

DW 120

Schéma de principe:

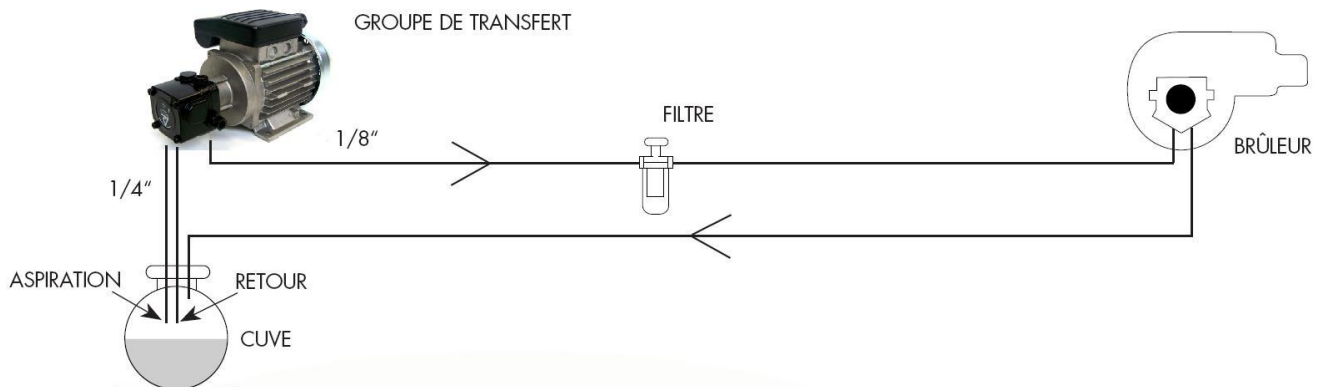

Dimensions:

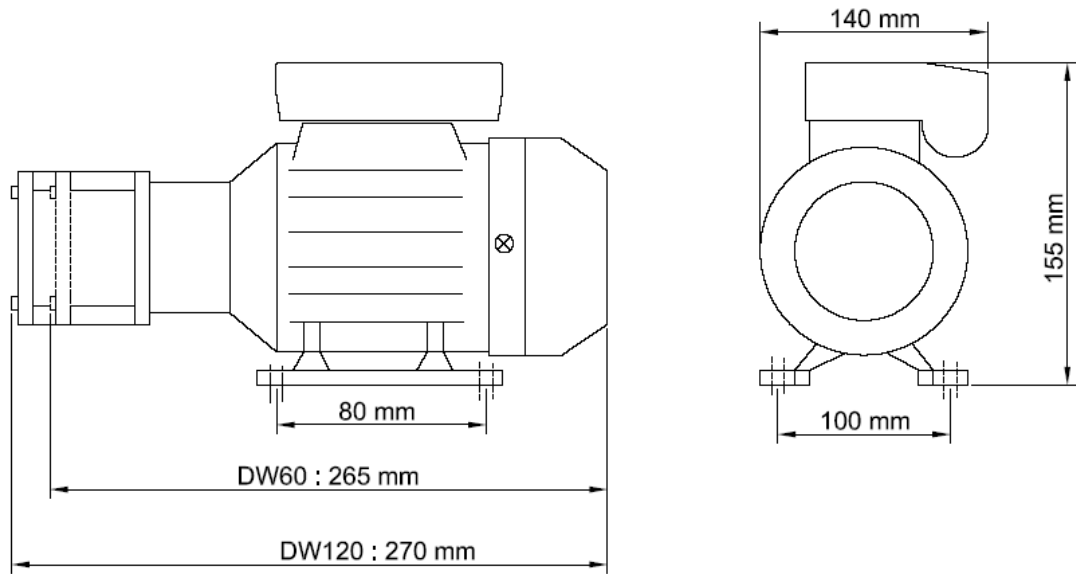

Raccordements:

DW 60 R / A_VD2

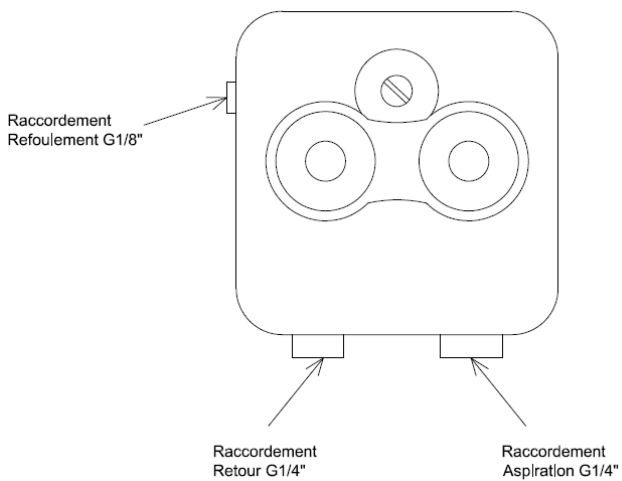

DW 120 R / VDU5

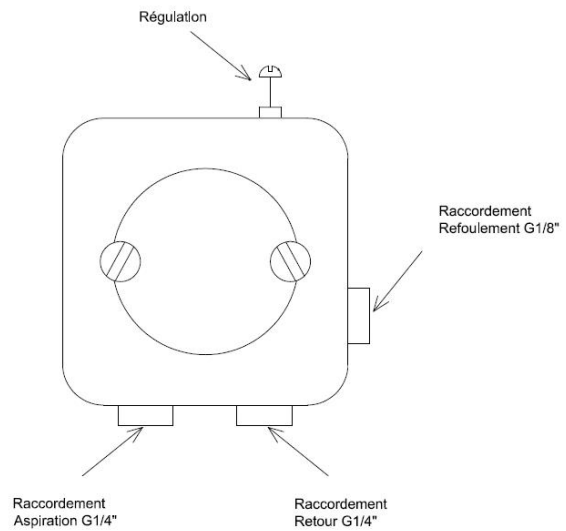

Pompe : plus d'infos : [AD pump datasheet](#)

[VDU datasheet](#)

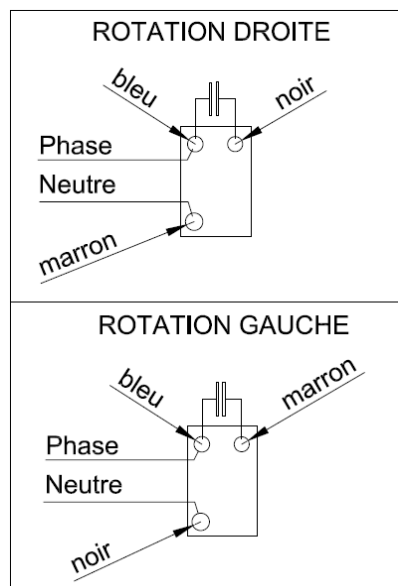

Ref. SI